

SCREEN DOOR LOCK INSTALL

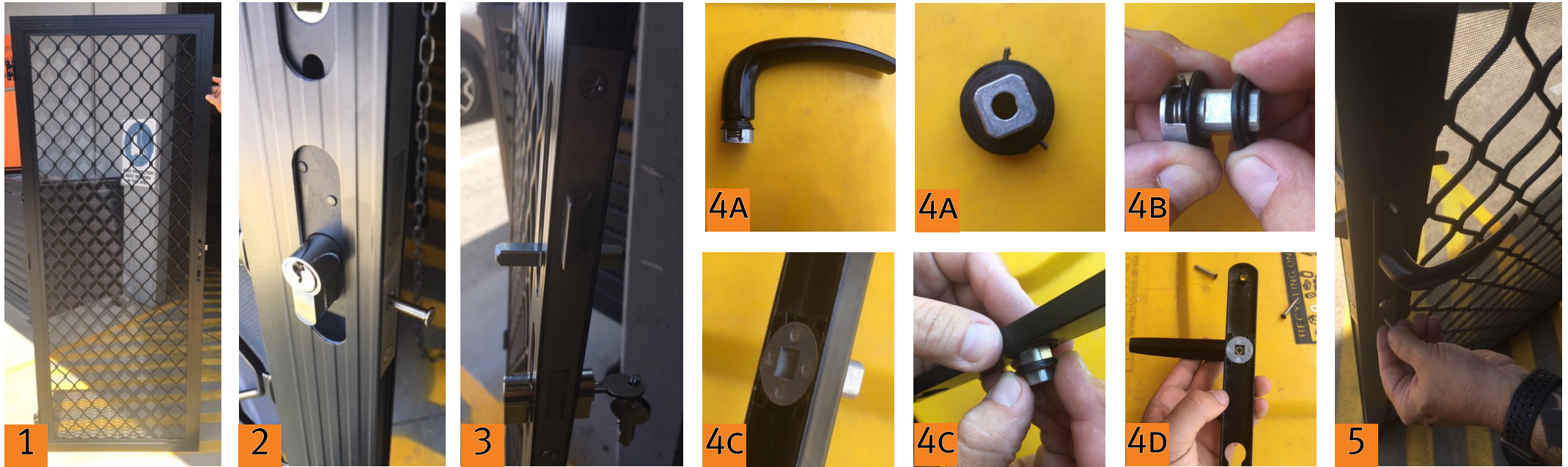

1. Check Orientation. Ensure the diamond grille is facing outwards and the bevelled side of the lock snib is facing inwards. If not follow the steps in the door flipping guide available on our website.

2. Insert Cylinder. Insert Cylinder and use the long screw in the box to fix into place. Do not overtighten as it can lead to the key lock not functioning properly.

3. Insert Spindle. Insert the square rod through the hole in the lock body.

4. Assemble Handles. (a) Remove the spindle receivers from the handles, (b) remove the grommet from the spindle receiver. (c) Insert the spindle receiver and replace the grommet on the outside. (d) Fix handle in place.

5. Fit Handles to door. Fit Handles onto door. Ensure the handle with the screw holes is on the inside of the door.



Components