

# RYOBI®

ORIGINAL INSTRUCTIONS

## Cordless Edger

RED1850Li40  
RED1850Li20  
RED1850Li15  
OED1850



## **Important!**

It is essential that you read the instructions in this manual before assembling, operating and maintaining the product.

Subject to technical modification.

Safety, performance, and dependability have been given top priority in the design of your cordless edger.

## INTENDED USE

The cordless edger is intended for edging along sidewalks, driveway, flower beds, and similar areas.

The product should not be used for cutting or chopping hedges, shrubs, bushes, flowers and compost.

Do not use the product for any other purpose.

## GENERAL SAFETY WARNINGS

### WARNING

**Read all safety warnings and all instructions.** Failure to follow the warnings and instructions may result in electric shock, fire and/or serious injury.

**Save all warnings and instructions for future reference.**

The term "power tool" in the warnings refers to your mains-operated (corded) power tool or battery-operated (cordless) power tool.

## WORK AREA SAFETY

- **Keep work area clean and well lit.** Cluttered or dark areas invite accidents.
- **Do not operate power tools in explosive atmospheres, such as in the presence of flammable liquids, gases or dust.** Power tools create sparks which may ignite the dust or fumes.
- **Keep children and bystanders away while operating a power tool.** Distractions can cause you to lose control.

## ELECTRICAL SAFETY

- **Power tool plugs must match the outlet. Never modify the plug in any way. Do not use any adapter plugs with earthed (grounded) power tools.** Unmodified plugs and matching outlets will reduce risk of electric shock.
- **Avoid body contact with earthed or grounded surfaces, such as pipes, radiators, ranges and refrigerators.** There is an increased risk of electric shock if your body is earthed or grounded.
- **Do not expose power tools to rain or wet conditions.** Water entering a power tool will increase the risk of electric shock.
- **Do not abuse the cord. Never use the cord for carrying, pulling or unplugging the power tool. Keep cord away from heat, oil, sharp edges or moving parts.** Damaged or entangled cords increase the risk of electric shock.
- **When operating a power tool outdoors, use an extension cord suitable for outdoor use.** Use of a cord suitable for outdoor use reduces the risk of electric shock.
- **If operating a power tool in a damp location is unavoidable, use a residual current device (RCD) protected supply.** Use of an RCD reduces the risk of electric shock.

## PERSONAL SAFETY

- **Stay alert, watch what you are doing and use common sense when operating a power tool. Do not use a power tool while you are tired or under the influence of drugs, alcohol or medication.** A moment of inattention while operating power tools may result in serious personal injury.
- **Use personal protective equipment. Always wear eye protection.** Protective equipment such as dust mask, non-skid safety shoes, hard hat, or hearing protection used for appropriate conditions will reduce personal injuries.
- **Prevent unintentional starting. Ensure the switch is in the off-position before connecting to power source and/or battery pack, picking up or carrying the tool.** Carrying power tools with your finger on the switch or energising power tools that have the switch on invites accidents.
- **Remove any adjusting key or wrench before turning the power tool on.** A wrench or a key left attached to a rotating part of the power tool may result in personal injury.
- **Do not overreach. Keep proper footing and balance at all times.** This enables better control of the power tool in unexpected situations.
- **Dress properly. Do not wear loose clothing or jewellery. Keep your hair, clothing and gloves away from moving parts.** Loose clothes, jewellery or long hair can be caught in moving parts.
- **If devices are provided for the connection of dust extraction and collection facilities, ensure these are connected and properly used.** Use of dust collection can reduce dust-related hazards.

## POWER TOOL USE AND CARE

- **Do not force the power tool. Use the correct power tool for your application.** The correct power tool will do the job better and safer at the rate for which it was designed.
- **Do not use the power tool if the switch does not turn it on and off.** Any power tool that cannot be controlled with the switch is dangerous and must be repaired.
- **Disconnect the plug from the power source and/or the battery pack from the power tool before making any adjustments, changing accessories, or storing power tools.** Such preventive safety measures reduce the risk of starting the power tool accidentally.
- **Store idle power tools out of the reach of children and do not allow persons unfamiliar with the power tool or these instructions to operate the power tool.** Power tools are dangerous in the hands of untrained users.
- **Maintain power tools. Check for misalignment or binding of moving parts, breakage of parts and any other condition that may affect the power tool's operation. If damaged, have the power tool repaired before use.** Many accidents are caused by poorly maintained power tools.
- **Keep cutting tools sharp and clean.** Properly maintained cutting tools with sharp cutting edges are less likely to bind and are easier to control.

- **Use the power tool, accessories and tool bits etc. in accordance with these instructions, taking into account the working conditions and the work to be performed.** Use of the power tool for operations different from those intended could result in a hazardous situation.

## BATTERY TOOL USE AND CARE

- **Recharge only with the charger specified by the manufacturer.** A charger that is suitable for one type of battery pack may create a risk of fire when used with another battery pack.
- **Use power tools only with specifically designated battery packs.** Use of any other battery packs may create a risk of injury and fire.
- **When battery pack is not in use, keep it away from other metal objects, like paper clips, coins, keys, nails, screws or other small metal objects, that can make a connection from one terminal to another.** Shorting the battery terminals together may cause burns or a fire.
- **Under abusive conditions, liquid may be ejected from the battery; avoid contact. If contact accidentally occurs, flush with water. If liquid contacts eyes, additionally seek medical help.** Liquid ejected from the battery may cause irritation or burns.

## SERVICE

- **Have your power tool serviced by a qualified repair person using only identical replacement parts.** This will ensure that the safety of the power tool is maintained.

## EDGER SAFETY WARNINGS

### WARNING

When using the product, the safety rules must be followed. For your own safety and that of bystanders, please read these instructions before operating the product. Please keep the instruction safe for later use.

### WARNING

The product is not intended to be used by children or persons with reduced physical, mental, or sensory capabilities. Children should be adequately supervised to ensure they do not play with the product.

- Never use the edger while people, especially children, or pets are nearby.
- While edging, always wear eye and ear protection, substantial footwear, and long trousers.
- Always be sure of your footing on slopes.
- Use extreme caution when reversing or pulling the edger toward you.
- Some regions have regulations that restrict the use of the product to some operations. Check with your local authority for advice.
- Avoid using the product in bad weather especially if

there is a risk of lightning.

- Use the product in daylight or with good artificial light.
- Avoid using the product on wet grass.
- Keep proper footing and balance at all times.
- Do not walk backwards when using the product.
- Walk, never run.
- Keep the head attachment below waist level.
- Do not cut on surfaces other than grass on ground.
- Never use the product with damaged guards or without guards in place.
- Keep hands and feet away from the cutting means at all times and especially when switching on the motor.
- Beware of objects thrown by the cutting blade.
- Turn off the product and remove the battery pack. Make sure that all moving parts have come to a complete stop:
  - before servicing
  - before leaving the product unattended
  - before clearing a blockage
  - before checking, cleaning, and working on the product
  - before changing accessories
  - after striking a foreign object
  - whenever performing maintenance
  - whenever the product starts to vibrate abnormally
- Wear protective glasses or goggles.
- Always ensure that ventilation openings are kept clear of debris.
- Do not operate the product while barefoot or when wearing sandals or similar lightweight footwear. Wear protective footwear that will protect your feet and improve your footing on slippery surfaces.
- Do not use the product if the lock-out trigger does not turn it on or off. Any product that cannot be controlled with the lock-out trigger is dangerous and must be repaired.
- Do not grasp the exposed cutting edges when picking up or holding the product.
- Replace a dull or worn blade. Do not attempt to sharpen the blade.
- Do not use the edger on or near gravel surfaces.
- Make yourself familiar with the area you are edging. Be aware of uneven sidewalks and holes in the terrain as well as other similar hazardous conditions.
- Do not attempt to remove cut material or hold material to be cut when the motor is running or when the cutting blade is moving.
- A coasting blade can cause injury while it continues to spin after the motor is stopped or the throttle trigger is released. Maintain proper control until the blade has completely stopped rotating.

## ADDITIONAL BATTERY SAFETY WARNINGS

### WARNING

To reduce the risk of fire, personal injury, and product damage due to a short circuit, never immerse your tool, battery pack or charger in fluid or allow a fluid to flow inside them. Corrosive or conductive fluids, such as seawater, certain industrial chemicals, and bleach or bleach-containing products, etc., can cause a short circuit.

## OVERLOAD PROTECTION

RYOBI 18 V lithium-ion batteries are designed with features that protect the lithium-ion cells and maximise battery life. If the product stops during use, the following may be the causes:

- The maximum current draw of the battery pack has been exceeded, causing it to automatically stop powering the product. Release the trigger to reset the product and pull the trigger to resume operation.
- Excessive temperatures will cause the battery pack to stop powering the product. Feel the battery pack; if it is too warm, allow it to cool down.

## TRANSPORTATION AND STORAGE

- Stop the product, remove the battery pack, and allow the product to cool down before storing or transporting.
- Clean all foreign material from the product.
- Do not store or transport the product with the battery packs fitted. Remove and secure the battery packs separately. Store the product in a cool, dry, and well-ventilated place that is inaccessible to children. Keep the product away from corrosive agents, such as garden chemicals and de-icing salts. Do not store the product outdoors.
- For transportation in vehicles, secure the product against movement or falling to prevent injury to persons or damage to the product.

## TRANSPORTING LITHIUM BATTERIES

Transport the battery pack in accordance with local and national provisions and regulations. Follow all special requirements on packaging and labelling when transporting batteries by a third party.

Ensure that no batteries can come in contact with other batteries or conductive materials while in transport by protecting exposed connectors with insulating, non-conductive caps or tape. Do not transport batteries that are cracked or leaking. Check with the forwarding company for further advice.

## MAINTENANCE

### WARNING

Use only original manufacturer's replacement parts, accessories, and attachments. Failure to do so can cause possible injury, can contribute to poor performance, and may void your warranty.

### WARNING

Servicing requires extreme care and knowledge and should be performed only by a qualified service technician. Have the product serviced by an authorised service centre only. When servicing, use only original replacement parts.

### WARNING

To avoid serious personal injury, always remove the battery pack from the product when cleaning or performing any maintenance.

- Turn off and remove the battery pack before conducting any maintenance or cleaning work.
- You may make adjustments and repairs described in this manual. For other repairs, contact an authorised service agent.
- After each use, clean the product with a soft, dry brush. Any part that is damaged should be properly repaired or replaced by an authorised service centre.
- Check all nuts, bolts, and screws at frequent intervals for proper tightness to ensure that the product is in safe working condition. Any part that is damaged should be properly repaired or replaced by an authorised service centre.
- Bring the product to an authorised service centre to replace damaged or unreadable labels.
- Avoid using solvents when cleaning plastic parts. Most plastics are susceptible to damage from various types of commercial solvents and may be damaged by their use. Use a clean cloth to remove dirt, dust, oil, grease, etc.

### WARNING

Do not at any time let brake fluids, gasoline, petroleum-based products, penetrating oils, etc., come in contact with plastic parts. Chemicals can damage, weaken or destroy plastic, which may result in serious personal injury.

Only the parts shown on the parts list are intended to be repaired or replaced by the customer. All the other parts should be replaced at an authorised service centre.

## RESIDUAL RISKS

Even when the product is used as prescribed, it is still impossible to completely eliminate certain residual risk factors. The following hazards may arise during use, and the operator should pay special attention to avoid the following:

- injury caused by vibration
  - Hold the product by designated handles and restrict working time and exposure.
- injury caused by exposure to noise
  - Wear hearing protection and limit exposure.
- injury caused by flying debris.
  - Wear eye protection at all times.

## RISK REDUCTION

It has been reported that vibrations from handheld tools may contribute to a condition called Raynaud's Syndrome. Symptoms may include tingling, numbness, and blanching of the fingers, usually apparent upon exposure to cold. Hereditary factors, exposure to cold and dampness, diet, smoking, and work practices are all thought to contribute to the development of these symptoms. There are measures that can be taken by the operator to possibly reduce the effects of vibration:

- Keep your body warm in cold weather. When operating the product, wear gloves to keep the hands and wrists warm. It is reported that cold weather is a major factor contributing to Raynaud's Syndrome.
- After each period of operation, exercise to increase blood circulation.
- Take frequent work breaks. Limit the amount of exposure per day.

If you experience any of the symptoms of this condition, immediately discontinue use and see your physician.

### ⚠ WARNING

Injuries may be caused, or aggravated, by prolonged use of a tool. When using any tool for prolonged periods, ensure you take regular breaks.



Keep feet away from the rotating blade.



Avoid using in wet or damp conditions.



Beware of thrown objects.



Direction of blade rotation



Waste electrical products should not be disposed of with household waste. Please recycle where facilities exist. Check with your local authority or retailer for recycling advice.



Regulatory Compliance Mark (RCM). This product meets applicable regulatory requirements.



Guaranteed sound power level



Remove the battery pack before starting any work on the product.

## WHAT'S IN THE BOX

See pages 5–6.

- Power head x 1
- Edger attachment x1
- Combination wrench x 1
- Front handle x 1
- Operator's manual
- Harness x 1
- Clamp x 1
- Locking pin x 1

## SYMBOLS ON THE PRODUCT



Safety alert



Read and understand all instructions before operating the product. Follow all warnings and safety instructions.



Wear ear protection.



Wear eye protection.



Beware of thrown or flying objects. Keep all bystanders at least 15 m away.

The following signal words and meanings are intended to explain the levels of risk associated with this product.

### ⚠ DANGER

Indicates an imminently hazardous situation, which, if not avoided, will result in death or serious injury.

### ⚠ WARNING

Indicates a potentially hazardous situation, which, if not avoided, could result in death or serious injury.

### ⚠ CAUTION

Indicates a potentially hazardous situation, which, if not avoided, may result in minor or moderate injury.

### CAUTION

Without safety alert symbol

Indicates a situation that may result in property damage.

## SYMBOLS IN THIS MANUAL



Parts or accessories sold separately



Waste electrical products should not be disposed of with household waste. Please recycle where facilities exist.



Note



Warning

## WHAT'S IN THE BOX

RED1850Li40

RED1850Li20

RED1850Li15

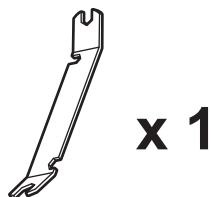
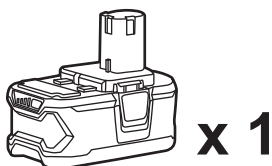
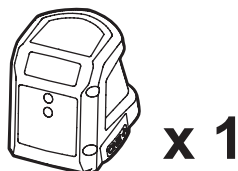
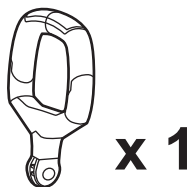
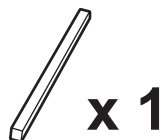
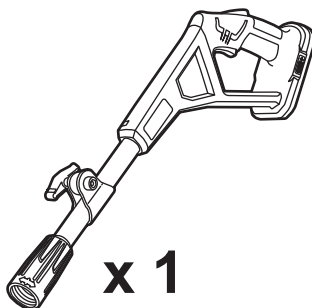
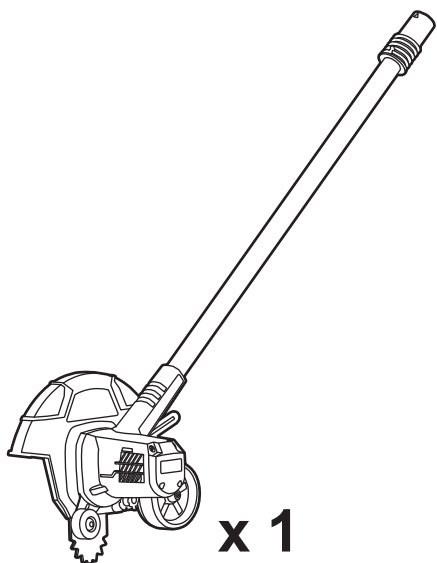

OED1850

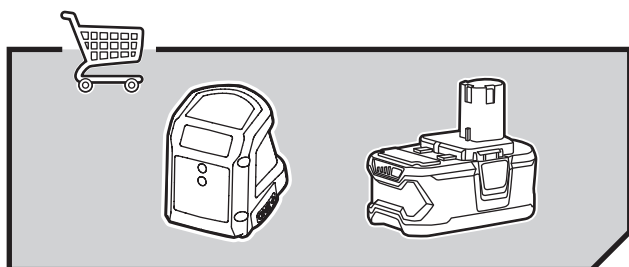
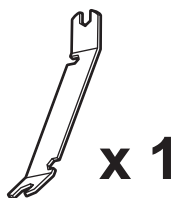
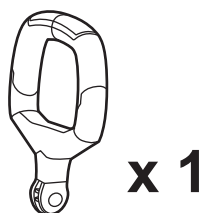
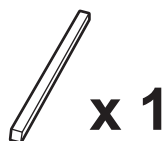
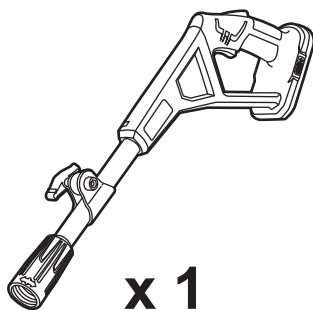
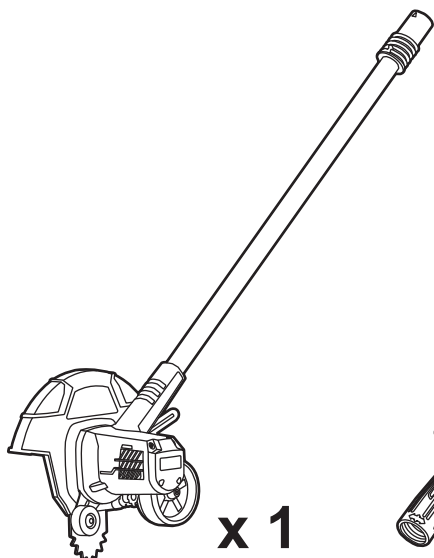



## KNOW YOUR PRODUCT

1. Variable speed trigger
2. Lock-out trigger
3. Rear handle
4. Battery pack
5. Coupler
6. Battery charger
7. Depth adjustment lever
8. Guide wheel

9. Blade
10. Motor
11. Blade guard
12. Lower shaft
13. Front handle

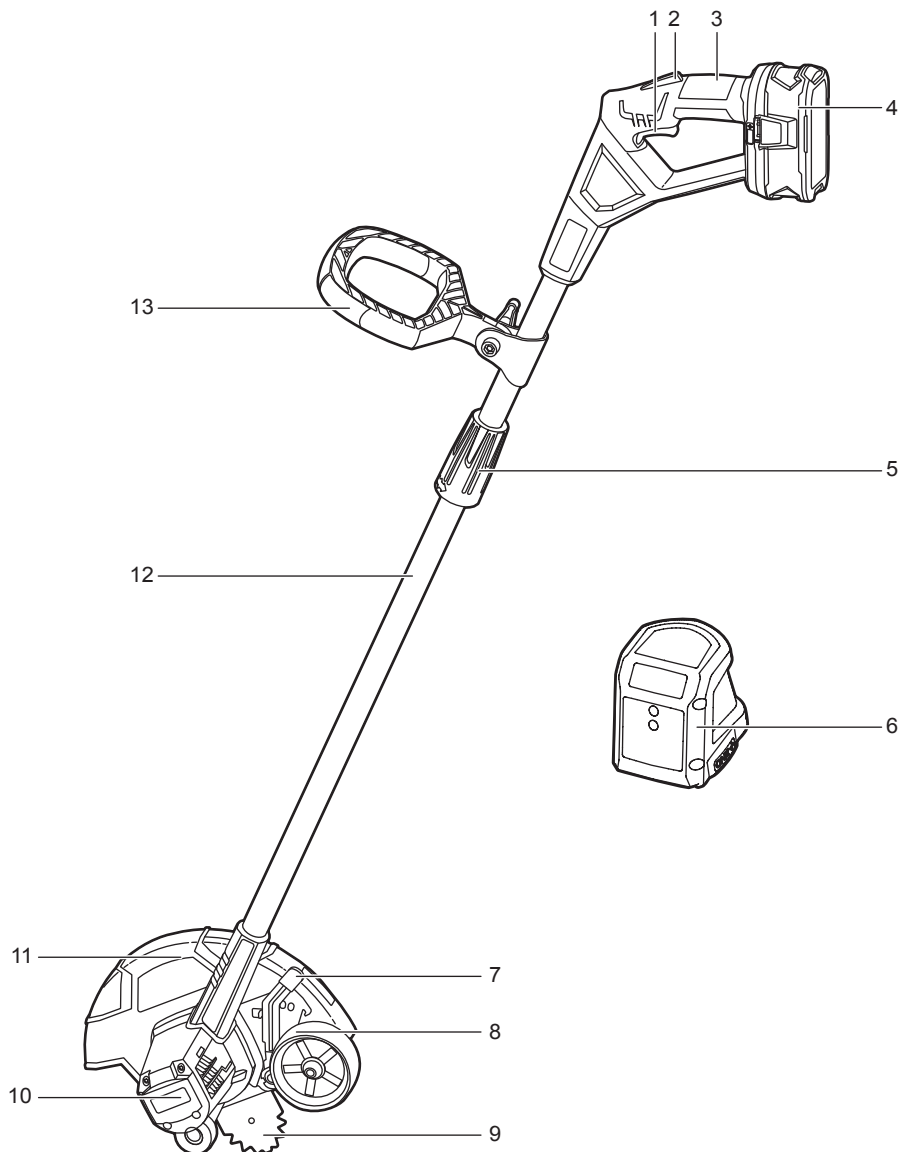

## 1

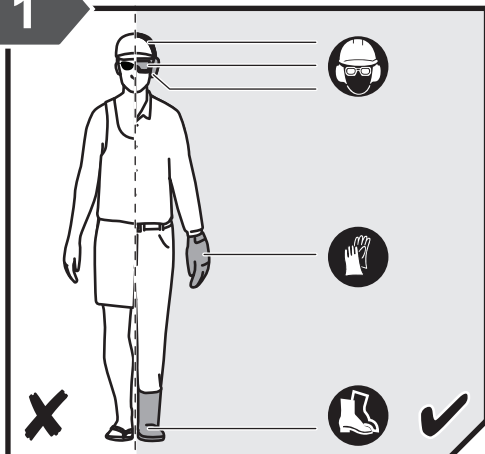

Always wear safety goggles or safety glasses with side shields when operating the product. Wear non-slip, heavy-duty protective gloves. Wear non-skid, protective footwear that will protect your feet and improve your footing on slippery surfaces.

## 2

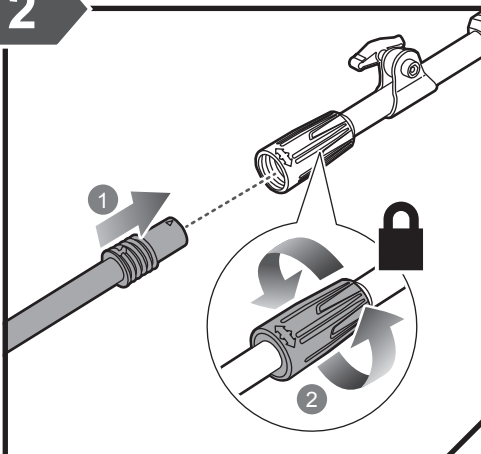

Install the lower shaft to the upper shaft. Tighten the coupler to secure.

## 5

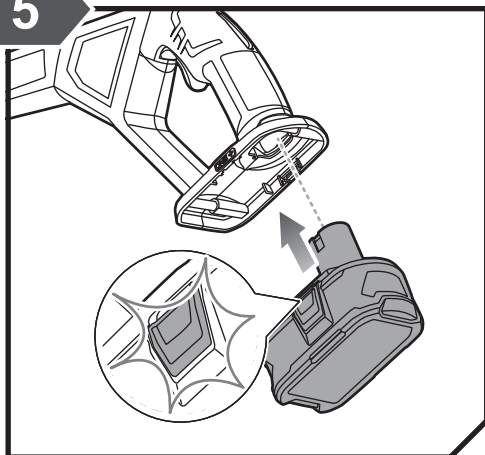

Insert the battery pack until the latches click into place.

## 6

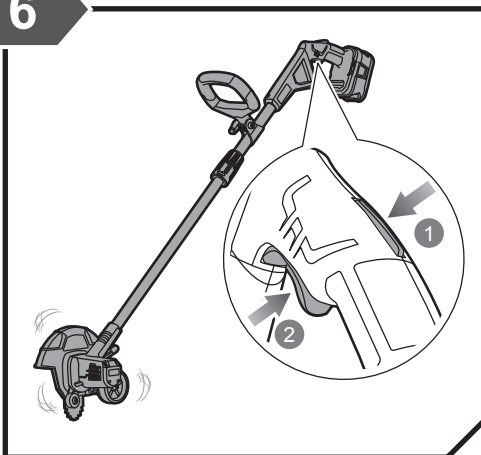

Push the lock-out trigger and squeeze the variable speed trigger to operate the product.

3

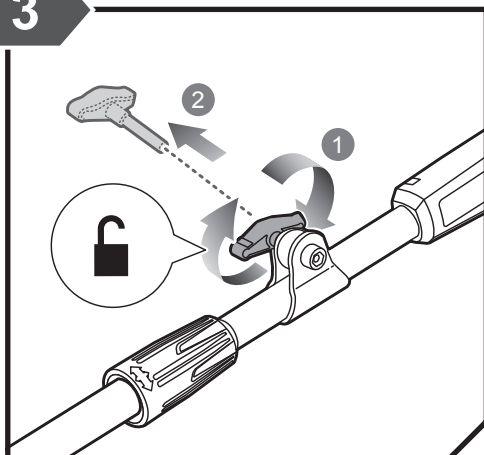

Loosen and remove the upper-shaft knob.

4

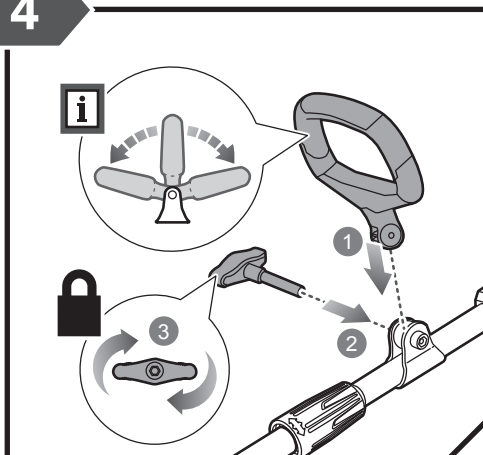

Install the front handle. Re-insert and tighten the upper-shaft knob to secure.

**NOTE:** The angle of the front handle can be adjusted 180°.

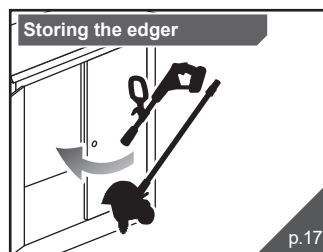
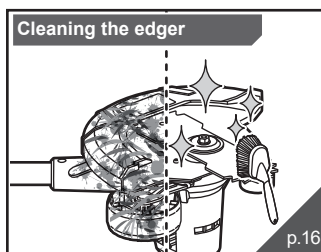
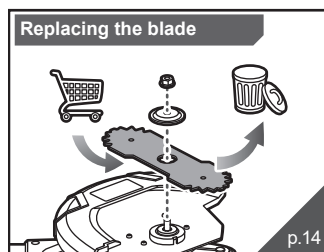
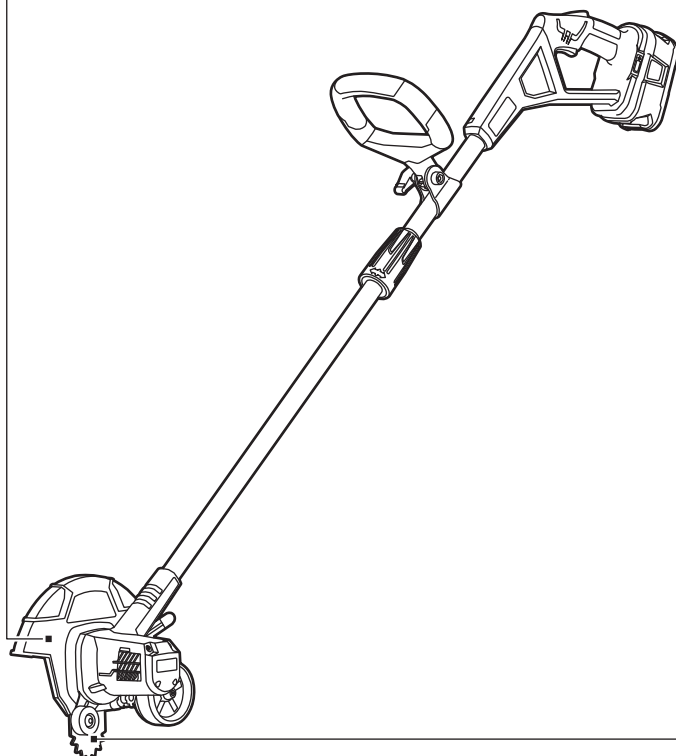
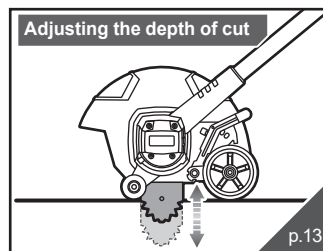
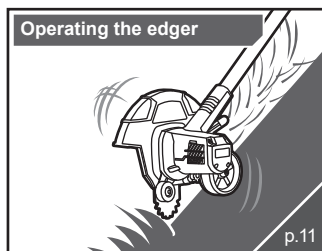

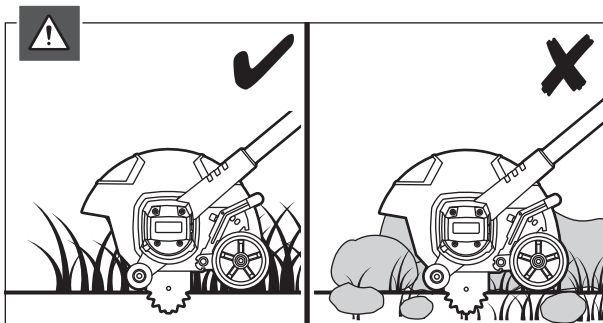
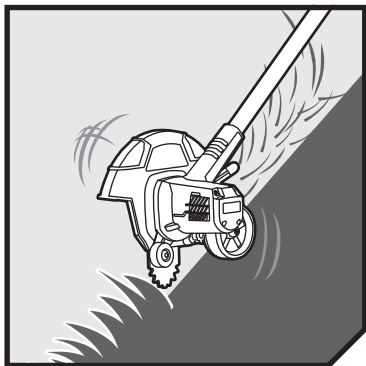

## OPERATING THE EDGER

**WARNING:** Always use two hands to operate the product. Hold the rear handle with the right hand and the front handle with the left hand.

**WARNING:** Best appearance is obtained when the grass is dry. Avoid using the edger in wet soil or wet grass areas. The blade guard might clog and result in an uneven edge. If the blade guard becomes clogged, stop the edger, remove the battery pack, and remove debris from the blade guard.

1. Insert the battery pack until the latches click into place.
2. Push the lock-out trigger, and squeeze the variable speed trigger to operate the product.

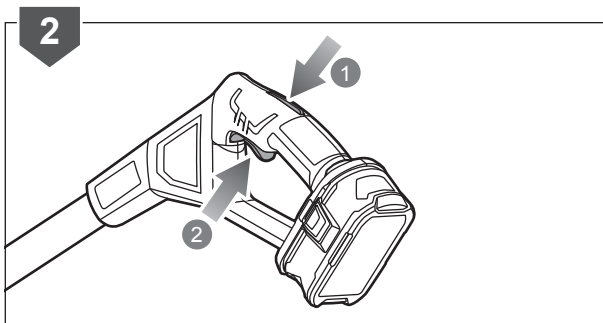
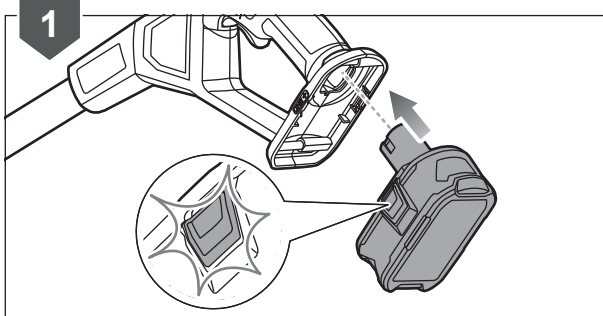

## OPERATION

**WARNING:** Keep hands and feet away from the blade at all times and especially when switching on the motor.

3. Use the edger along sidewalks, driveways, flower beds, curbs, and similar areas.

**NOTE:** Cut at a steady pace. If the blade begins to bog down, you are edging too fast; slow your pace. Do not force the blade into the ground.

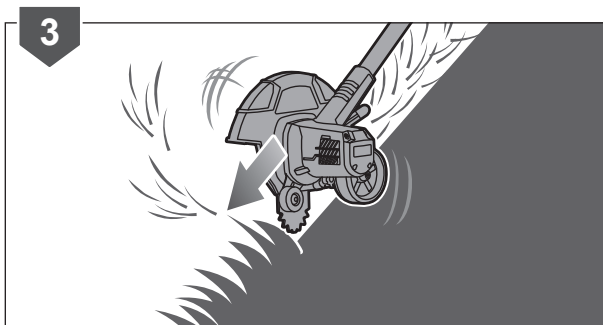
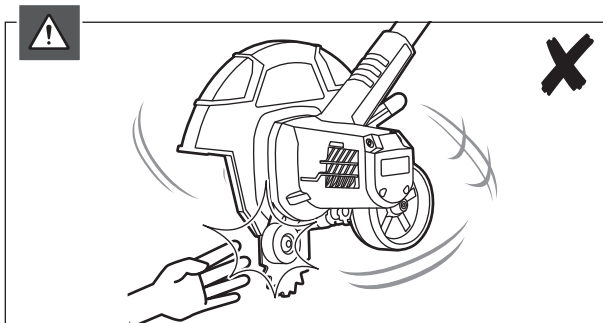

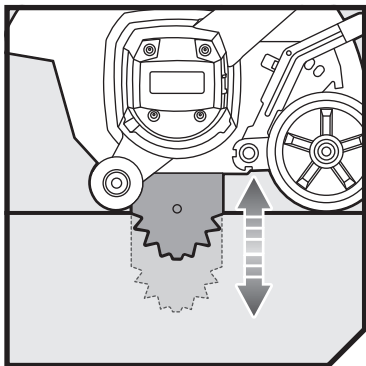

## ADJUSTING THE DEPTH OF CUT

1. Remove the battery pack.
2. Move the depth adjustment lever up to increase the depth of cut, or down to decrease the depth of cut.

**NOTE:** The depth adjustment lever locks into one of four positions.

**NOTE:** Adjust the blade depth from 15 mm (0.59 in.) to 45 mm (1.77 in.) deep initially. Make a shallow cut to test the cutting depth. If the cutting depth needs adjusting, do this progressively until the preferred depth is reached.

**NOTE:** The angle in which the product is positioned affects the exact depth of cut.

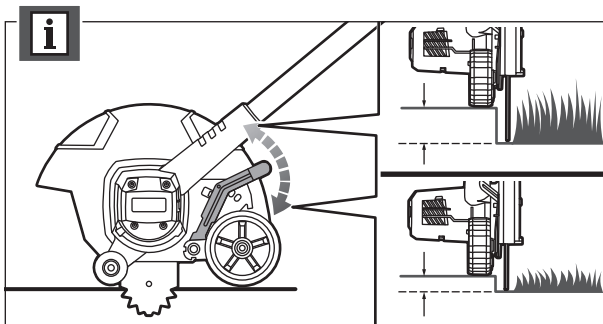
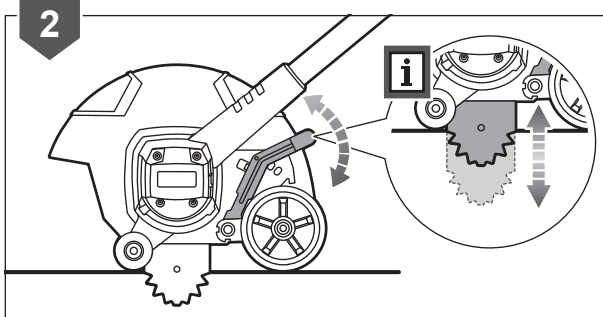
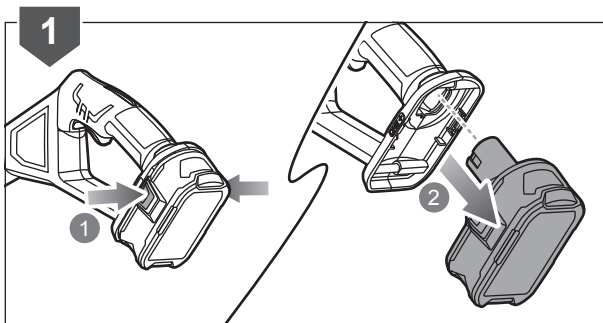

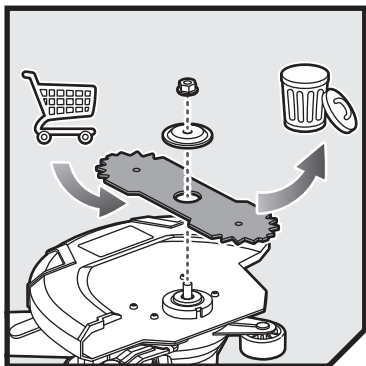

# REPLACING THE BLADE

1. Remove the battery pack.
2. Place the product on a level surface on the ground. Position the product with the motor side down and the blade guard side up.
3. Align the slot in the inner flange with the slot in the motor ring. Insert the locking pin through both slots to secure. Loosen and remove the flange nut using the combination wrench.
4. Remove the blade from the motor shaft.

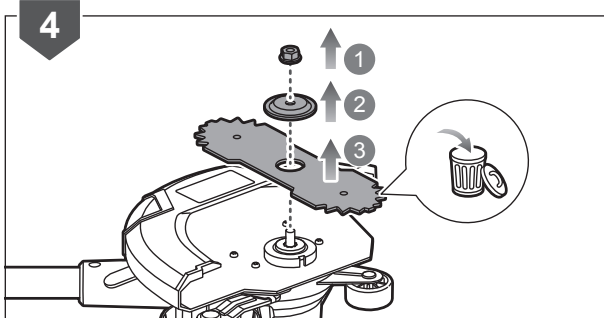
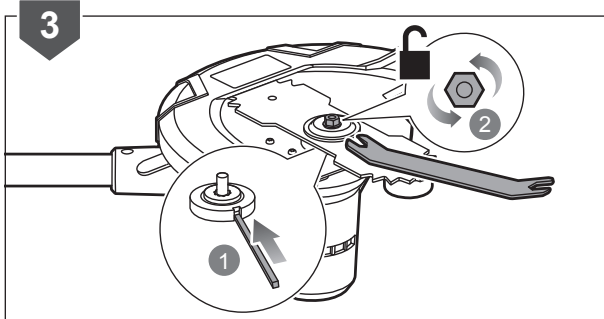
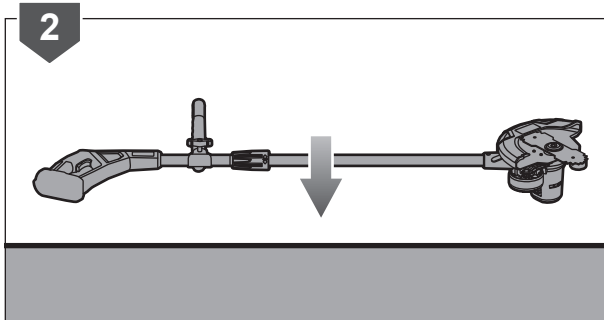
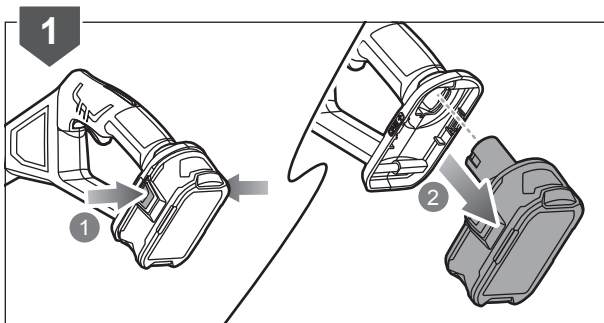



5. Center the new blade on the inner flange, making sure that the blade sits flat.

**NOTE:** Install the outer flange properly. Only the outer ring of the outer flange, not the inner ring with the hole, must touch the blade.

6. Align the slot in the inner flange with the slot in the motor ring. Insert the locking pin through both slots to secure. Tighten the flange nut into place using the combination wrench.
7. Remove the locking pin from the inner flange.

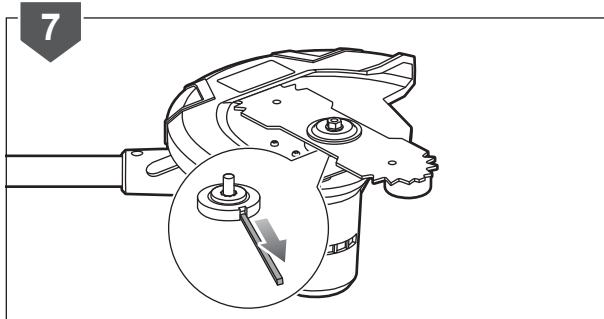
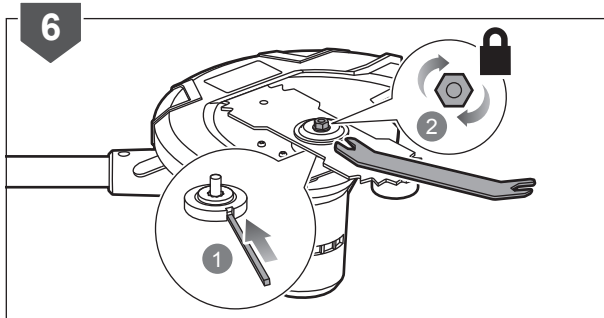
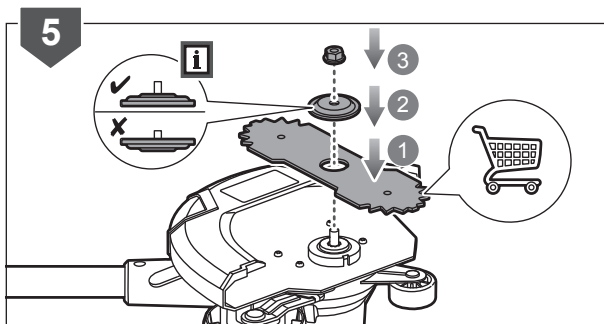

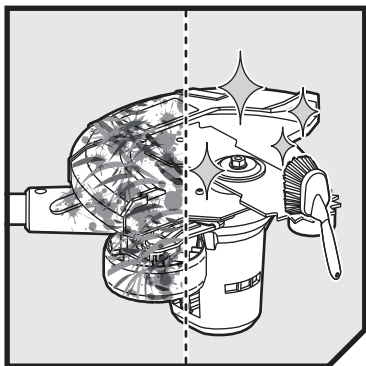

## CLEANING THE EDGER

1. Remove the battery pack.
2. Clean all foreign material from the product with a soft, dry brush.

**WARNING:** Avoid using solvents when cleaning plastic parts. Most plastics are susceptible to damage from various types of commercial solvents and may be damaged by their use.

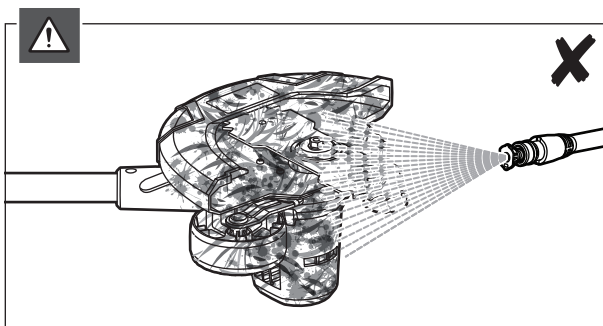
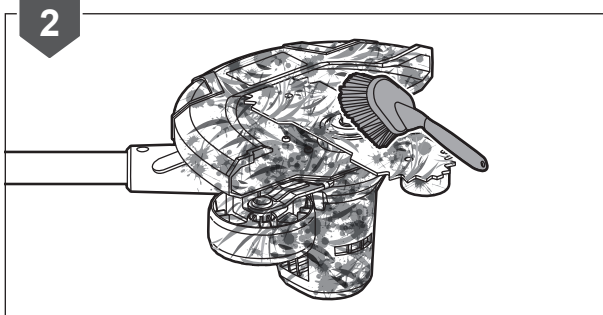
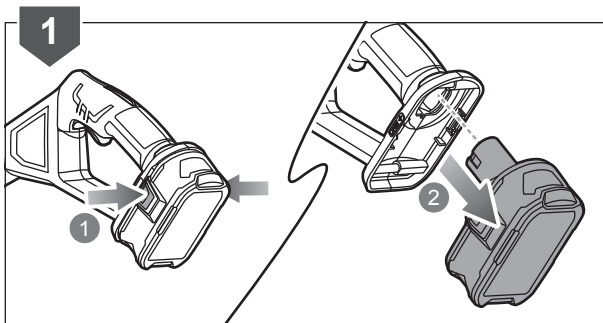

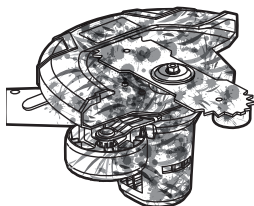
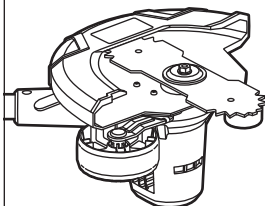
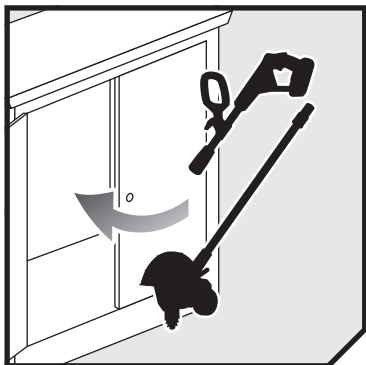

### STORING THE EDGER

**NOTE:** Clean the product before storing.

1. Remove the battery pack.
2. Loosen the coupler. Remove the lower shaft from the upper shaft.
3. Store the product in a cool, dry, and well-ventilated place that is inaccessible to children and away from sources of ignition.

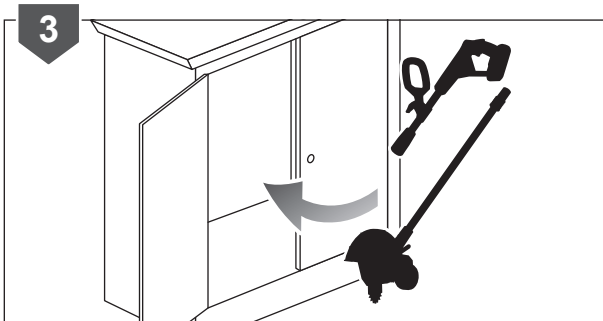
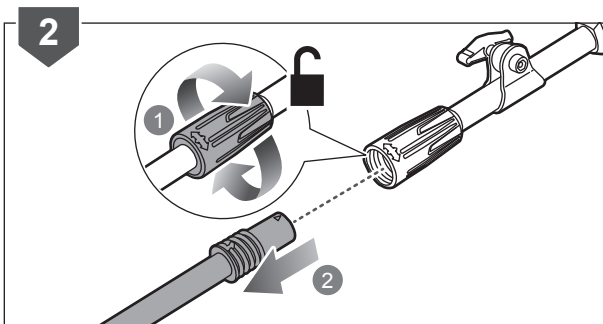
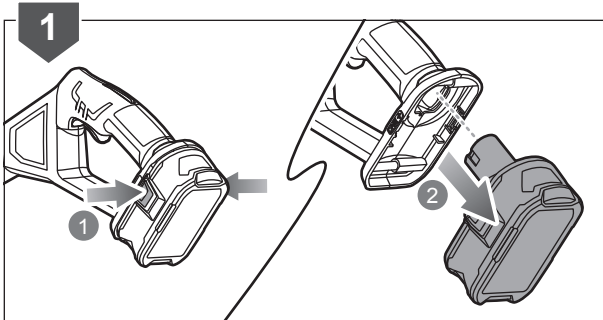

## PRODUCT SPECIFICATIONS

### Cordless Edger

Model	RED1850Li40 / RED1850Li20 / RED1850Li15 / OED1850
Voltage	DC 18 Volts
Blade length	220 mm
No load speed	4,000 min <sup>-1</sup>
Cutting depth	15 mm up to 45 mm
Weight (without battery)	3.3 kg
A-weighted sound pressure level at the operator position	$L_{pA} = 76.3 \text{ dB(A)}$
Uncertainty	K = 2.5 dB
A-weighted sound power level	$L_{WA} = 92.0 \text{ dB(A)}$
Uncertainty	K = 2.5 dB
Vibration level	
Front handle	$a_h = 1.9 \text{ m/s}^2$
Rear handle	$a_h = 1.2 \text{ m/s}^2$
Uncertainty	K = 1.5 m/s <sup>2</sup>

## BATTERY AND CHARGER

Model	RED1850Li40	RED1850Li20	RED1850Li15	OED1850
Battery pack	RB18L40A	RB18L20	RB18L20	Not included
Charger	RC18115	RC18115	RC18115	Not included
Compatible battery packs	RB18L13, RB18L15, RB18L20, RB18L20A, RB18L25, RB18L26, RB18L40, RB18L40A, RB18L50, RB18L60, RB18L90			
Compatible charger	RC18120, RC18150U, RC18627U, BCL1418IV, RC18115, RC18150, BCL14181H, BCL14183H			

## REPLACEMENT PART

Blade	RAC1104
-------	---------

## VIBRATION LEVEL

The declared vibration value has been measured with a standard test method and may be used to compare one tool with another.

The declared vibration value may be used in a preliminary assessment of exposure.

The vibration emission during actual use of power tool can differ from the declared total value depending on the ways in which the tool is used.

Identify safety measures to protect yourself based on an estimation of exposure in the actual conditions of use, taking account of all parts of the operating cycle such as the times when the tool is switched off and when it is running idle in addition to the trigger time.









Imported by:

**Techtronic Industries Australia Pty Ltd**  
31 Gilby Road, Mount Waverley, VIC 3149,  
Melbourne, Australia

**Techtronic Industries N.Z. Limited**  
Unit C, 70 Business Parade South,  
Highbrook, Auckland 2013, New Zealand

*RYOBI is a trademark of Ryobi Limited,  
and is used under license.*