

FIX-A-LOO®

Hush Flush®

CISTERN INLET VALVE INSTALLATION INSTRUCTIONS

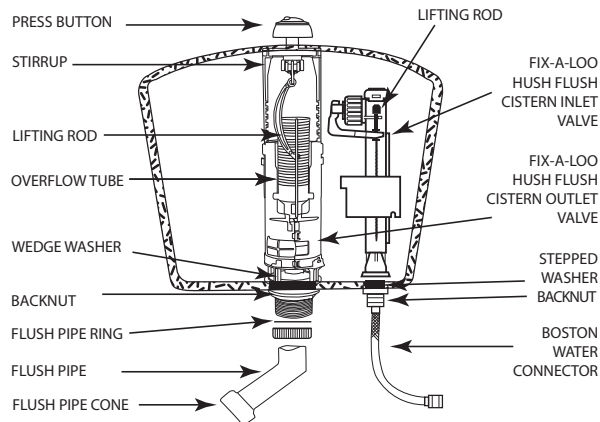

1. Turn off water at mini tap, flush cistern and remove cistern lid.
2. Place a bucket under the cistern inlet valve hole as an amount of water may remain in the cistern.
3. Unscrew water connector from old inlet valve.
4. Unscrew backnut from old inlet valve, then remove valve from cistern.
5. Remove backnut from the bottom of the new Hush Flush® inlet valve and insert valve. Stepped washer should be inside cistern, pointed end facing towards the cistern hole. Do not assemble backnut at this stage.

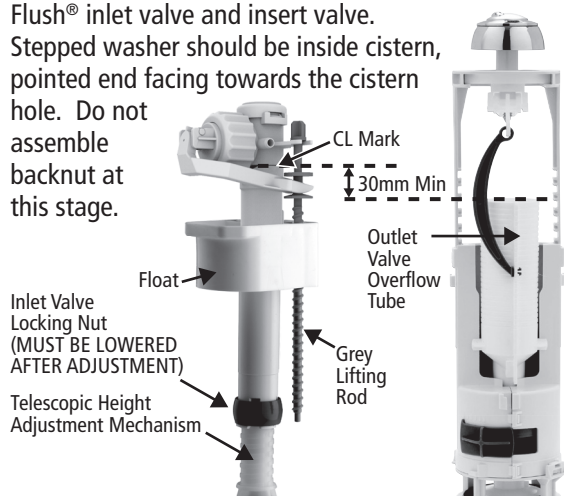

6. To set correct height, raise the locking nut and adjust the inlet valve by rotating the telescopic height adjustment mechanism (anti-clockwise for greater height, clockwise for less height). The correct height is when the Critical Level mark (CL or Max Level marked on the valve) is a minimum of 30mm above the overflow tube on the outlet valve.
7. Lower the locking nut back into place. The locking nut **MUST** be in place to prevent any unintentional height adjustment during use.
8. Fit backnut flat side up and tighten (do not overtighten).
9. Fit new BOSTON® water connector. (Do not cross thread and do not use thread seal tape).
HANDY HINT: For areas with excessive water pressure (over 1000 Kpa) it is recommended to fit a pressure reduction valve to the main water line.
10. Turn on water and check for leaks. To adjust water level, raise or lower float by twisting the grey lifting rod. This float must always be below the top of the overflow tube on the outlet valve.
11. Re-check inlet valve height to ensure a minimum 30mm gap between the CL mark and the top of the overflow tube.
12. Place cistern lid back into position.

MAINTENANCE

The headseal washer and stepped washer are not covered by the 12 year warranty, and should be replaced regularly to maintain a leakproof seal.

The filter from the bottom of the unit should be removed and washed periodically.

Filter (#101372) →

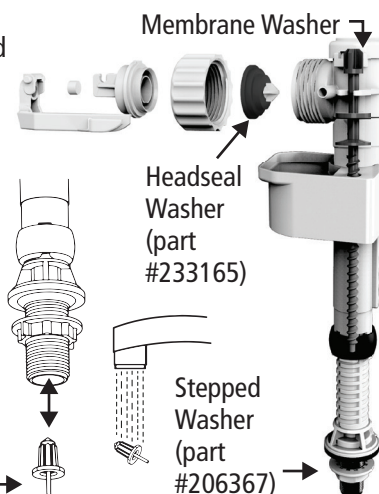

PRODUCT WARRANTY

12 YEAR WARRANTY

This warranty runs for twelve years from the date of purchase. Our products come with guarantees that cannot be excluded under the Australian Consumer Law. You are entitled to a replacement or refund for a major failure and for compensation for any other loss or damage. You are also entitled to have the goods repaired if the goods fail to be of acceptable quality and the failure does not amount to a major failure.

WHAT IS COVERED:

This warranty covers any defects in materials or workmanship with the exception of the reasons stated below. The warranty covers the product used in normal domestic use.

WHAT IS NOT COVERED:

This warranty does not cover wear and tear to working parts, misuse or abuse. It does not cover discolourations due to exposure to cleaning chemicals. **The warranty does not cover the headseal washer (replacement part #233165) or the stepped washer (replacement part #206367). Warranty will be void if locking nut is not secured before use.**

CLAIM PROCEDURE:

If you believe that you have a legitimate claim with your FIX-A-LOO® Hush Flush® Inlet Valve, please contact Fix-A-Tap Australia via our website at www.fixatap.com.au to complete the warranty claim form. Alternatively you can contact our office on (02) 9476 7400. Any written correspondence should be sent to: Fix-A-Tap Australia, Units 1-2, 41 Leighton Place, Hornsby NSW 2077. Please keep your receipt for proof of purchase.



A family owned Australian business

Quality Assured Products
FIX-A-TAP has been providing Australians with quality plumbing products since 1972.

FIX-A-TAP®
AUSTRALIA PTY LTD
The Ultimate Plumbing Solution
PO Box 200 Wahroonga
NSW Australia 2076
www.fixatap.com.au
Made in Vietnam



WaterMark
AS 1172.2:2014
WMKA25201
SAI GLOBAL