

1 Door Tall Unit

IMPORTANT

Before commencing Assembly:

- Read all instructions **COMPLETELY**.
- Hardware kit contains small parts; keep out of reach of children.
- Ensure all listed parts are present.
- Required tools to assemble:
Phillips head screw driver, Hammer & Wood Glue (optional for extra strength).
- Required assembly work surface should be solid, level, clean and flat.
- Ensure all melamine edges are facing to the front of the unit.

Detailed instructions are available by visiting:
<http://www.bedfordfurniture.com.au/>

Customer Services Enquiries 1800 822 823

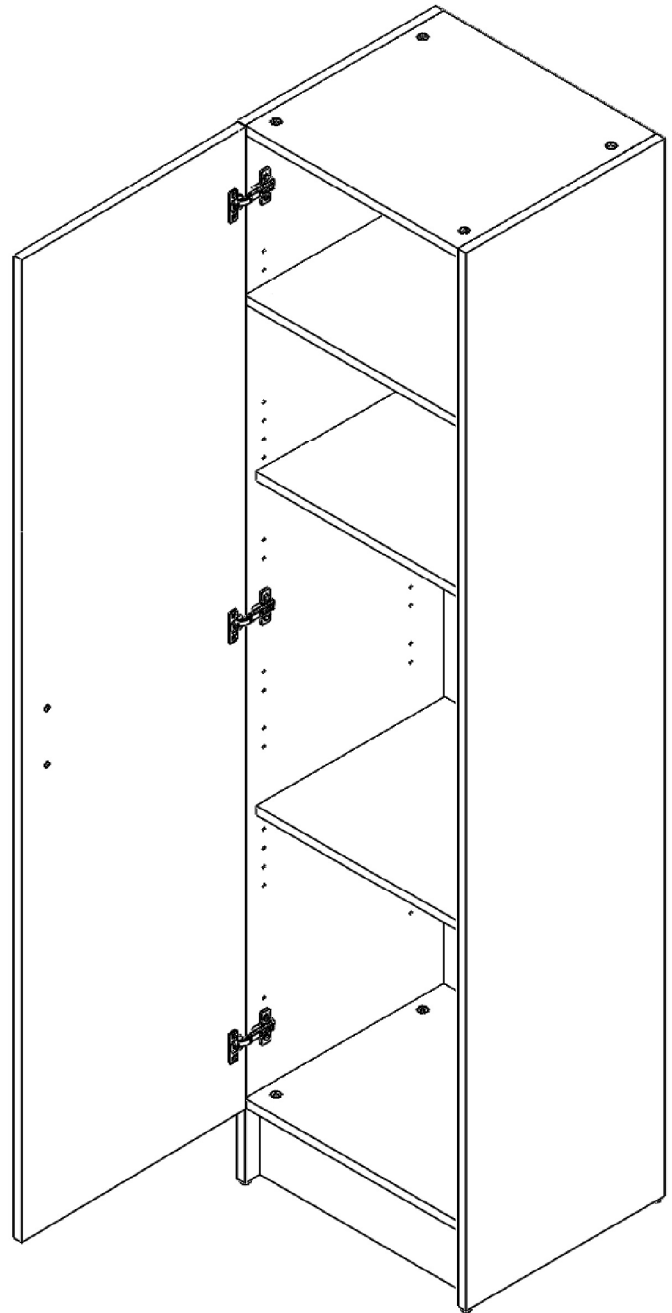

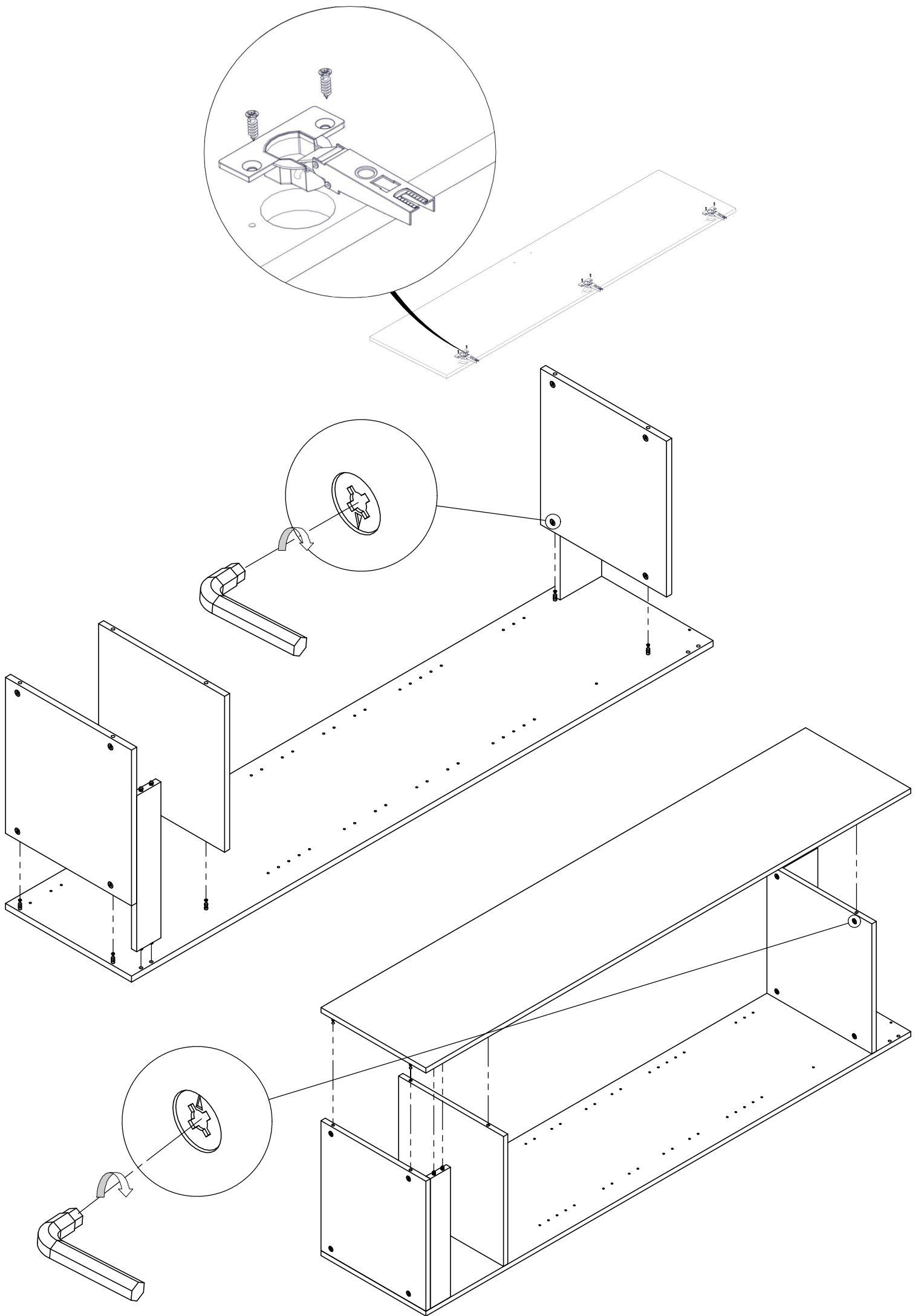

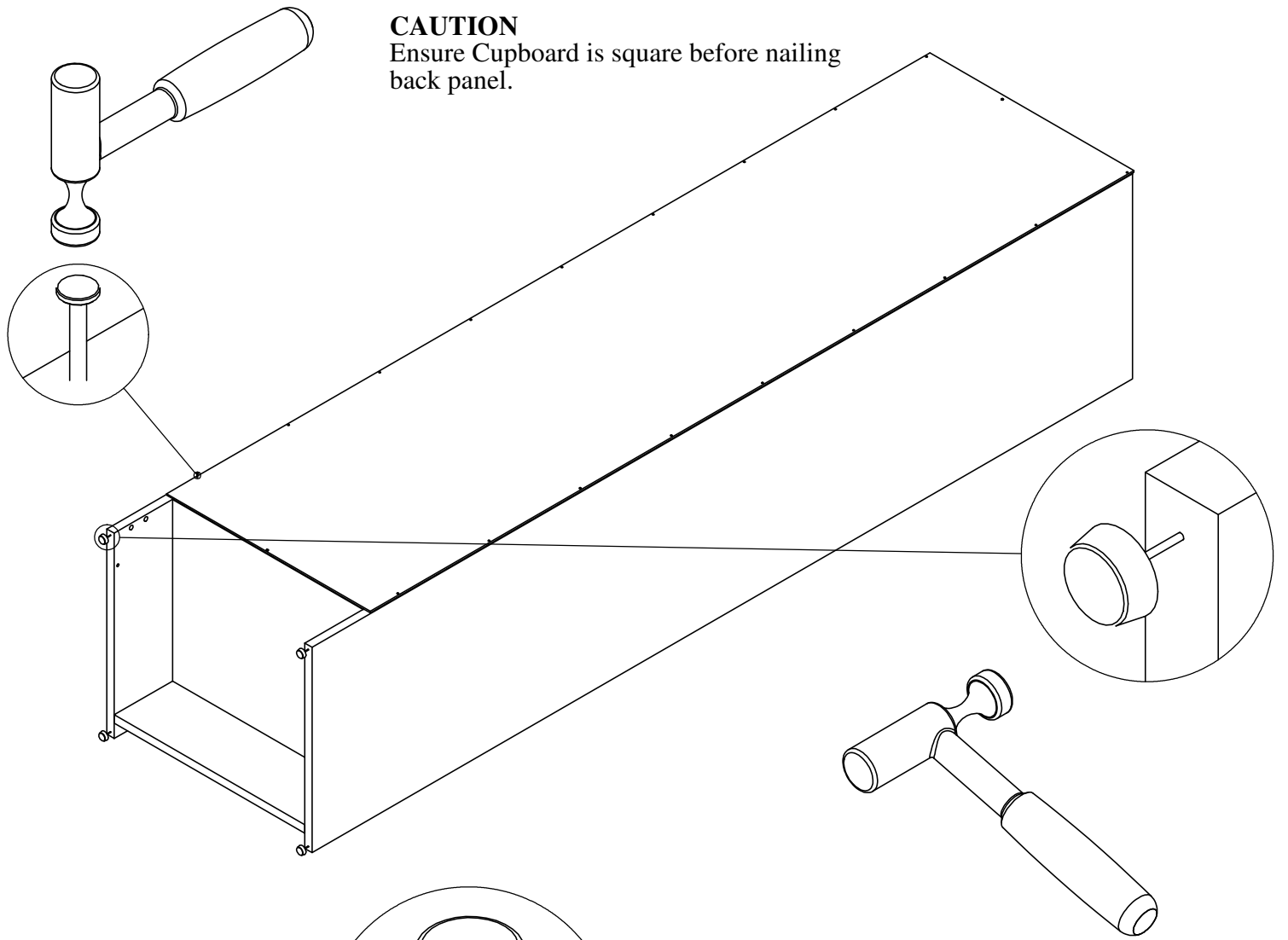

CAUTION
Ensure Cupboard is square before nailing back panel.

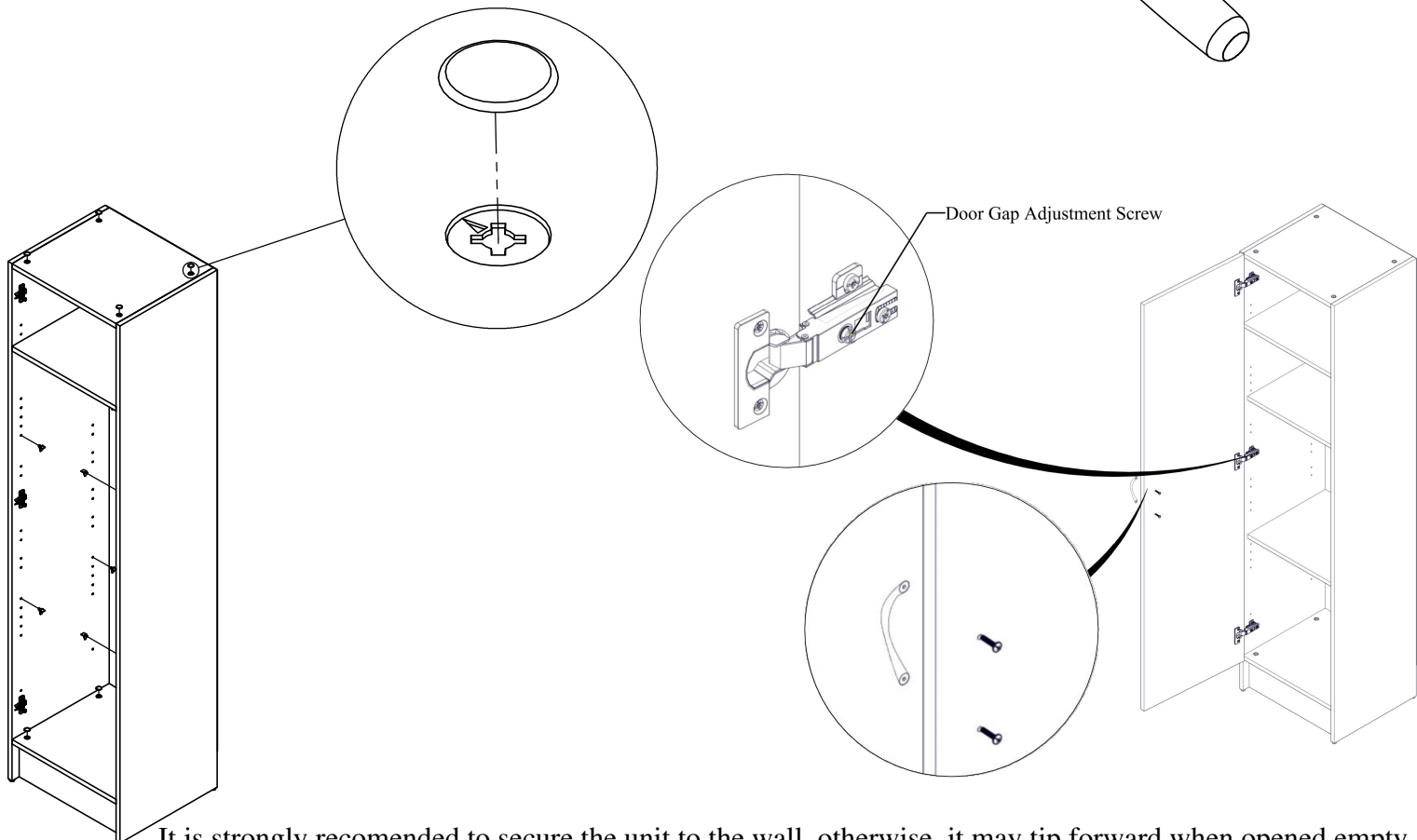

It is strongly recommended to secure the unit to the wall, otherwise, it may tip forward when opened empty.
Please consult point of purchase for the correct fixings required for your wall.

Bedford Furniture is part of the Bedford Group. Bedford is a South Australian not-for-profit organisation dedicated to enhancing the lives of people with a disability or disadvantage through employment, training, residential services and life-skills.