

Product Guide

alfrescoplus.co.nz



WE WILL
ASSEMBLE



WE WILL
DELIVER



SPECIAL
ORDERS

Create
your own
OUTDOOR KITCHEN



It's easy as...

STEP 1

Measure Your
Space

STEP 2

Select Your
Appliances

STEP 3

Choose Your
Cabinets

STEP 4

Pick Your
Colour

AlfrescoPlus™

Available at
BUNNINGS
warehouse



Create your own OUTDOOR KITCHEN

It's easy as...

STEP 1

Measure Your Space

STEP 2

Select Your Appliances

STEP 3

Choose Your Cabinets

STEP 4

Pick Your Cabinet Colour



AlfrescoPlus™

Outdoor BBQ kitchens

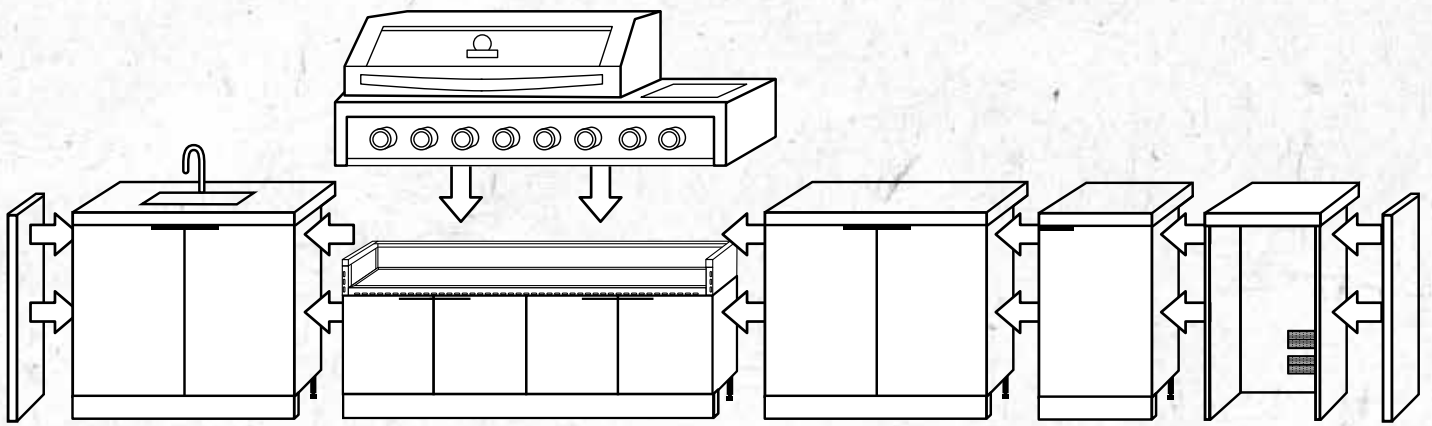

The epitome of beauty and function rolled into one. We bring together market leading appliances, premium materials and award-winning services to make your Outdoor BBQ Kitchen more than just a dream. Your AlfrescoPlus™ outdoor kitchen can be made as small or large as you like - to suit your alfresco area and your budget.





Pre-packaged Flatpack AlfrescoPlus™ DIY Range

The AlfrescoPlus™ Range makes it easy to get your outdoor BBQ kitchen setup. We've done the thinking for you, packing popular colour palettes with ready to go appliances making your install from start to finish achievable by the DIYer. The modules are all delivered in a flat pack form for easy transport.



AlfrescoPlus™ Aluminium Frame

The AlfrescoPlus™ aluminium framing system provides the backbone of our outdoor kitchens. They harness the power of technological advances and engineering perfection, bringing together a patented cabinetry system that's unlike anything else on the market.

100% Waterproof

When combined with waterproof PVC panels, AlfrescoPlus™ aluminium extrusions join seamlessly, forming a rigid and robust cabinetry solution that is almost 4 times quicker to construct than traditional cabinetry.



We Have You Covered

Backed by our friendly customer service and guaranteed warranties. We use quality materials and offer a 15 year structural warranty for your peace of mind*. You don't need to worry about a thing.

* It is recommended that your AlfrescoPlus™ Outdoor Kitchen is assembled, installed and positioned wholly or partially under cover. This will protect the unit from the elements and generally keep it cleaner.



Order at the Special Orders desk or Shop Online:
bunnings.co.nz/alfrescoplus

alfrescoplus.co.nz



Follow us on Facebook and Instagram
[@alfrescoplus_aus](https://www.instagram.com/alfrescoplus_aus)

STEP 1

Measure Your Space

Your AlfrescoPlus™ outdoor kitchen can be made as small or as large as you like – to suit your alfresco area and your budget. The options are limitless.

Design your outdoor kitchen area using our measurement and grid system on page 18.



Every outdoor kitchen starts with a vision.

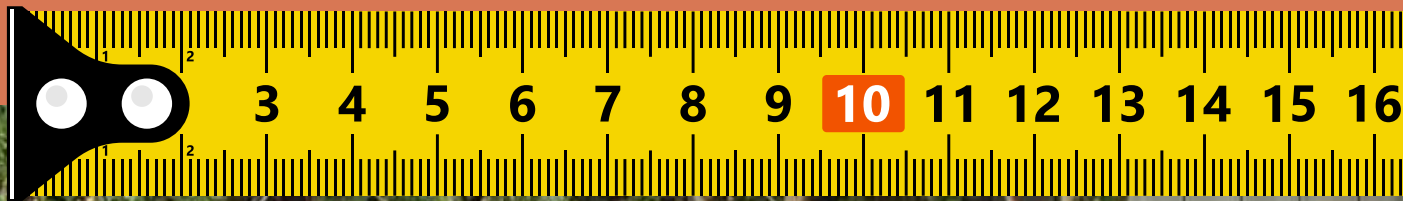

STEP 2

Select Your Appliances

New Zealanders love their barbecues and outdoor lifestyle. Our commitment to excellence in quality, design and both technical standards and innovation means that with AlfrescoPlus™ you can transform your outdoor space into a desirable alfresco area, perfect for entertaining. Choose your appliances for your alfresco kitchen from the extensive range at Bunnings.



Important Installation Information:

1. It is recommended that your AlfrescoPlus™ Outdoor Kitchen is assembled, installed and positioned wholly or partially under cover. This will protect the unit from the elements and generally keep it cleaner.
2. When positioning the outdoor kitchen, it must conform to New Zealand Standards. i.e. open ventilation and also distance to combustible surfaces. Refer to your BBQ instruction manual for more details.

Market Leading Appliances

BBQ's, Fridges and Rangehood

Gasmate
the outdoors made easy



GASMATE PLATINUM III
6 BURNER BUILT IN BBQ
BQ1080B - I/N: 3171291
To Suit: BBQ CABINET
MODULE - 1530mm



MATADOR BOSS
4 BURNER BUILT IN BBQ
I/N: 3180787
To Suit: BBQ CABINET
MODULE - 885mm



MATADOR SINGLE DOOR
118L - STANDARD
BAR FRIDGE
MF118FV1
I/N: 3171041
505mm W x 505mm D
x 850mm H



MATADOR DOUBLE DOOR
228L - STANDARD
BAR FRIDGE
MF228FV1
I/N: 3171042
905mm W x 505mm D
x 850mm H



AIRFLOW

AIR FRAME TECHNOLOGY SYSTEM

AlfrescoPlus™ patented Air Frame system, included with every BBQ module, provides a heat proof shield between the BBQ and cabinetry.

STEP 3

Choose Your Cabinets

There are single and double sink, fridge and storage modules in the AlfrescoPlus™ range to choose from. There are also various sized BBQ modules to suit your preferred BBQ.

The AlfrescoPlus™ modules feature PVC panels which are impervious to water and won't crack, split or rot and AlfrescoPlus™ patented aluminium frames which make assembly easy for any DIYer.

All modules come pre-packaged and flat-packed!

*NOTE: All BBQs come with vented cabinets that comply to New Zealand standards for LPG cylinder storage.

BBQ Modules - including Air Frame

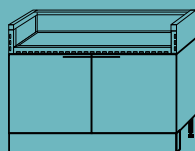

BBQ Module - 885mm

885mm W x 580mm D x 640 </> 660mm H

Internal width of Air Frame: 825mm W

To Suit: MATADOR BOSS 4 BURNER BBQ

CADET GREY	APBBM885G	I/N: 0119412
BLACK ONYX	APBBM885B	I/N: 0209860

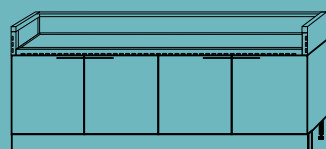

BBQ Module - 1530mm

1530mm W x 580mm D x 640 </> 660mm H

Internal width of Air Frame: 1470mm W

To Suit: GASMATE PLATINUM III 6 BURNER BBQ

CADET GREY	APBBM1530G	I/N: 0209862
BLACK ONYX	APBBM1530B	I/N: 0119424

AlfrescoPlus™ single, double, sink and fridge modules

Single Modules

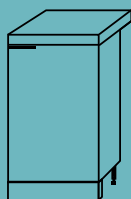

Single Module

550mm W x Cabinet 580mm D +

*Top 730mm D x 925 </> 950mm H

CADET GREY APSDMG I/N: 0119425

BLACK ONYX APSDMB I/N: 0119426

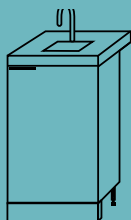

Single Sink Module

550mm W x Cabinet 580mm D +

*Top 730mm D x 925 </> 950mm H

CADET GREY APSSMG I/N: 0119428

BLACK ONYX APSSMB I/N: 0119429

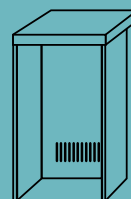

Single Fridge Module

550mm W x Cabinet 580mm D +

*Top 730mm D x 925 </> 950mm H

APSFM I/N: 0119658

Double Modules

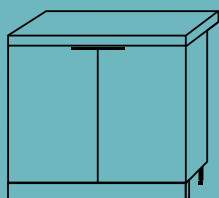

Double Module

960mm W x Cabinet 580mm D +

*Top 730mm D x 925 </> 950mm H

CADET GREY APDDMG I/N: 0119432

BLACK ONYX APDDMB I/N: 0119659

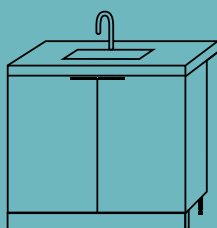

Double Sink Module

960mm W x Cabinet 580mm D +

*Top 730mm D x 925 </> 950mm H

CADET GREY APDSMG I/N: 0119434

BLACK ONYX APDSMB I/N: 0119435

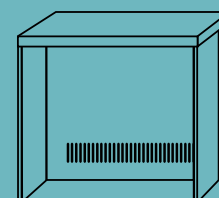

Double Fridge Module

960mm W x Cabinet 580mm D +

*Top 730mm D x 925 </> 950mm H

APDFM I/N: 0209864

x2 End Panels



End panels are needed to finish off your BBQ Kitchen cabinetry. Order them in the same colour as your cabinetry to ensure that your AlfrescoPlus™ BBQ kitchen is completely correct!

22mm W x 730mm D x 915mm H

CADET GREY APCEP2PGRY I/N: 0209863

BLACK ONYX APCEP2BLK I/N: 0119438

*NOTE: Tops on Single and Double modules are deeper than the cabinets to allow for hot and cold plumbing, electrical cords and drainage to run behind the outdoor kitchen when assembled. The legs on each module are designed to be adjusted for levelling.

STEP 4

Pick Your Cabinet Colour

All modules come with a stunning UV stabilised black acrylic quartz bench top finish and can be fitted with a choice of 2 different colour compact laminate doors. All fitted with high quality hardware, levelling legs and kicker panels.

Choice of 2 Colours



Module Possibilities



INCLUSIONS

Bench Tops, Taps, Sinks and Handles

Finish on a high! Designer Tap, Sink and Door Handle hardware to complete your outdoor kitchen.

AlfrescoPlus™ have combined high quality materials expected by the chef in all of us. Clean surfaces that are nice to touch and resistant to all BBQ cooking methods that take place over years of use.

Designed perfectly for busy gatherings, capable of creating spaces that make preparing food a pleasant experience that precedes the pleasure of sharing a meal with friends or family. These finishes represent beauty and solidity with easy, fuss free cleaning and what really matters is that you do not have to worry about scratches, stains or traces of heat. A simple wipe with a cloth is all it takes so you can spend more time entertaining.

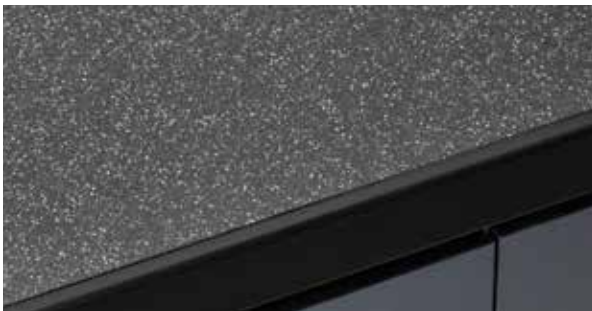

Black Acrylic Quartz Bench Tops

Resistant to scratching, virtually zero porosity and highly resistant to aggressive chemicals, high temperatures and UV rays.



Mixer Tap

Our AlfrescoPlus™ Gooseneck Matte Black WELS rated Mixer Tap gives your outdoor kitchen a modern, contemporary look and feel. The outdoor kitchen mixer tap is designed for full hands, the long spout enables you to use your elbow if you need to move the spout out of the way. The 360° swivel function makes this an efficient tap for your outdoor kitchen.



Single and Double Sinks

Our AlfrescoPlus™ Matte Black single and double sinks are made from premium materials for a more robust finish and design.

Single Sink

OVERALL SIZE: 450 x 300 x 200mm

Double Sink

OVERALL SIZE: 500 x 400 x 300mm

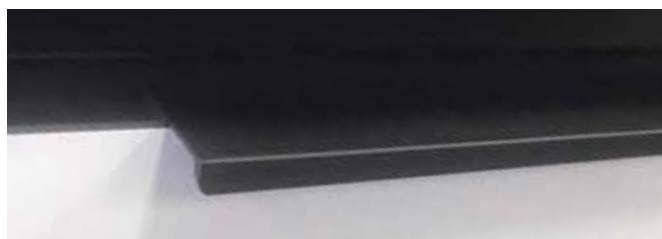

Handles

Black, ergonomic and elegant handles.

AlfrescoPlus™ storage, sink and fridge module kits



Alfrescoplus™ Pre-Designed DIY Outdoor Kitchen Range

The ultimate outdoor kitchen solution for your outdoor alfresco area.

Our fabrications are second to none making your outdoor kitchen easy to measure, design and build.

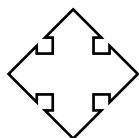

Easy Assembly

Easy to follow, step by step guides and online assembly videos, taking your DIY experience to the next level. The modules are supplied flat-packed and are easy to transport and assemble. However, you can always have an approved assembler do it for you.

Imagine, design and create.



Market Leading Appliances

An extensive range of market leading appliances – BBQs, Bar Fridges and a Rangehood are available – to make your dream outdoor kitchen a reality.

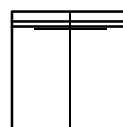

Module Cabinets – Flexible In Configuration

There are single and double sink, fridge and storage modules in the range. And various sized BBQ modules to suit your selected BBQ. Your outdoor kitchen can be made as small or large as you like – depending on your area and budget.

Wels Rated

Standard
AS/NZS 3718
Certification
IAPMO
Model
AQ56016YC
Certificate
WM022545

WELS Licence
1547
WELS Registration
T30270
WELS Rating
4.5 Stars

WaterMark
AS/NZS3718
WM022545
IAPMO



Modules from left to right:
Single Sink Cabinet - Cadet Grey
Gasmate Platinum III 6 Burner BBQ
Gasmate Platinum III 6 Burner BBQ Cabinet - Cadet Grey
Matador Single Fridge
Single Fridge Cabinet
End Panels - Cadet Grey



AlfrescoPlus™







Modules from left to right:
Single Sink Cabinet - Cadet Grey
Gasmate Platinum III 6 Burner BBQ
Gasmate Platinum III 6 Burner BBQ Cabinet - Cadet Grey
Matador Single Fridge
Single Fridge Cabinet
End Panels - Cadet Grey

AlfrescoPlus™



Grid System

It's easy with our measurement and grid system

Start by: Measuring and marking your alfresco dimensions using this grid as a guide for the layout of your outdoor kitchen. Make sure you calculate accurate measurements of cabinets and end panels. Use the measurements of cabinets below.

3m x 5m

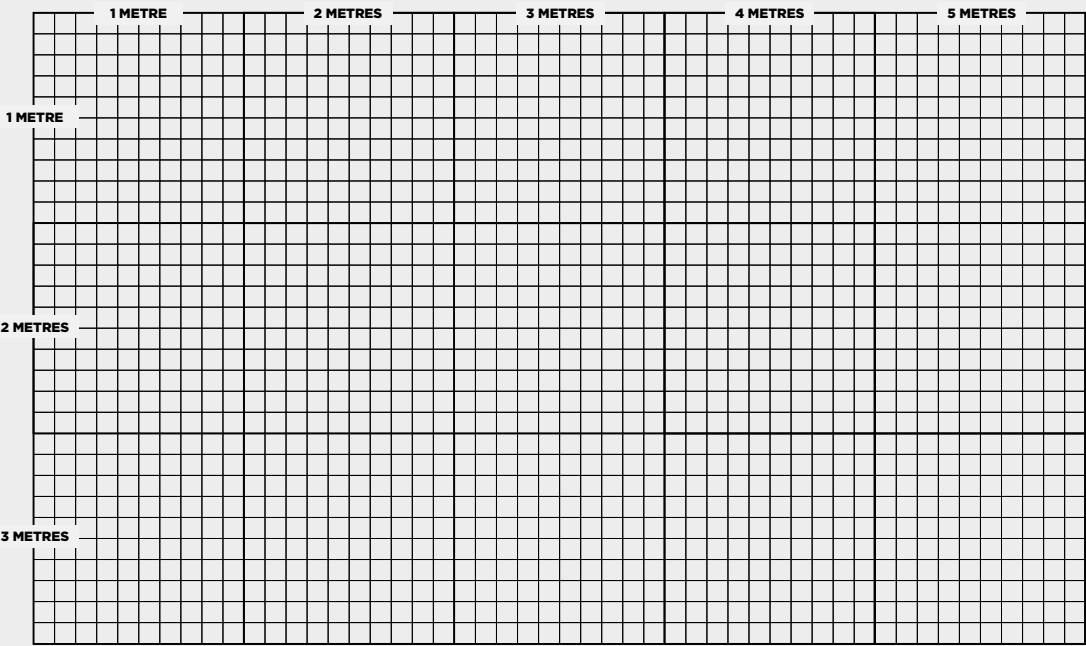

BBQ Modules

- BBQ Cabinet
Module 885mm

885mm W x
580mm D

✂
- BBQ Cabinet
Module 1530mm

1530mm W x
580mm D

✂

Single Modules

- Single
Storage
Cabinet

550mm W
x 730mm
D

✂
- Single
Sink
Cabinet

550mm W
x 730mm
D

✂
- Single
Fridge
Cabinet

550mm W
x 730mm
D

✂

Double Modules

- Double Storage
Cabinet

960mm W x
730mm D

✂
- Double Sink
Cabinet

960mm W x
730mm D

✂
- Double Fridge
Cabinet

960mm W x
730mm D

✂

End Panels

Don't forget your x2 end panels – these are the easiest components to forget when designing an outdoor kitchen but are necessary to really finish off your kitchen.

End Panels 22mm W x 730mm D





**SPECIAL
ORDERS**

How It Works

It's as simple as 1,2,3! Follow the steps shown to purchase or order your product. If you need further advice, speak to a Team Member at the Special Orders Desk in-store.

1. Select The Product You Want

View the extensive range available in this brochure or online. Use the item number shown below to order your product.



2. Order At The Special Orders Desk

After you have selected the product you want, take this brochure to the Special Orders Desk.

3. Collect Your Order

Upon placing your order, your product will arrive in with 25 working days.



**WE WILL
DELIVER**



**WE WILL
ASSEMBLE**

Ask us about Additional Services

Option: You can also opt to have your kitchen delivered and assembled. Contact the Special Orders Desk for a quote.

AlfrescoPlus™

17 Mainstreet Place, Te Rapa, Hamilton, 3200
alfrescoplus.co.nz

AlfrescoPlus™ is a registered Trademark of Aber Holdings Ltd T/A Aber Living.





Modules from left to right:
Double Storage Cabinet - Cadet Grey
Gasmate Platinum III 6 Burner BBQ
Gasmate Platinum III 6 Burner BBQ Cabinet - Cadet Grey
Matador Single Fridge (*front cover*)
Single Fridge Cabinet
Single Sink Cabinet - Cadet Grey
End Panels - Cadet Grey

AlfrescoPlus™

alfrescoplus.co.nz

AlfrescoPlus™ is a registered Trademark of Sitro Group Australia Pty. Ltd. in Australia and Aber Living in New Zealand. Material and design specifications subject to change without notice. Product colour reproduction is as near to actual product colour as production methods allow. AlfrescoPlus™ products in this brochure are the subject of registered designs and patents.