

AEG

GM18EX2

Original instructions

Important!

This appliance is not intended to be used or cleaned by persons with reduced physical, sensory or mental capabilities, or lack of experience or knowledge, unless they have been given instructions concerning the safe use of the appliance by a person legally responsible for their safety. They should be supervised whilst using the appliance.

Children shall not use, clean or play with this appliance, which when not in use should be secured out of their reach.

1. Inflator nozzle
2. Rubber tube
3. Trigger
4. Speed selector
5. Handle, insulated gripping surface

6. Battery port

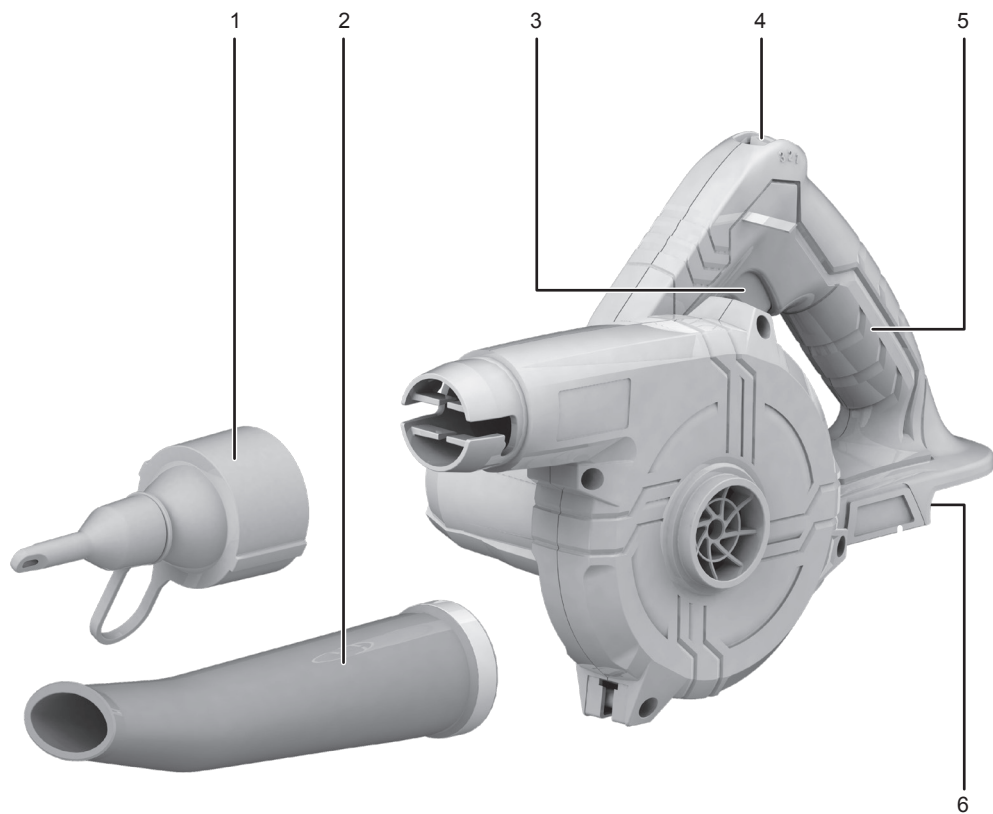

8

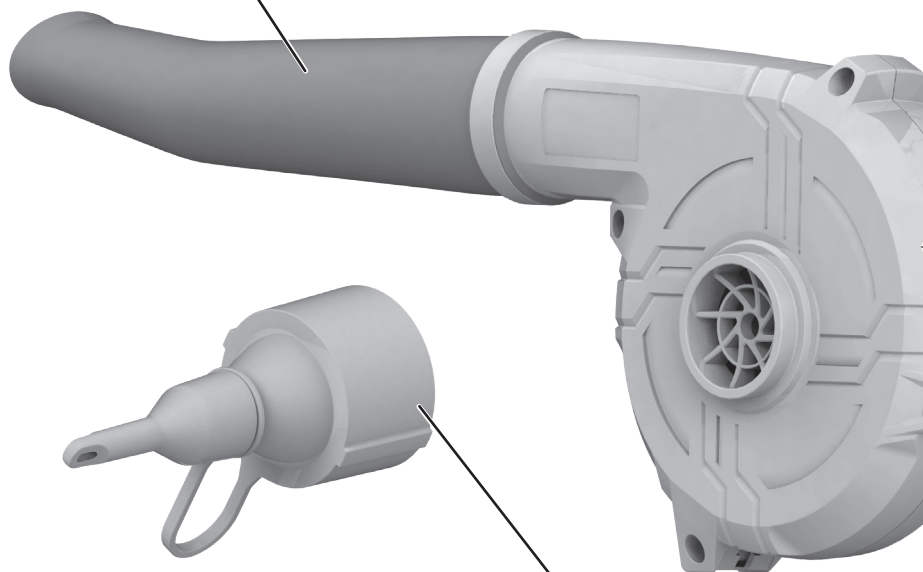
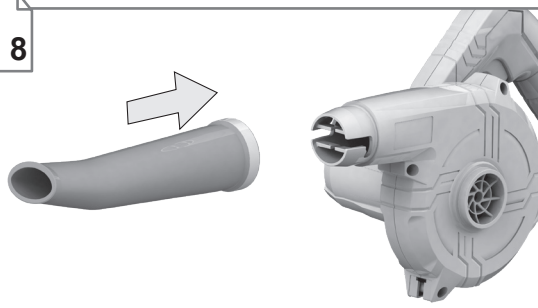

Remove the battery pack before starting any work on the machine.

14

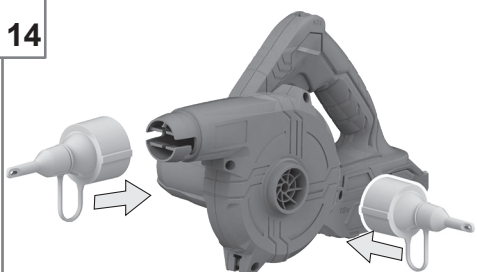

12

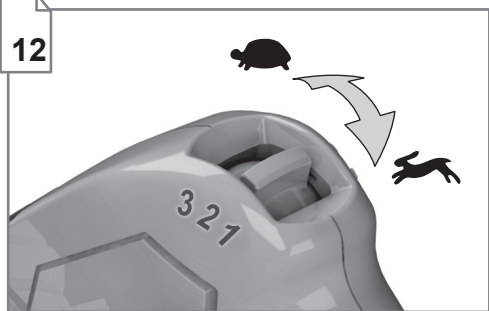

10

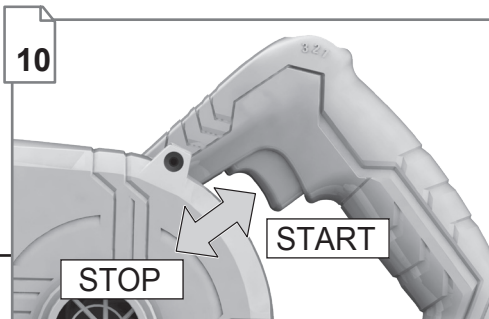

6

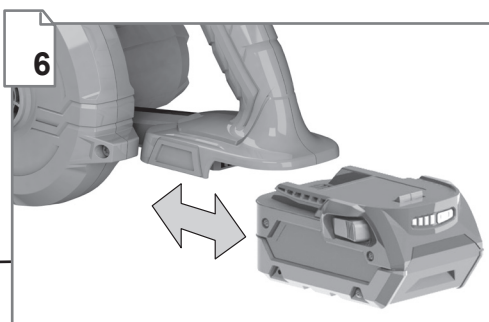

14

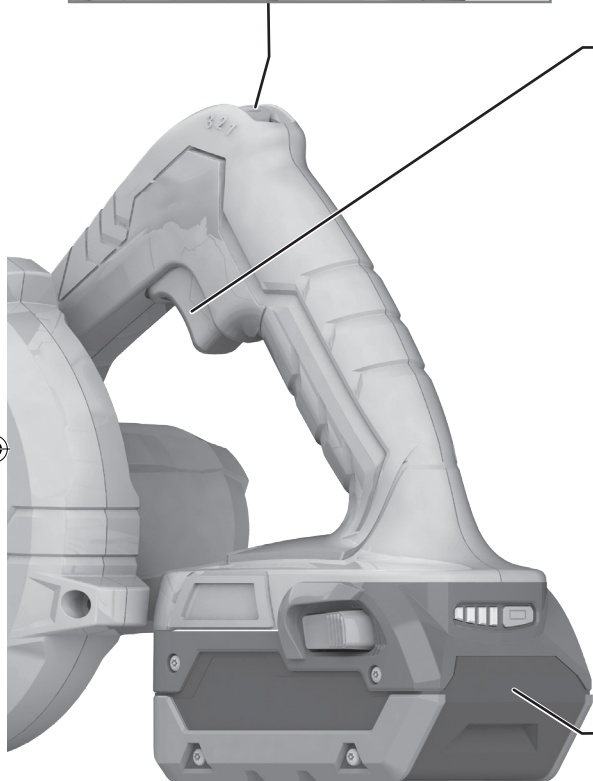
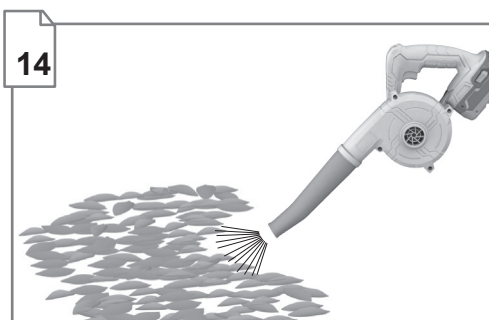

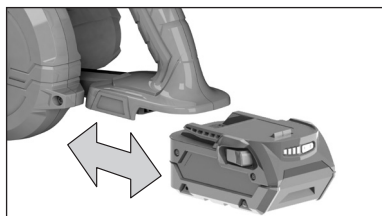

Remove the battery pack before starting any work on the machine.

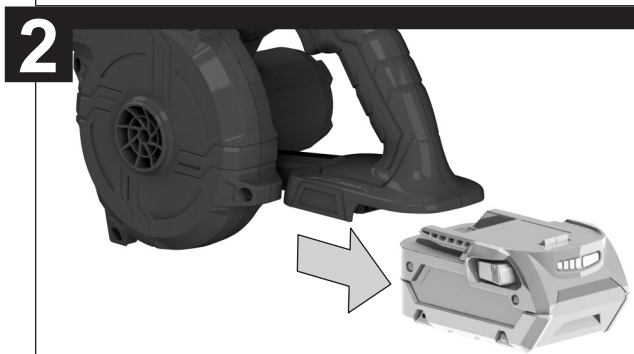
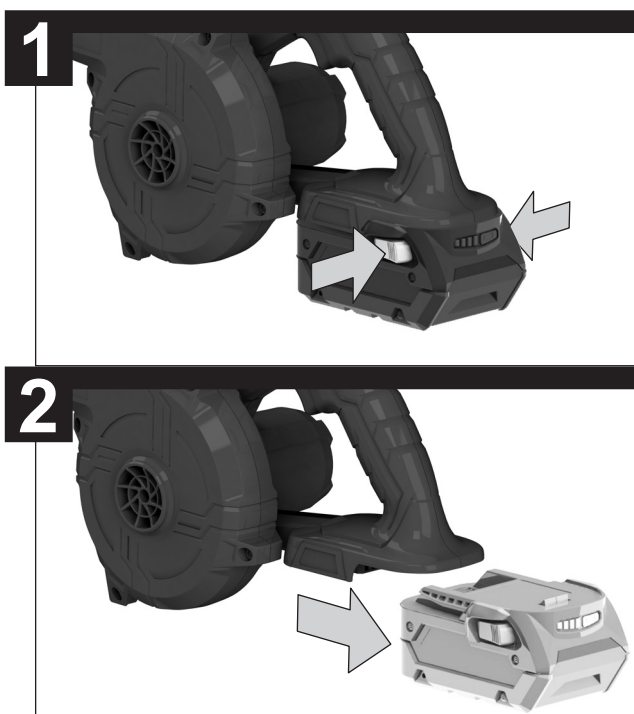
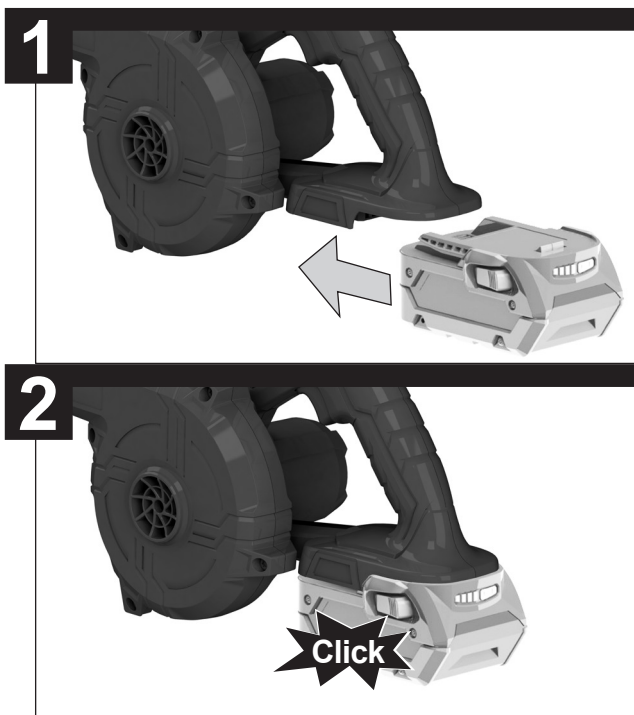

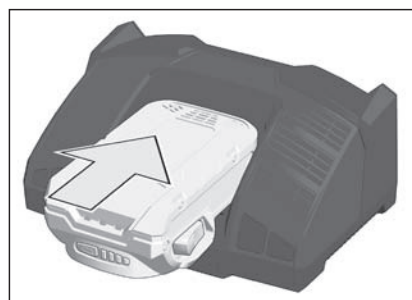
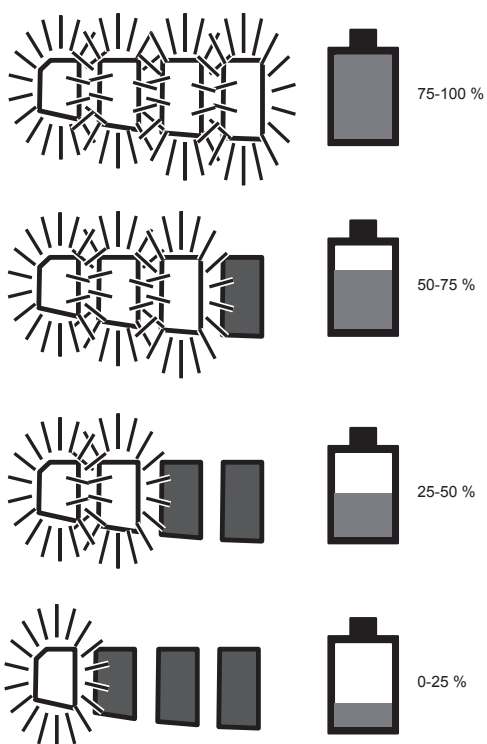
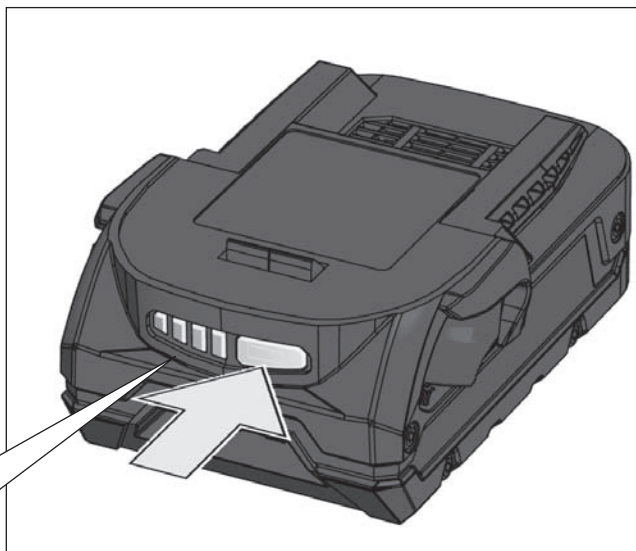

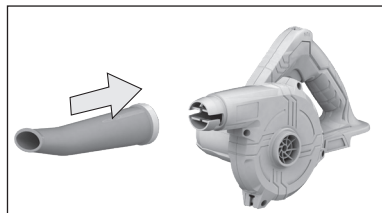

Remove the battery pack before starting any work on the machine.

1

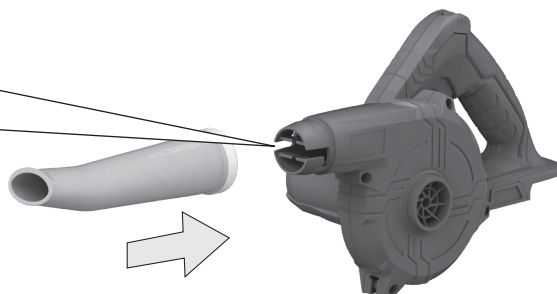
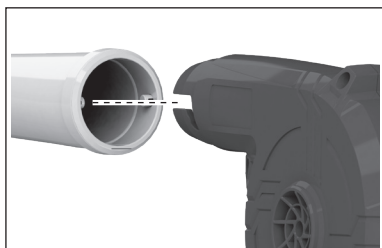

2

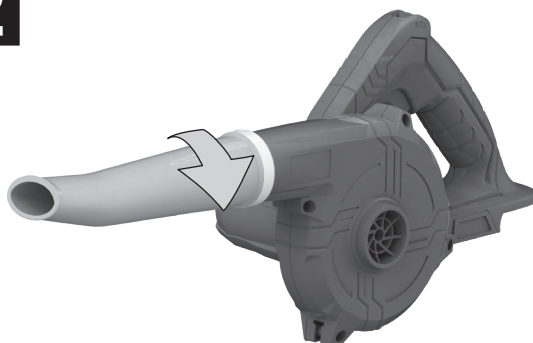

i

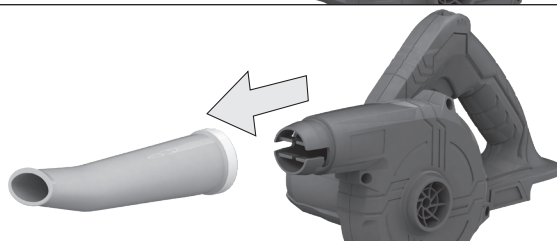
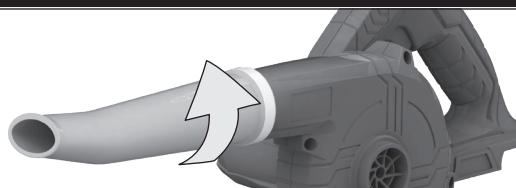

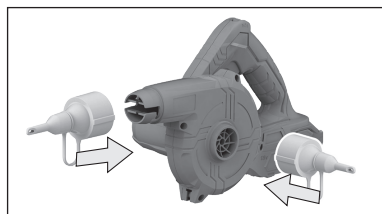

Remove the battery pack before starting any work on the machine.

Attach the inflator nozzle to the air outlet for inflating purposes.

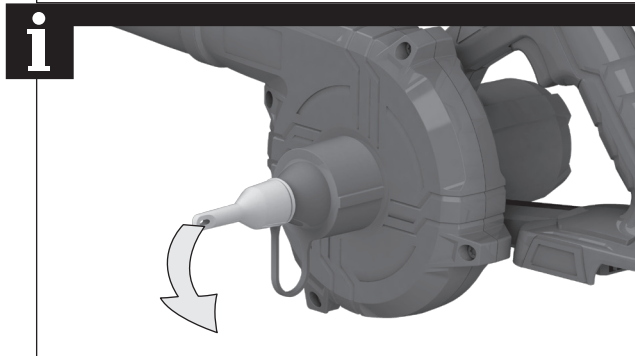
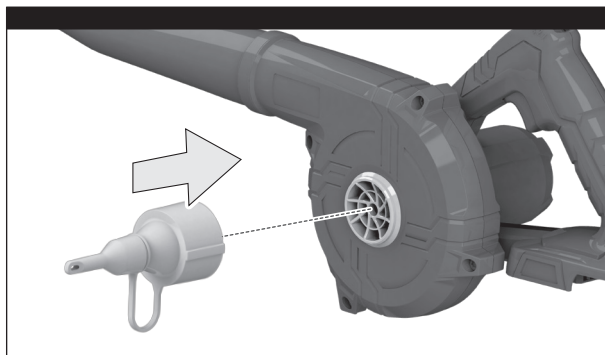
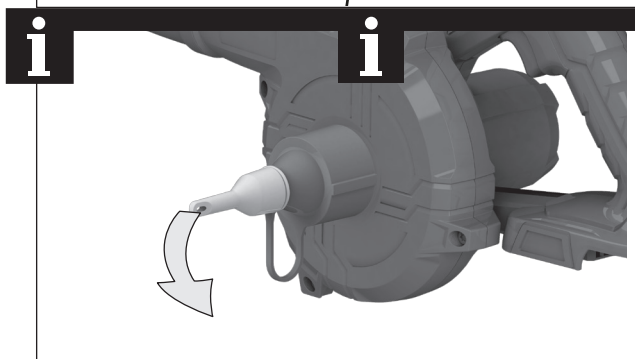
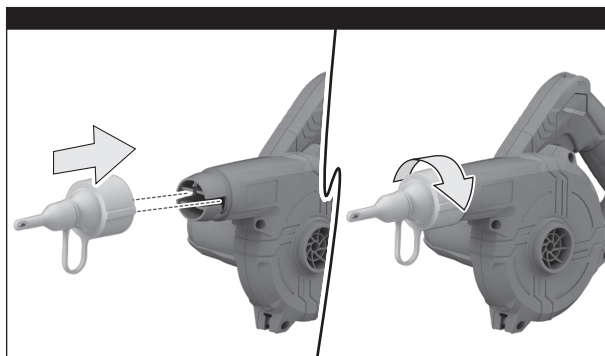

Attach the inflator nozzle to the air inlet for deflating purposes.



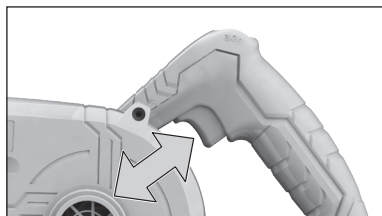

START

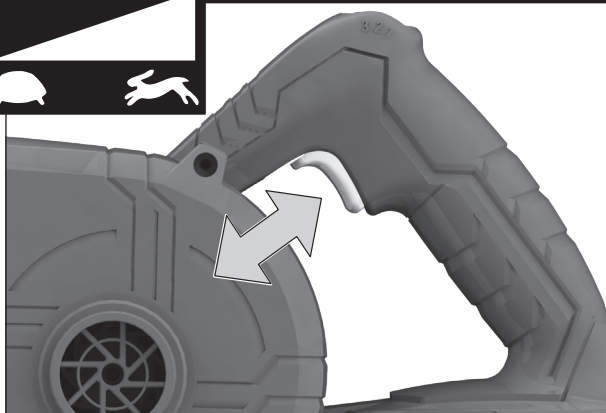
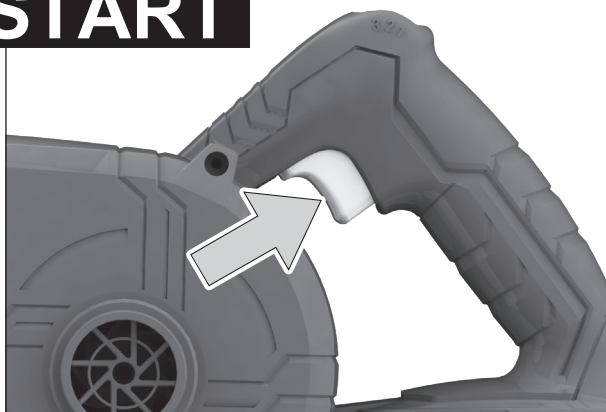

STOP

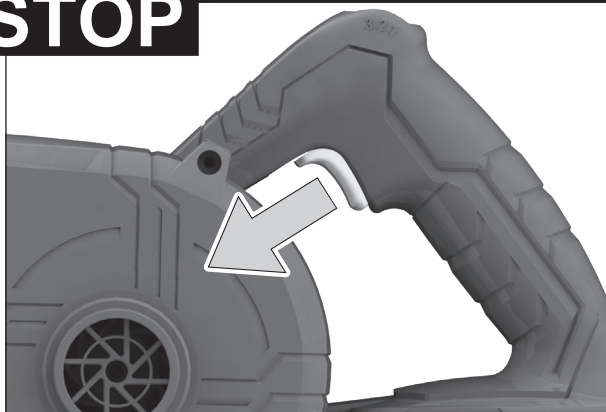

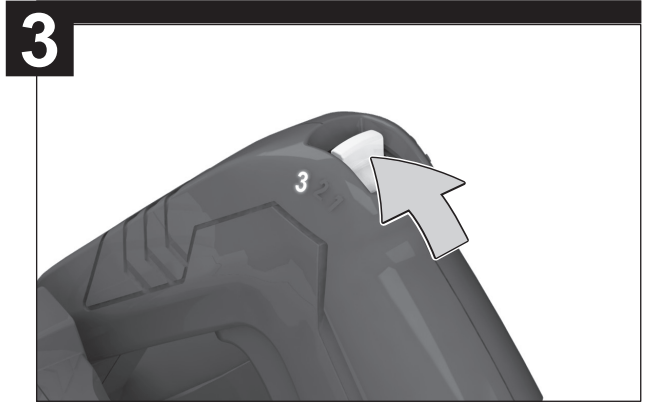
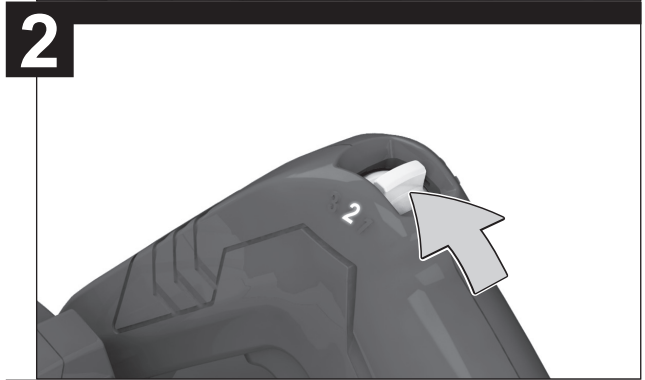
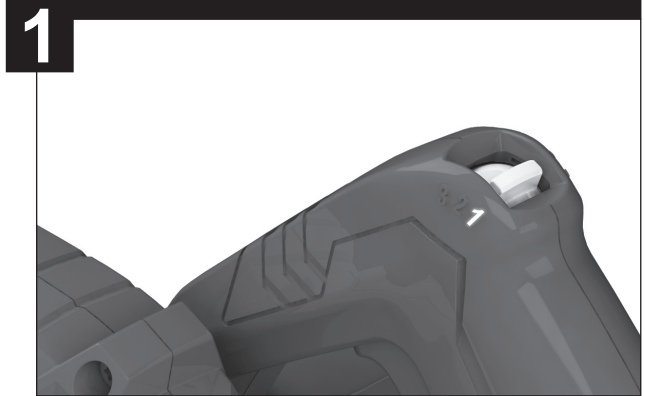
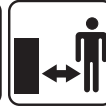
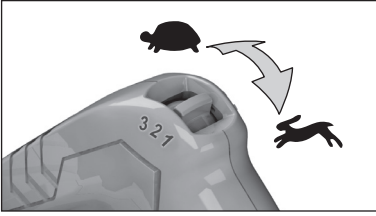

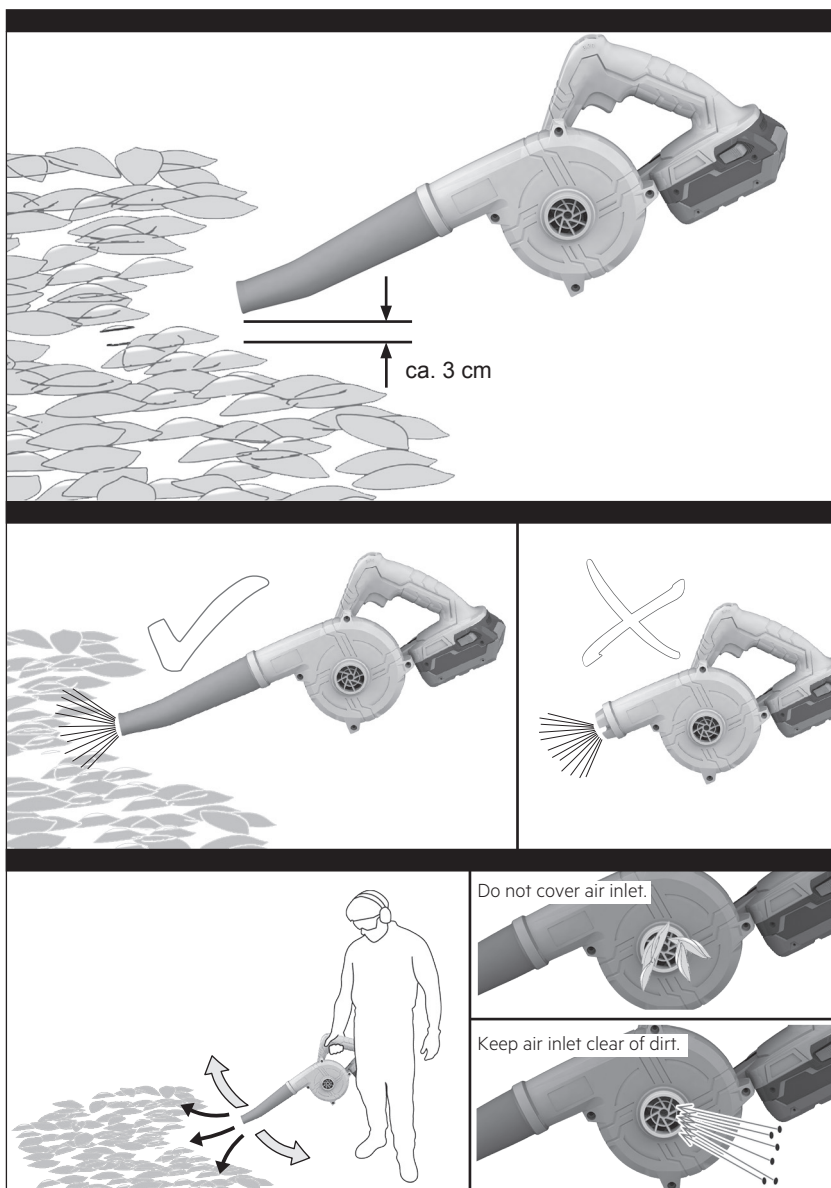
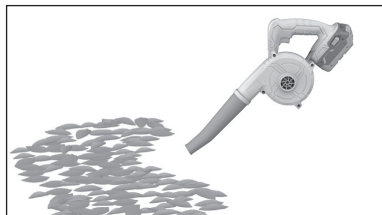

Not to be used as a vacuum device.

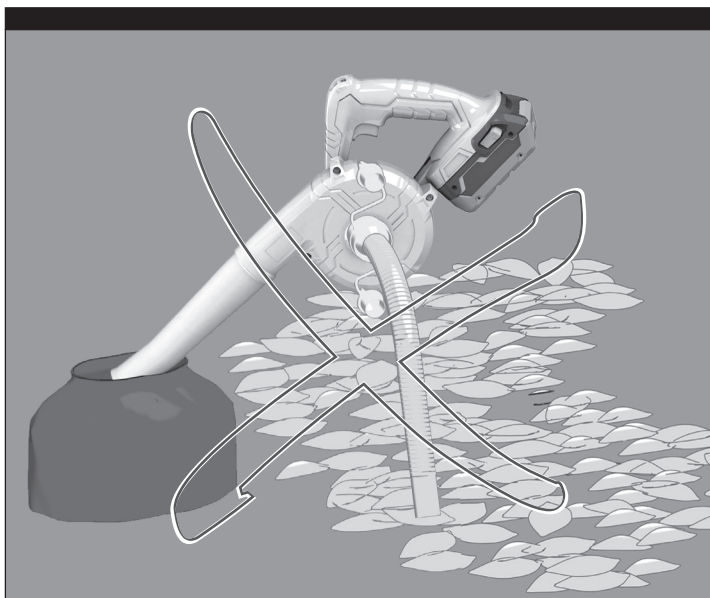

Not to be used for vacuuming liquids.

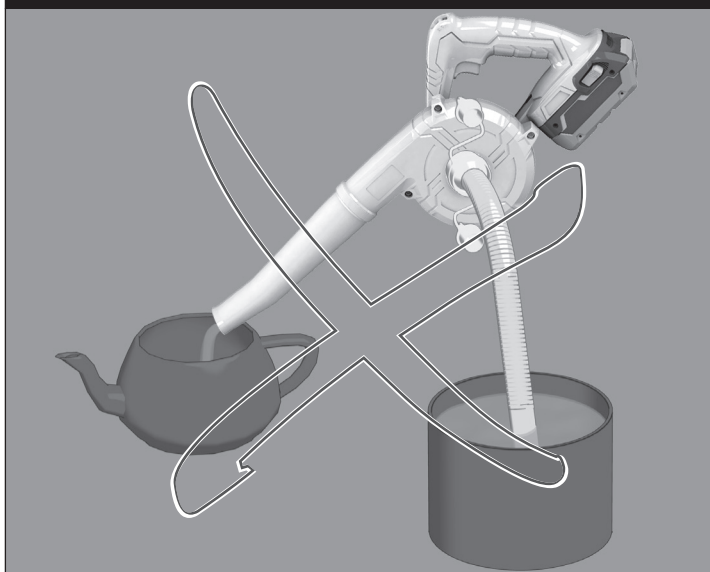

**TECHNICAL DATA****CORDLESS BLOWER****GM18EX2**

Rated voltage	18 V
No-load speed	
level 1	18700 min ⁻¹
level 2	13300 min ⁻¹
level 3	11500 min ⁻¹
Air speed max.	
level 1	200 km/h
level 2	155 km/h
level 3	112 km/h
Air flow rate	
level 1	2.9 m ³ /min
level 2	2.2 m ³ /min
level 3	1.8 m ³ /min
Rated current	16 A
Weight - not including battery pack	1.15 kg
Measured values determined according to EN 50636-2-100 Annex CC.	
A-weighted sound pressure level (at operators ear)	$L_{pA} = 84$ dB(A)
Uncertainty K	2.5 dB(A)
A-weighted sound power level	$L_{WA} + K_{WA} = 94.5$ dB(A)
Uncertainty K	1.74 dB(A)
Wear ear protectors.	
The vibration total values (triaxial vector sum) determined according to EN 50636-2-100 Annex BB:	
Handle Vibration	$a_h = 3.4$ m/s ²
Uncertainty K	1.5 m/s ²

WARNING

The vibration emission level given in this information sheet has been measured in accordance with a standardised test given in EN 50636-2-100 Annex BB and may be used to compare one tool with another. It may be used for a preliminary assessment of exposure.

The declared vibration emission level represents the main applications of the tool. However if the tool is used for different applications, with different accessories or poorly maintained, the vibration emission may differ. This may significantly increase the exposure level over the total working period.

An estimation of the level of exposure to vibration should also take into account the times when the tool is switched off or when it is running but not actually doing the job. This may significantly reduce the exposure level over the total working period. Identify additional safety measures to protect the operator from the effects of vibration such as: maintain the tool and the accessories, keep the hands warm, organisation of work patterns.

BATTERY AND CHARGER

Compatible battery pack (not included)		Compatible charger (not included)
L1815R		AL18G
L1820R	L1860R	AL1218G
L1825R	L1860B	BL1218
L1830R	L1860R-X5	BLK1218
L1840R	L1890R	BL18DP-X5
L1850R		BL18DP2-X5

Use AEG 18V battery and charger only

WARNING! Read all safety warnings and all instructions. Failure to follow the warnings and instructions may result in electric shock, fire and/or serious injury. **Save all warnings and instructions for future reference.**

BLOWER SAFETY WARNINGS

Failure to keep loose clothing or long hair from being drawn into air intake could result in personal injury.

Ensure you have proper footing, especially in case of slanted surfaces.

The blower shall not be used as a vacuum device.

Do not blow hot, flammable or explosive material.

Never allow children, persons with reduced physical, sensory or mental capabilities or lack of experience and knowledge or people unfamiliar with these instructions to use the machine. Local regulations may restrict the age of the operator.

The operator or user is responsible for accidents or hazards occurring to other people or their property.

Never operate the machine while people, especially children or pets, are nearby.

Use the machine only in daylight or good artificial light.

If the product is dropped, suffers heavy impact or begins to vibrate abnormally, immediately stop the product and inspect for damage or identify the cause of the vibration. Any damage should be properly repaired or replaced by an authorised service centre.

Do not touch moving hazardous parts before the product is disconnected from the battery pack and the moving hazardous parts have come to a complete stop.

Repairs should only be carried out by an authorised service centre.

Do not operate the product with defective guard or enclosure or shields.

Wear protective goggles while operating.

To prevent dust irritation the wearing of a face mask is recommended.

Do not operate the machine when barefoot or wearing open sandals, always wear substantial footwear and long trousers.

Failure to keep loose clothing from being drawn into air intake could result in personal injury.

Failure to keep long hair away from the air inlet could result in personal injury.

Always be sure of your footing on slopes.

Never blow debris in the direction of bystanders. Do not operate without tubes in place.

Do not overreach and keep your balance at all times.

Walk, never run.

Keep all cooling air inlets clear of dirt.

Do not modify this blower. Unauthorized modifications may impair the safety of



your product and may result in increased noise and vibration.

Store the appliance only in a dry place.

Remove the battery pack before starting any work on the machine.

Do not dispose of used battery packs in the household refuse or by burning them. AEG Distributors offer to retrieve old batteries to protect our environment.

Do not store the battery pack together with metal objects (short circuit risk).

Only use AEG chargers for charging AEG batteries. Do not use battery packs from other systems.

Battery acid may leak from damaged batteries under extreme load or extreme temperatures. In case of contact with battery acid wash it off immediately with soap and water. In case of eye contact rinse thoroughly for at least 10 minutes and immediately seek medical attention.

ADDITIONAL BATTERY SAFETY WARNINGS

WARNING! To reduce the risk of fire, personal injury, and product damage due to a short circuit, never immerse your tool, battery pack or charger in fluid or allow a fluid to flow inside them. Corrosive or conductive fluids, such as seawater, certain industrial chemicals, and bleach or bleach-containing products, etc., can cause a short circuit.

SPECIFIED CONDITIONS OF USE

The cordless blower may be used as follows:

- Blowing of dirt, dust and leaves.

Do not use this product in any other way as stated for normal use.

BATTERIES

New battery packs reach full loading capacity after 4 - 5 chargings and dischargings. Battery packs which have not been used for some time should be recharged before use.

Temperatures in excess of 50°C (122°F) reduce the performance of the battery pack. Avoid extended exposure to heat or sunshine (risk of overheating).

The contacts of chargers and battery packs must be kept clean.

For an optimum life-time, the battery packs have to be fully charged, after used.

To obtain the longest possible battery life remove the battery pack from the charger once it is fully charged.

For battery pack storage longer than 30 days:

- Store the battery pack where the temperature is below 27°C and away from moisture.
- Store the battery packs in a 30% - 50% charged condition.
- Every six months of storage, charge the pack as normal.

TRANSPORTING LITHIUM BATTERIES

Lithium-ion batteries are subject to the Dangerous Goods Legislation requirements.

Transportation of those batteries has to be done in accordance with local, national and international provisions and regulations.

- The user can transport the batteries by road without further requirements.
- Commercial transport of Lithium-Ion batteries by third parties is subject to Dangerous Goods regulations. Transport preparation and transport are exclusively to be carried out by appropriately trained persons and the process has to be accompanied by corresponding experts.

When transporting batteries:

- Ensure that battery contact terminals are protected and insulated to prevent short circuit.
- Ensure that battery pack is secured against movement within packaging.
- Do not transport batteries that are cracked or leak.

Check with forwarding company for further advice.

BATTERY PACK PROTECTION

The battery pack has overload protection that protects it from being overloaded and helps to ensure long life. Under extreme stress the battery electronics switch off the product automatically. To restart, switch the product off and then on again. If the product does not start up again, the battery pack may have discharged completely. In this case it must be recharged in the battery charger.

STORAGE

When not in use, store the product only in a dry place, out of reach of children.

MAINTENANCE

Check and empty the debris collector frequently.

Replace worn or damaged parts.

Keep all nuts, bolts and screws tight to ensure the product is in safe working condition.

The ventilation slots of the machine must be kept clear at all times.

Use only AEG accessories and AEG spare parts. Should components need to be replaced which have not been described, please contact one of our AEG service agents (see our list of guarantee/service addresses).

If needed, an exploded view of the tool can be ordered. Please state the Article No. as well as the machine type printed on the label and order the drawing at your local service agents or directly at:

Techtronic Industries (Australia) Pty. Ltd.

PO Box 1065

Mount Waverley VIC 3149

Tel. no. 1300 234 797

Australia

Techtronic Industries N.Z. Ltd.

PO Box 12-806

Penrose AUCKLAND 1642

Tel. no. 0800 234 797(0800 AEGPWR)

New Zealand

SYMBOLS



Safety alert



Regulatory Compliance Mark (RCM). Product meets applicable regulatory requirements.



Please read the instructions carefully before starting the machine.



Always wear goggles when using the machine.



Wear ear protectors.



Wear a suitable dust protection mask.



Beware of thrown or flying objects.



Keep all bystanders, especially children and pets, at least 15m away from the operating area.



Do not expose to rain or damp condition.



Remove the battery pack before starting any work on the machine.



Do not dispose of electric tools together with household waste material. Electric tools and electronic equipment that have reached the end of their life must be collected separately and returned to an environmentally compatible recycling facility.

AEG

www.aegpowertools.com.au
www.aegpowertools.co.nz

Techtronic Industries Australia Pty Ltd

31 Gilby Road, Mount Waverley,
VIC, 3149, Australia

Techtronic Industries N.Z. Limited

Unit C, 70 Business Parade South,
Highbrook, Auckland 2013, New Zealand

*AEG is a registered trademark used under
license from AB Electrolux (publ).*