

click



15cm Desk Fan with Clip

USER MANUAL

Model Number: CLF6-BLK

Contents

Important Safety Instructions	3
Product Overview	5
Getting Started	6
Operating Instructions	7
Other Useful Information	8

Important Safety Instructions

Read this manual thoroughly before first use, even if you are familiar with this type of product. The safety precautions enclosed herein reduce the risk of fire, electric shock and injury when correctly adhered to. Make sure you understand all instructions and warnings. **Keep the manual in a safe place for future reference**, along with the completed warranty card, purchase receipt and carton. If you sell or transfer ownership of this product, pass on these instructions to the new owner. **Always follow basic safety precautions and accident prevention measures when using an electrical appliance, including the following:**

Electrical safety and cord handling

- **Voltage:** Make sure your outlet voltage and circuit frequency correspond to the voltage stated on the appliance rating label.
- **Water:** To protect against fire and electric shock, do not immerse the cord, plug or the fan in water or other liquid, or expose the electrical connections to water. Ensure your hands are dry before handling the plug or switching on the fan. Do not use the fan outdoors or on wet surfaces. Protect it from liquid spills.
- **Damage:** Check the power cord regularly for visible damage. If the cord is damaged, it must be replaced by the manufacturer, its authorised service centres or appropriately qualified personnel in order to avoid any hazards.

WARNING! Do not pick up or operate the appliance if the power supply cord, plug or housing is damaged, or after it malfunctions or has been dropped or damaged in any manner. In case of damage, contact our after sales support line for advice.

- **Protect the power cord:**
 - Do not operate the fan with the cord coiled up; always fully unwind.
 - Do not twist or kink the cord or let it touch heated surfaces or sharp edges.
 - Do not allow the cord to hang over the edge of a table or bench.
 - Do not put any stress on the cord where it connects to the product.
 - Never carry the fan by the cord.
- **WARNING! No extension cord, no timer:** Do not use this fan with an extension cord, plug adaptor, external timer or separate remote-control system. In the event of danger, the plug must be quickly and easily accessible.
- **Connection:** To insert the plug, grasp it firmly and guide it into outlet.
- **Disconnection:** Unplug the appliance from the power outlet when it is not in use and before cleaning, servicing, moving or storing the appliance, and before removing a front or rear guard (grille). Grasp the plug and remove it from the outlet, do not pull the cord when disconnecting.
- **RCD:** Unless your home is already fitted with a residual current device (safety switch), we recommend installing an RCD with a rated residual operating current not exceeding 30mA to provide additional safety protection when using electrical appliances. See your electrician for professional advice.

Important Safety Instructions (Cont.)

Usage conditions and restrictions

- **Domestic use only:** This appliance is intended for indoor household use only. It is not suitable for commercial, industrial or outdoor use. Do not use in moving vehicles or boats. Do not use it for anything other than its intended purpose, and only use it as described in this manual. Any other use may cause fire, electric shock or injury.
- **Not a dryer:** Do not use this fan as a dryer.
- **Attachments:** The use of accessory attachments not recommended in this manual may cause hazards.
- **Usage restriction:** This fan is not intended for use by persons (including children) with reduced physical, sensory or mental capabilities, or lack of experience and knowledge, unless they have been given supervision or instruction concerning use of the appliance by a person responsible for their safety.
- **Children:** This fan is not a toy. Supervise children to ensure they do not play with the fan. Close supervision is necessary when any appliance is used by or near children.
- **Unattended:** Do not leave the fan unattended when in use. Always switch it off and unplug when not in use, if left unattended and before cleaning and storing.
- **Location:** Place the fan on a dry, flat, stable surface when operating .
- **Assembly:** Do not operate the fan until fully assembled with all parts.
- **WARNING! DO NOT use the fan in the following areas:**
 - * Near an open flame, a hot burner, oven or other source of high heat.
 - * On a soft surface (such as carpet), or where it may tip over during use.
 - * Outdoors or in areas of high humidity, without suitable ventilation.
 - * In a bathroom or near water-filled baths, swimming pools or washbasins.
 - * Near curtains or in tight corners, to enjoy maximum airflow.
 - * In areas where paint, petrol, etc. is stored and there is a risk of explosion or fire from flammable gases.
- **CAUTION!** Avoid contact with moving parts. Never insert fingers, hands, pencils or any other objects through the grilles when fan is running.
- **CAUTION! Risk of fire:** Make sure nothing is blocking the airflow outlet and air intake grilles. Do not use the fan under a blanket or in poorly ventilated locations.
- **Liability:** We assume no liability for any damages or personal injury caused by misuse of the product and/or failure to follow these instructions.

Product Overview

Parts list

- | | | | | | |
|---|---------------------|---|----------------------|----|---------------|
| 1 | Speed control | 5 | Motor shaft | 9 | Rotary pillar |
| 2 | Motor housing | 6 | Plastic blade | 10 | Rotary joint |
| 3 | Fan handle | 7 | Front guard (grille) | 11 | Clip |
| 4 | Rear guard (grille) | 8 | Tilt adjustment knob | 12 | Plastic base |

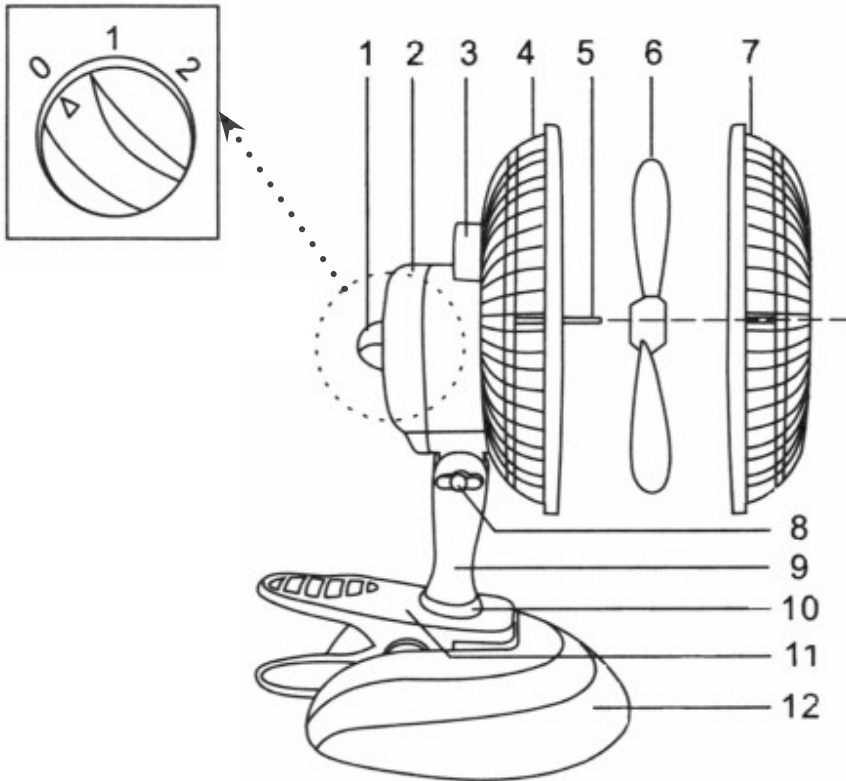

Getting Started

Before first use

- This product has been packaged to protect it against transportation damage. Unpack the appliance and keep the original packaging carton and materials in a safe place. It will help prevent any damage if the product needs to be transported in the future, and you can use it to store the appliance when it is not in use. In the event that the carton is to be disposed of, please recycle all packaging materials where possible.
- Make sure all packaging materials and stickers are removed before first use. Plastic wrapping can be a suffocation hazard for babies and young children, so ensure all packaging materials are out of their reach and disposed of safely.
- Unwind the cord to its full length and inspect it for damage. Do not use the appliance if the appliance or its cord have been damaged or are not working properly. **In case of damage, contact our after sales support line for advice on examination or return of the damaged product.**
- Read the manual to familiarise yourself with the parts and operating principles. Pay particular attention to the safety instructions.

Assembly

This fan can be clipped to the edge of a desk or table, or to the base provided and then used freestanding on the table or desktop. If the fan parts are disassembled, proceed as follows:

- First attach the rotary pillar to the base so it is stable. Open the clip and insert it into the opening on the base, as illustrated (Fig. 1). Close the clip and ensure the fan sits securely on the base. Attach the fan head onto the rotary pillar, as illustrated (Fig. 2). Then tighten the tilt angle adjustment in the desired position.
- Alternatively, open the clip, detach it from the base and clip it securely to the edge of your table or desktop (Fig. 3).

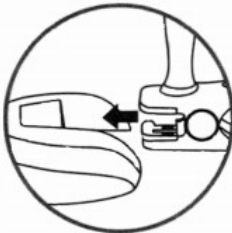

(Fig. 1)

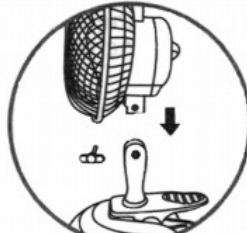

(Fig. 2)

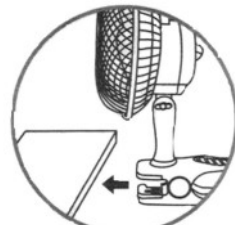

(Fig. 3)

Operating Instructions

Using the fan

- Clip the fan to the base (Fig. 1) and place it on a firm, flat surface for desktop operation. Alternatively, clip it to the edge of your desk or table using the clip (Fig. 3).
- Plug the fan into an appropriate power outlet and switch on power to the outlet.
- Move the speed control to select the desired speed (Fig. 4):
 - 0Off
 - 1Low
 - 2High
- Loosen the tilt angle adjustment knob to tilt the fan vertically (Fig. 5), then tighten the knob again securely.
- The rotary pillar may be manually adjusted 360 degrees to direct the airflow horizontally into all directions. (Fig. 6).

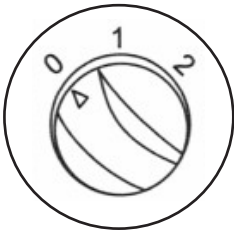

(Fig. 4)

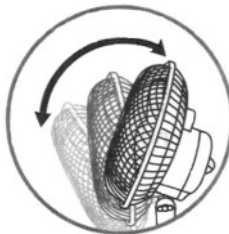

(Fig. 5)



(Fig. 6)

Other Useful Information

Cleaning and maintenance

CAUTION!

Always switch off and disconnect the appliance from the power supply before attempting any maintenance or cleaning the fan.

- **Dusting:** Clean your fan periodically by lightly running a vacuum cleaner nozzle (soft brush) over the front and rear guards to remove any dust or dirt that may have accumulated inside or on the unit. Alternatively, clean the front and rear guards with a soft cloth or soft, thin paper towel.
- **Stubborn stains:** Use a slightly damp and soapy cloth, but not too wet, for stubborn stains. Use caution around the motor housing area. Do not allow the motor or other electrical components to be exposed to water.
- **Service/repair:** The appliance requires little maintenance and contains no user-serviceable parts. Do not attempt to take it apart, repair or modify it. Do not operate the fan if its power cord or plug is damaged, or when it is working abnormally. In case of damage or malfunction, or if the cord is damaged, have the unit repaired by trained personnel only, or contact the after sales support line for advice on repair or replacement.
- **Before calling for service:** Check that your wall outlet is working properly, that the plug is firmly placed in the socket and switched on, and that all required switches are in the ON position.
- **Storage:** When you have finished using the fan at the end of the season, wipe off any dust to maintain it in good working order for the next season. Store the fan in its original box in a safe, dry location, protected from dust.

WARNING: Electric shock hazard!

- Before assembly, cleaning, storage or removing the guard(s), ensure the fan is switched off and disconnected from the power outlet.
- Do not immerse the fan in water or other liquids. Do not allow water to drip on or into the fan motor housing. Do not spray with liquids.
- Never use petrol, solvents, harsh detergents, or abrasive or alkaline cleaners on the fan.

Other Useful Information (Cont.)

Technical specifications

Power	15W, 220-240V~, 50Hz
Power cord	1.5m
Design	Desk Fan with Clip (15cm Blades)
Fan speeds	2 (Low - High)
Dimensions (mm)	200 (D) x 210 (W) x 310 (H)
Weight	740g



CLASS II - DOUBLE INSULATED APPLIANCE

This symbol indicates that the appliance has been designed in such a way that it does not require a safety connection to electrical earth (ground).



The RCM Mark (Regulatory Compliance Mark) indicates that the product complies with the relevant guidelines of the ACMA as well as corresponding government requirements for the safety of electrical devices.

Responsible disposal

- At the end of its working life, make the appliance unserviceable by unplugging it from the power outlet and cutting the power cord.
- Do not throw this appliance out with your household rubbish. Electrical and electronic products contain substances which can have a detrimental effect on the environment and human health if disposed of inappropriately. Observe any local regulations regarding the disposal of electrical consumer goods and dispose of it appropriately for recycling. Contact your local authorities for advice on recycling facilities in your area.

NOTE:

Due to continued product improvement, images and illustrations in this manual may vary slightly from the product purchased. All images in this manual are for reference purposes only. Parts are not necessarily pictured to scale.

This page has been left blank intentionally.

This page has been left blank intentionally.

Warranty returns

Should you for any reason need to return this product for a warranty claim, make sure to include all accessories with the product.

Product does not work?

If you encounter problems with this product, or if it fails to perform to your expectations, make sure to contact our After Sales Support Centre on (AU) 1300 886 649 or (NZ) 0800 836 761 for advice.

Distributed by Tempo (Aust) Pty Ltd ABN 70 106 100 252

PO BOX 6056 Frenchs Forest, Australia NSW 2086

Customer Helpline:

(AU) 1300 886 649 (NZ) 0800 836 761



Email: info@tempo.org

For an electronic copy of this manual, please contact our after sales support centre.

IM Version No: V3.0

Issue: April 2020

AFTER SALES SUPPORT

 (AU) 1300 886 649 (NZ) 0800 836 761 |  info@tempo.org