



MAKE IT EASY
Protector^{AI}

Josh and Jenna show you how
at www.protectoraluminium.com.au



2020V2

BALUSTRADE

INSTALLATION GUIDE

Balustrade must comply with Standard AS/NZ1170.1:2002

Please check with your local Council regarding specific requirements.

Tools Required: Pencil, String-line, Tape Measure, Spirit Level, Drill, Spanners,
Tek Gun/Drill, Angle Grinder/Hacksaw

GETTING STARTED

Calculate the number of panels and posts required.

Mark the position of each flanged post.

Panels fixed to a wall will need a Top Rail Panel Bracket.

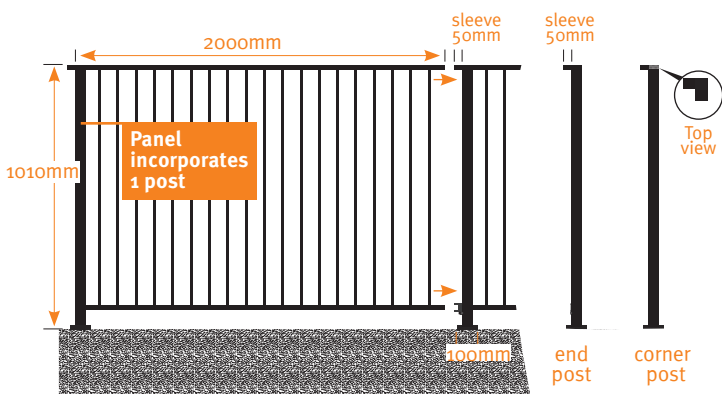

ADJUST TO FIT

1. Mark any special lengths including 50mm space for the sleeve and panel bracket. Cut the rails to the required length
2. When fitting a corner post it may be necessary to cut the fixed post off the next panel.

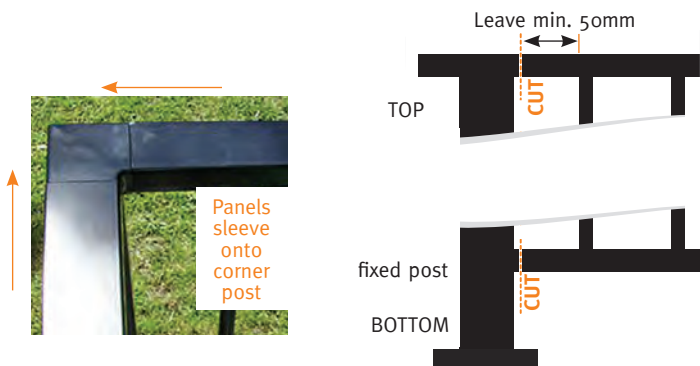

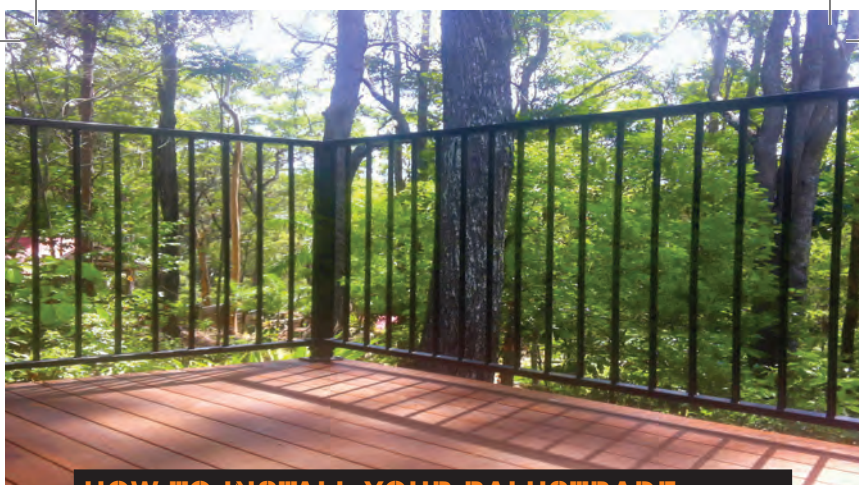

HOW TO INSTALL YOUR BALUSTRADE

1. Starting at one end, install the first panel. Fix securely to a wall (A), or fit an End Post (B) if required.
2. Fit the next panel by inserting the sleeve into the Top Capping (B). Fit the Panel Bracket to the bottom capping before fixing in place. (C). Fix in place using Tek Screws or 4.8mm aluminium rivets. Use a minimum of 3 fixings per rail. Repeat with other panels, ensuring panels are straight, level and fitted together correctly.
3. Secure all posts to floor. For concrete, secure with stainless steel dyna-bolts or chem-set studs (Pic D). Secure on timber decks (Pic E) with 8mm or 10mm coach screws into joists, or bolts and nuts if securing from underneath. Fit chocks under the deck and use large flat washers between nuts and timber. Securely tighten and check for rigidity.
4. Fix corner and end posts as required.

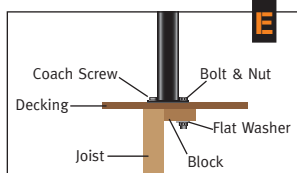
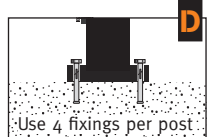
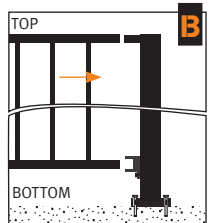
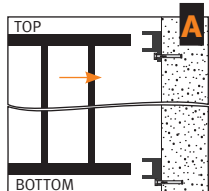

BALUSTRADE SPECIFICATIONS

Standard Panels – 2000mm wide (including fixed post) x 1010mm high

Corner Posts – 50x50x1010mm flanged bottom – sleeved top (90°)

End Posts – 50x50x1010mm flanged bottom – sleeved top (1-way)

Top Rail Panel Bracket

50x25 single lug (2-hole)



Bottom Rail Panel Bracket

38x25 single lug (2-hole)



CUSTOM SERVICE AVAILABLE



**SPECIAL
ORDERS**

Any size, any angle, any colour, visit Bunnings Warehouse Special Orders desk for more information.



9 338797 020811