

## 3M CANTILEVER UMBRELLA ASSEMBLY INSTRUCTIONS

### PART LIST

Lower cross bar

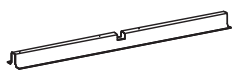

A x 1PC

Upper cross bar

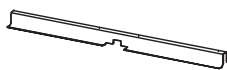

B x 1PC

Lower Pole

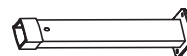

C x 1PC

Rotational Base



D x 1PC

Umbrella frame and canopy

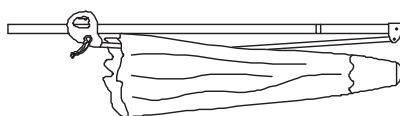

E x 1PC

Base Cover

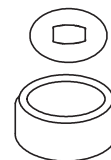

Screw M8x16



G x 8PCS

Washer M8



I x 8PCS

## ASSEMBLY INSTRUCTIONS

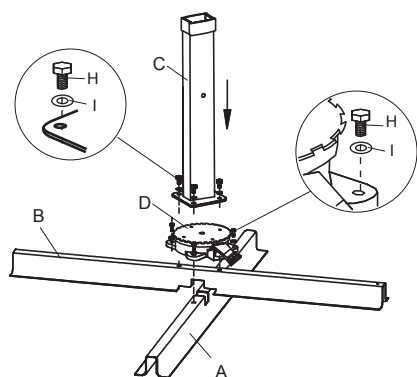

**Important:**  
Fully tighten all screws  
at this stage.

### Step 1

Use screw (H), washer (I) to fix the rotational base (D) to the cross bar (A),(B), then use screw (H), washer (I) to fix the lower Pole (C) to the rotational base (D)

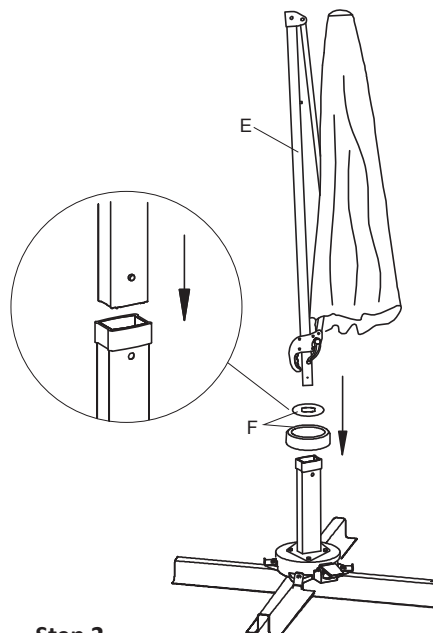

### Step 2

Insert the base cover (F) over the lower pole (C) to cover the rotational base (D). Then insert the frame and canopy (E) into the lower base. Move the assembled umbrella to your desired location and weigh down with four concrete pavers. Your umbrella is now ready for use.

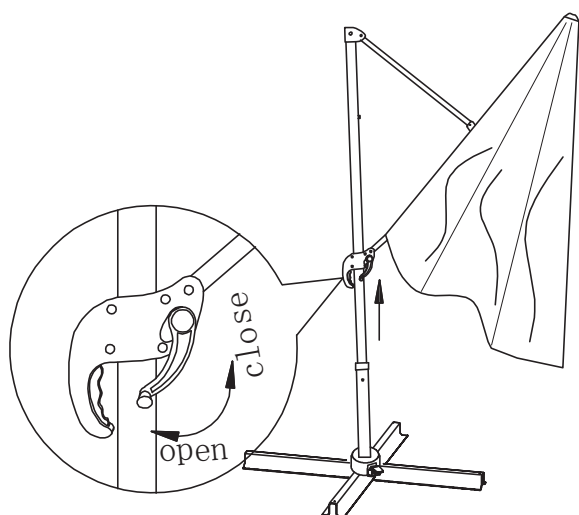

### Step 3

To open your umbrella, squeeze the handle and lift it up towards the top of the umbrella pole. Release the handle to lock it into position. Wind the crank clockwise until the canopy is fully open. Do the reverse to close your umbrella again

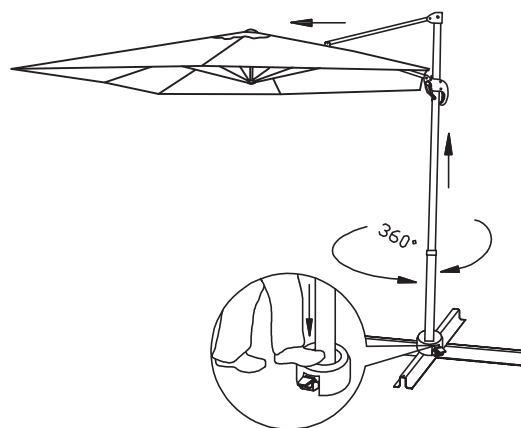

### Step 4

To rotate your umbrella, step on the foot pedal and rotate the frame and canopy to your desired position.