

Spekline

Sink Mixer

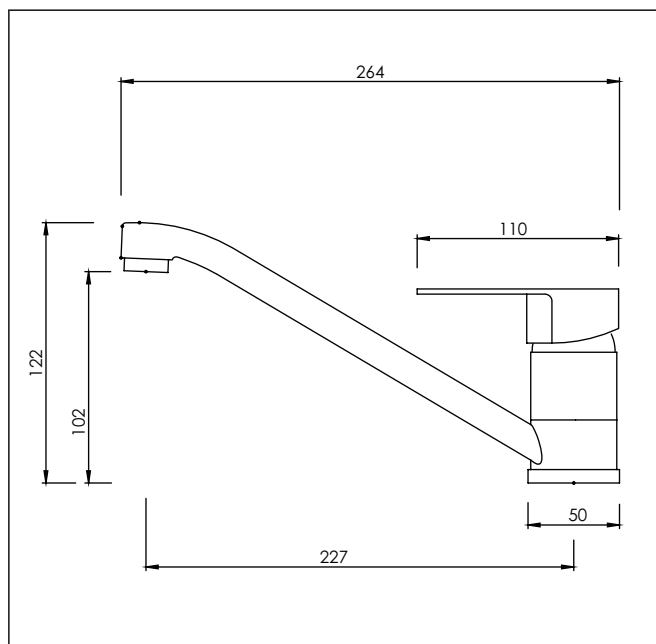

Code: SK SM
SKU: 207869

Finish: Chrome

Spout: Swivel 360°

Water Inlet: Stainless Steel Inlet Hoses:

Hot:
Size: M10 x 1/2" BSP

Cold:
Size: M10 x 1/2" BSP

Water Outlet: M24 ring with flow guide fitted and PCA supplied

Dress Ring supplied with O-ring seal

Installation Hole Diameter: Minimum: 33mm
Maximum: 42mm

Mounting Hardware: Stud: 2 x 6mm
Nut: 2 x 9mm A/F
Horseshoe Washer

Cartridge: 40k Flat base

Flow: Supplied flow guide fitted for max flow at low pressure
8 l/min PCA supplied for regulated flow with mains pressure system
Max hot @ 35 kPa = 6.1 l/min

Suitable for pressure range

Recommended Operational Pressure Range: 50 - 600 kPa
Maximum Operating Temp: 80°C Never to Exceed: 1000 kPa

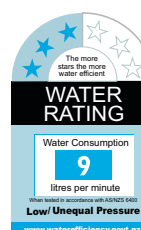

KIWI OWNED COMPANY

NZ • DESIGNED
• ASSEMBLED
• TESTED

Aquatica NZ Limited

9 Saunders Place,
Avondale, Auckland.
Tel: 09-828 2068,
Fax: 09-828 2069
Email: info@aquatica.co.nz
or visit our website:
www.aquatica.co.nz

© copyright Aquatica 2019

Please note: Specifications are subject to change without notice. It is the responsibility of the installer to check the measurements of the physical product before installation