

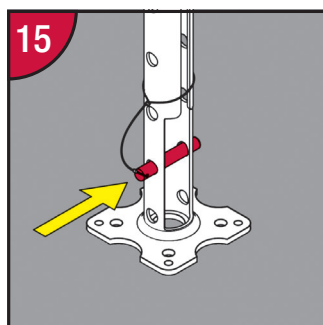

QUICK START GUIDE

FOR OPERATION WITH GORILLA UNI-PROP TEMPORARY SUPPORT

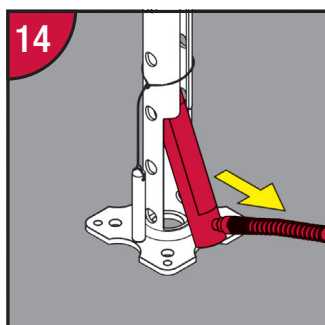
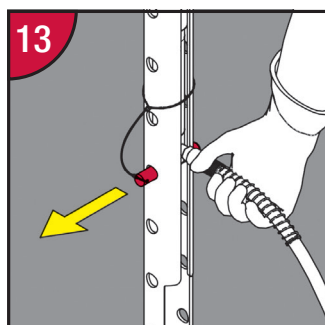
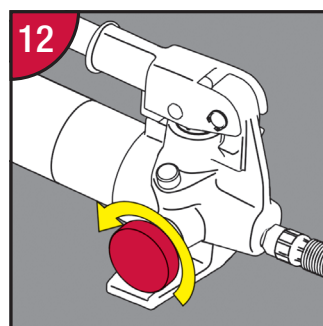
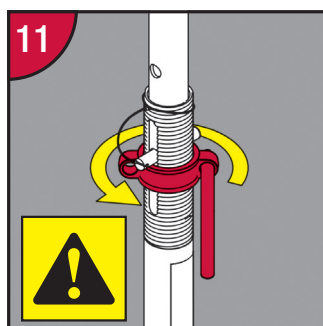
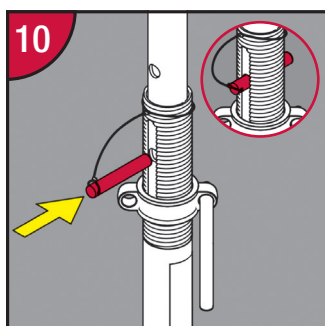
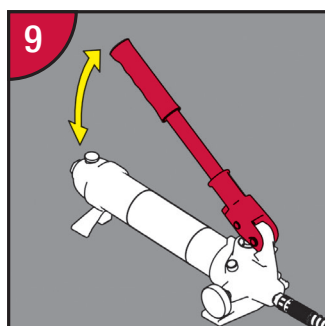
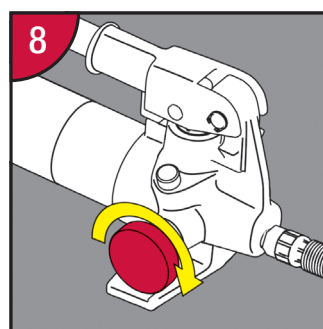
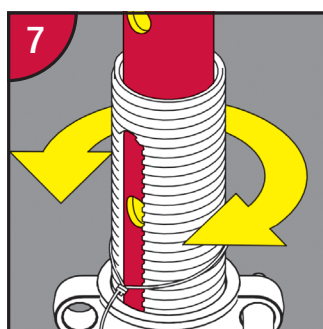
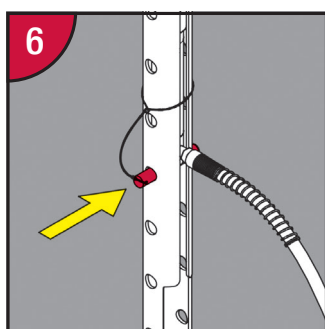
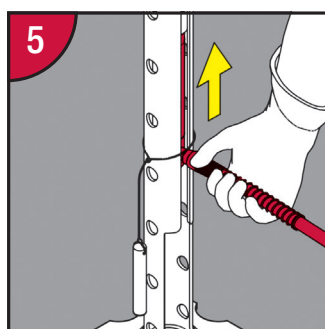
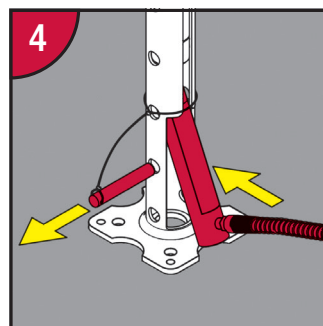
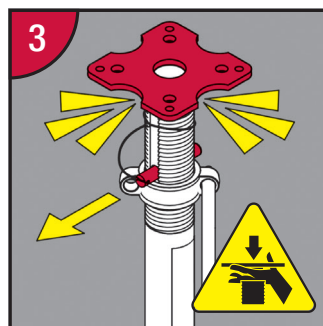
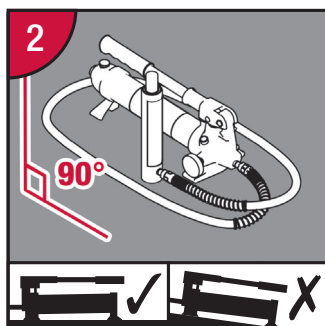
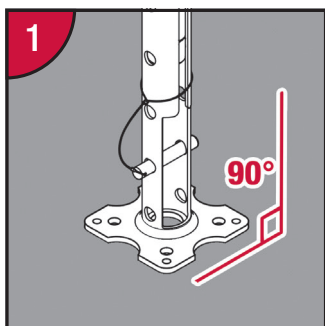

QUICK START GUIDE



FOR OPERATION WITH GORILLA UNI-PROP TEMPORARY SUPPORT

GORILLALADDERS.COM.AU



SAFE WORKING LOADS HYDRAULIC OPERATION

AUSTRALIA & NEW ZEALAND - SWL AS 3610-95

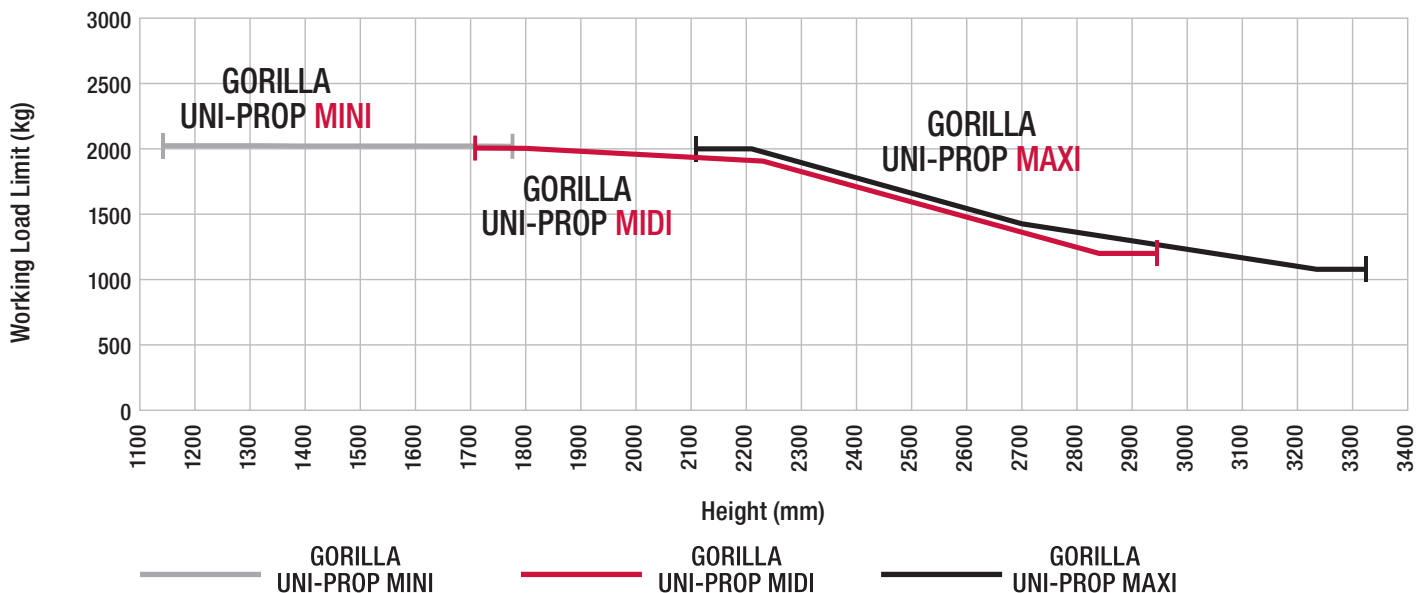

WARNING: NEVER EXCEED SAFE WORKING LOADS

- Safe Working Loads have been derived from load testing to AS3610-95.
- Convert kg to kN: 10kg = 0.09807kN. e.g. 100kg = 0.9807kN, 1000kg = 9.807kN, 5000kg = 49.04kN.



SAFE WORKING LOADS MECHANICAL OPERATION

AUSTRALIA & NEW ZEALAND - SWL AS 3610-95

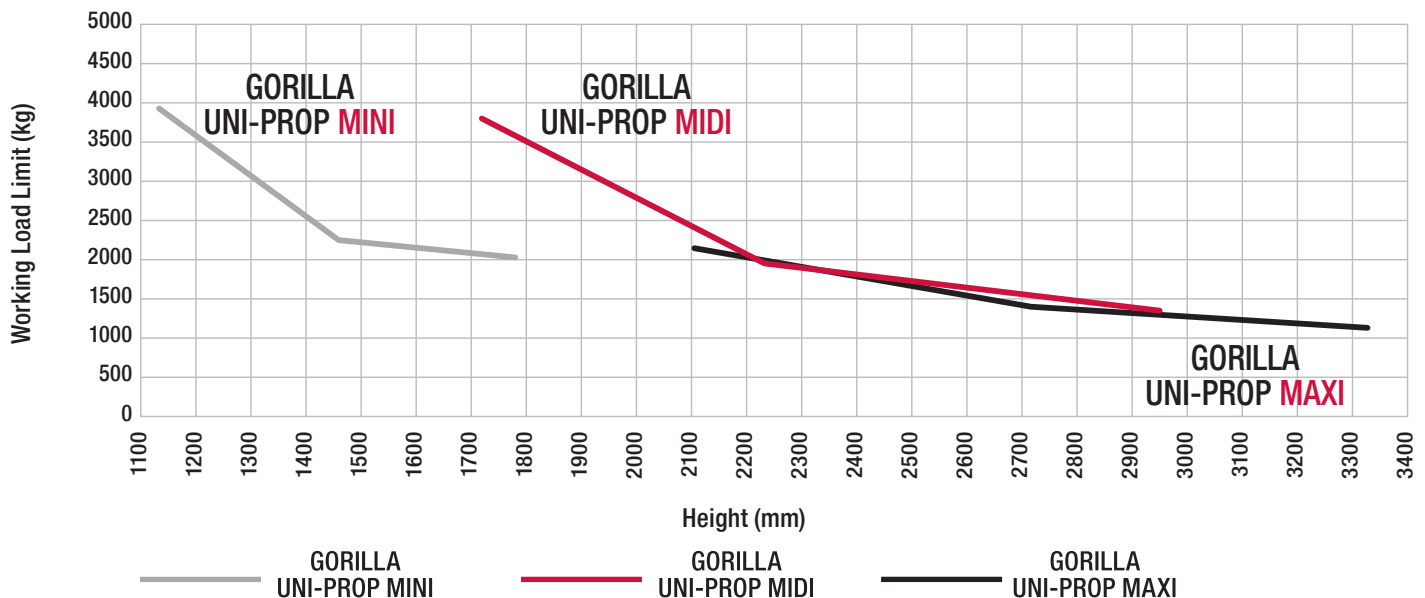

WARNING: NEVER EXCEED SAFE WORKING LOADS

- Safe Working Loads have been derived from load testing to AS3610-95.
- Convert kg to kN: 10kg = 0.09807kN. e.g. 100kg = 0.9807kN, 1000kg = 9.807kN, 5000kg = 49.04kN.