

RYOBI®
EXPAND-IT™
ATTACHMENTS

ALT05

ORIGINAL INSTRUCTIONS

Line Trimmer Attachment



Important!

It is essential that you read the instructions in this manual before assembling, operating and maintaining the product.

Subject to technical modification.

Safety, performance, and dependability have been given top priority in the design of your line trimmer attachment.

INTENDED USE

The line trimmer attachment is approved for use with RLT254CDSO, RLT254SDSO, RBC254SESO, and RBC254SBSO models driven by the RPH254A powerhead. It is intended to be used only by adults who have read and understood the instructions and warnings in the attachment and powerhead manuals, and who can be considered responsible for their actions.

The product is only intended for use outdoors in a well-ventilated area. For safety reasons, the product must be adequately controlled by a two-handed operation.

The product is intended for cutting long grass, pulpy weed, and similar vegetation at or about ground level. The cutting plane should be approximately parallel to the ground surface. The product should not be used to cut or trim hedges, bushes, or other vegetation where the cutting plane is not parallel to the ground surface.

Do not use the product for any other purpose.

⚠ WARNING

When using the product, the safety rules must be followed. For your own safety and that of bystanders, read these instructions before operating the product. Keep the instructions safe for later use.

GENERAL SAFETY WARNINGS

- For safe operation, read and understand all instructions before using the product. Follow all safety instructions. Failure to follow all safety instructions listed below, can result in serious personal injury.
- Never start or run the engine in a closed or poorly ventilated area; breathing exhaust fumes can kill.
- Do not touch area around the silencer or cylinder of the product, these parts get hot from operation.
- Always stop the engine and allow it to cool down before making any adjustments.
- Do not smoke when mixing fuel or filling fuel tank.
- Mix and store fuel in a container approved for fuel.
- Mix fuel outdoors where there are no sparks or flames. Wipe up any fuel spillage. Move 9 m away from refuelling site before starting engine.
- Stop the engine and allow to cool down before refuelling or storing the product.
- Allow the engine to cool down; empty the fuel tank and oil tank (if applicable), and secure the product from moving before transporting in a vehicle.

⚠ WARNING

When the throttle trigger is released and the engine is running at idle speed, the cutting attachment must not move. If it does continue to move, there is risk of severe injury to the operator. Do not use the product. Bring the product to an authorised service centre for professional adjustment.

ADDITIONAL SAFETY WARNINGS

- Some regions have regulations that restrict the use of the product. Check with your local authority for advice.
- Never allow children or people unfamiliar with the instructions to use the product.
- Avoid using the product in bad weather especially if there is a risk of lightning.
- Do not operate in poor lighting. The operator needs clear unrestricted vision to identify potential hazards.
- Keep bystanders, children, and pets 15 m away from the product while in use. Stop the product if anyone enters the area.
- Avoid using on wet grass.
- Do not walk backwards when using the product.
- Keep firm footing and balance at all times. Do not overreach. Overreaching can result in loss of balance or exposure to hot surfaces. Always be sure of your footing on slopes. Walk, never run.
- Beware of objects thrown by the cutting means. Clear debris like small stones, gravel and other foreign objects from the work area before starting operation. Wires or string may become entangled with the cutting means.
- Wear full eye and hearing protection while operating the product. If working in an area where there is a risk of falling objects, head protection must be worn.
- Wear heavy, long trousers, non-slip protective footwear and gloves. Do not wear loose fitting clothing, short trousers, jewellery of any kind, or use with bare feet.
- Secure long hair so it is above shoulder level to prevent entanglement in any moving parts.
- Use of hearing protection reduces the ability to hear warnings (shouts or alarms). The operator must pay extra attention to what is going on in the working area.
- Operating similar tools nearby increases both the risk of hearing injury and the potential for other persons to enter your working area.
- Do not operate the product when you are tired, ill, or under the influence of alcohol, drugs, or medication.
- Keep all parts of your body away from any moving part.
- Keep the cutting head attachment below waist level.
- Never operate the product with damaged guards or without guards in place. Ensure the correct guards are fitted particularly.
- Keep hands and feet away from the cutting means at all times and especially when the product is running.

WARNING

If the product is dropped, suffers heavy impact or begins to vibrate abnormally, immediately stop the product and inspect for damage or identify the cause of the vibration. Any damage should be properly repaired or replaced by an authorised service centre.

LINE TRIMMER SAFETY WARNINGS

- Do not fit a metal replacement line.
- Beware, the cutting elements continue to rotate after the motor is switched off.
- Turn off the engine. Make sure all moving parts have come to a complete stop:
- Turn off the product and disconnect from the power supply:
 - before servicing
 - before clearing a blockage
 - before checking, cleaning, and working on the product
 - before changing accessories
 - before leaving the product unattended
 - after striking a foreign object
 - whenever performing maintenance
 - whenever the product starts to vibrate abnormally
- The small blade fitted to the safety guard is designed to trim the new extended line to the correct length for safe and optimum performance. It is very sharp, do not touch it particularly when cleaning the product.
- Always ensure that ventilation openings are kept clear of debris.
- Before use and after any impact, check that there are no damaged parts. A defective switch or any part that is damaged should be properly repaired or replaced by an authorised service centre.
- Do not modify the product in any way, this may increase the risk of injury to yourself or others.
- Use only the manufacturer's replacement cutting line.
- Do not use any other cutting attachment.
- Immediately switch off and disconnect from the power supply in the event of accident or breakdown. Do not operate the product again until it has been fully checked by an authorised service centre.

TRANSPORTATION AND STORAGE

- Stop the engine and allow it to cool down before storing or transporting.
- Clean all foreign material from the product.
- Drain all fuel from tank into a container approved for petrol. Remember to properly replace and tighten the fuel cap.
- Run the engine until it stops, this will remove all fuel that could become stale and leave varnish and gum in the fuel system.
- Store the product in a cool, dry, and well-ventilated place that is inaccessible to children. Keep away from

corrosive agents such as garden chemicals and de-icing salts.

- Do not store outdoors.
- When transporting the product in a vehicle, secure it against movement or falling to prevent injury to persons or damage to the product.
- Never carry or transport the product while the engine is running.
- Abide by all government and local regulations for the safety storage and handling of petrol.

SHORT TERM (LESS THAN ONE MONTH)

- Stop the engine and allow it to cool down before storing.
- Clean all foreign material from the product.
- Store the product in a cool, dry, and well-ventilated place that is inaccessible to children.
- Keep away from corrosive agents such as garden chemicals and de-icing salts.
- Do not store outdoors.

MAINTENANCE

WARNING

Use only original manufacturer's replacement parts, accessories and attachments. Failure to do so can cause possible injury, can contribute to poor performance, and may void your warranty.

WARNING

Servicing requires extreme care and knowledge and should be performed only by a qualified service technician. For service, bring the product to the nearest authorised service centre for repair. When servicing, use only original replacement parts.

- Turn off, disconnect from the power supply (if applicable), and make sure all moving parts have come to a complete stop before conducting any maintenance or cleaning work.
- You may make adjustments and repairs described in this manual. For other repairs, contact the authorised service agent.
- For the replacement line, use only nylon filament line of the diameter described in the specifications table of this manual.
- After each use, clean the product with a soft, dry cloth. Any part that is damaged should be properly repaired or replaced by an authorised service centre.
- Check all nuts, bolts and screws at frequent intervals for proper tightness to ensure the product is in safe working condition.
- Bring the product to an authorised service centre to replace damaged or unreadable labels.

RESIDUAL RISKS

Even when the product is used as prescribed, it is still impossible to completely eliminate certain residual risk factors. The following hazards may arise during use, and the operator should pay special attention to avoid the following:

- injury caused by vibration
 - Hold the product by designated handles and restrict working time and exposure.
- injury caused by exposure to noise
 - Wear hearing protection and limit exposure.
- injury caused by flying debris
 - Wear eye protection at all times.

RISK REDUCTION

It has been reported that vibrations from hand-held tools may contribute to a condition called Raynaud's Syndrome in certain individuals. Symptoms may include tingling, numbness and blanching of the fingers, usually apparent upon exposure to cold. Hereditary factors, exposure to cold and dampness, diet, smoking and work practices are all thought to contribute to the development of these symptoms. There are measures that can be taken by the operator to possibly reduce the effects of vibration:

- Keep your body warm in cold weather. When operating the product, wear gloves to keep the hands and wrists warm. It is reported that cold weather is a major factor contributing to Raynaud's Syndrome.
- After each period of operation, exercise to increase blood circulation.
- Take frequent work breaks. Limit the amount of exposure per day.

If you experience any of the symptoms of this condition, immediately discontinue use and see your physician.

⚠ WARNING

Injuries may be caused, or aggravated, by prolonged use of a tool. When using any tool for prolonged periods, ensure you take regular breaks.

WHAT'S IN THE BOX

- Trimmer attachment x 1
- Trimmer guard x 1
- Wrench x 1
- Manual x 1

SYMBOLS ON THE PRODUCT



Safety alert



Read and understand all instructions before operating the product, follow all warnings and safety instructions.



Wear eye, ear, and head protection.



Wear non-slip safety footwear when using the product.



Wear non-slip, heavy-duty gloves.



Beware of thrown or flying objects. Keep all bystanders, especially children and pets, at least 15 m away from the operating area.



Do not expose to rain or damp condition.



Do not use metal blade(s) on the product.



Keep hands away from blades.



Rotational direction and maximum speed of the shaft for the cutting attachment.



Guaranteed sound power level (tested in RLT254SDSO model)



Waste electrical products should not be disposed of with household waste. Please recycle where facilities exist. Check with your local authority or retailer for recycling advice.

SYMBOLS IN THIS MANUAL



Parts or accessories sold separately



Note



Warning

The following signal words and meanings are intended to explain the levels of risk associated with this product.

⚠ DANGER

Indicates an imminently hazardous situation, which, if not avoided, will result in death or serious injury.

⚠ WARNING

Indicates a potentially hazardous situation, which, if not avoided, could result in death or serious injury.

⚠ CAUTION

Indicates a potentially hazardous situation, which, if not avoided, may result in minor or moderate injury.

CAUTION

Without safety alert symbol

Indicates a situation that may result in property damage.

ASSEMBLY

UNPACKING

This product requires assembly.

- Carefully remove the product and any accessories from the box. Make sure that all items listed in the packing list are included.
- Inspect the product carefully to make sure no breakage or damage occurred during shipping.
- Do not discard the packing material until you have carefully inspected and satisfactorily operated the product.

WARNING

If any parts are damaged or missing, do not operate the product until the parts are replaced. Failure to heed this warning could result in serious personal injury.

WARNING

Do not attempt to modify the product or create accessories not recommended for use with the product. Any such alteration or modification is misuse and could result in a hazardous condition leading to possible serious personal injury.

WARNING

Never attach or adjust any attachment while the power head is running. Failure to stop the engine may cause serious personal injury.

WARNING

Be certain all knobs and fasteners are fully tightened before operating the product. Check it periodically for tightness during use to avoid serious injury.

ATTACHING THE GRASS DEFLECTOR

- Insert the tab on the mounting bracket in the slot on the grass deflector.
- Insert the screw into the grass deflector.
- Tighten the screw securely.

ATTACHING THE POWER HEAD TO THE TRIMMER ATTACHMENT

WARNING

Never attach or adjust any attachment while the power head is running. Failure to stop the engine may cause serious personal injury.

- The trimmer attachment connects to the power head by means of a coupler device.
- Loosen the knob on the coupler of the power head shaft

and remove the end cap from the attachment.

- Push in the button located on the attachment shaft.
- Align the button with the guide recess on the power head coupler and slide the two shafts together.
- Rotate the attachment shaft until the button locks into the positioning hole.

NOTE: If the button does not release completely in the positioning hole, the shafts are not locked into place. Slightly rotate from side to side until the button is locked into place.

- Tighten the knob securely.

REMOVING THE ATTACHMENT FROM THE POWER HEAD

- Loosen the knob.
- Push in the button and twist the shafts to remove and separate the ends.

ATTACHING THE HANGER CAP

To use the hanger cap, push in the button and place the hanger cap over the lower end of the attachment. Slightly rotate the cap from side to side until the button locks into place.

NOTE: The secondary hole in the attachment shaft can be used for hanging purposes as well.

UNPACKING

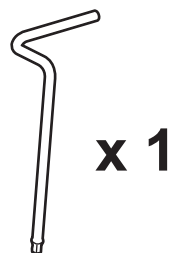
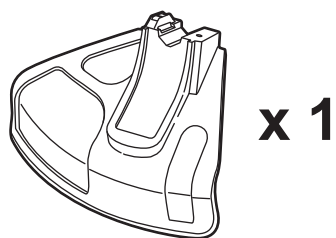
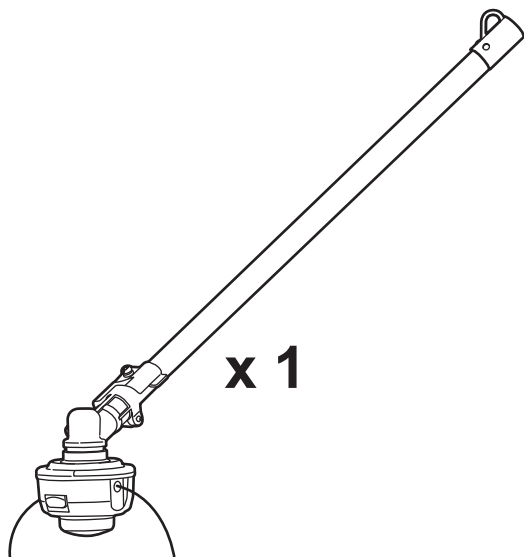

KNOW YOUR PRODUCT

1. Trimmer guard
2. Cut-off blade
3. Upper housing
4. Spool
5. Bump knob
6. Lower housing
7. Cutting line

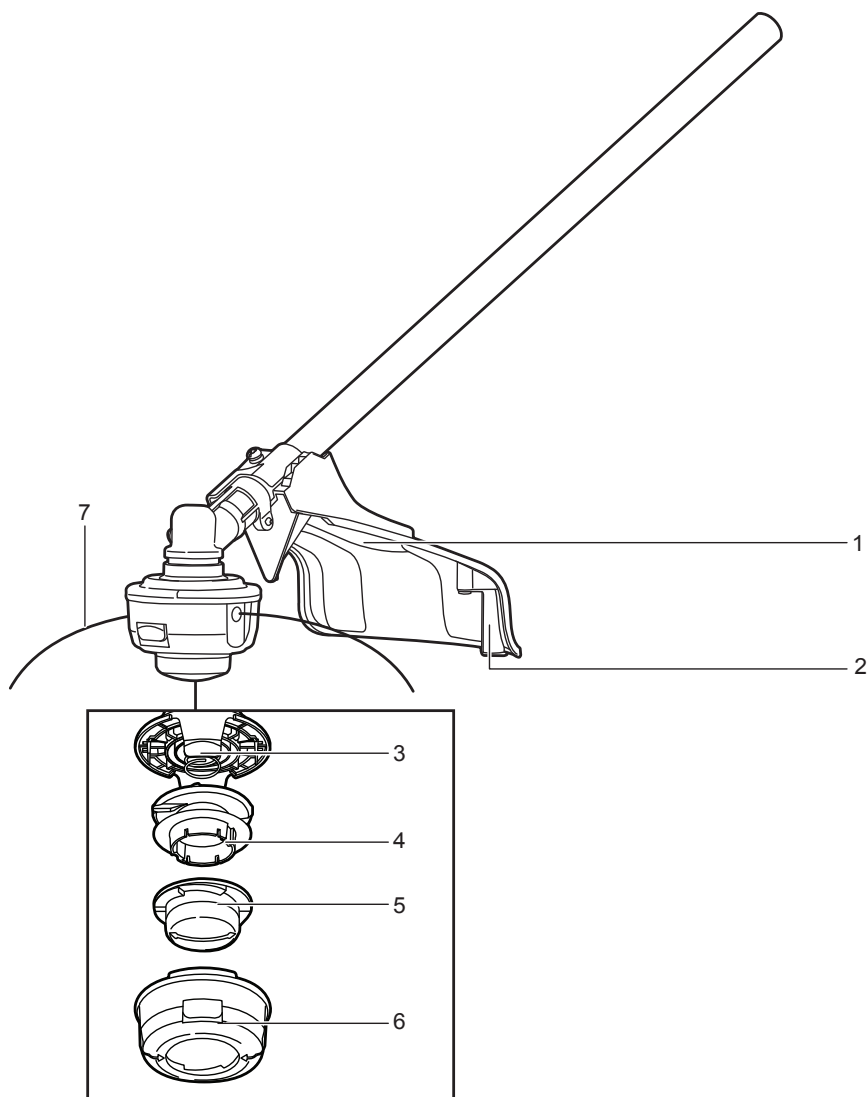

GETTING STARTED

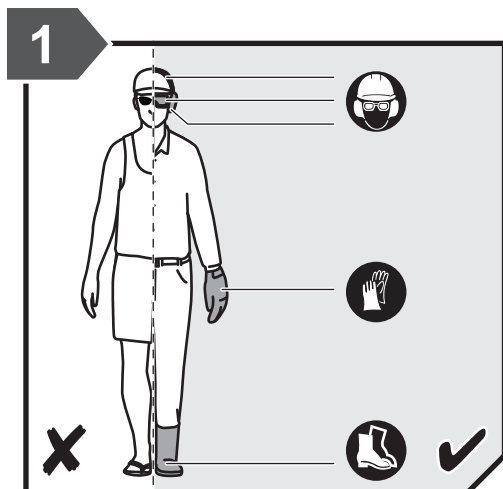

Always wear safety goggles or safety glasses with side shields when operating the product. Failure to do so could result in objects being thrown into your eyes resulting in possible serious injury. When handling the trimmer assembly, wear non-slip, heavy-duty protective gloves. Wear non-skid, protective footwear that will protect your feet and improve your footing on slippery surfaces.

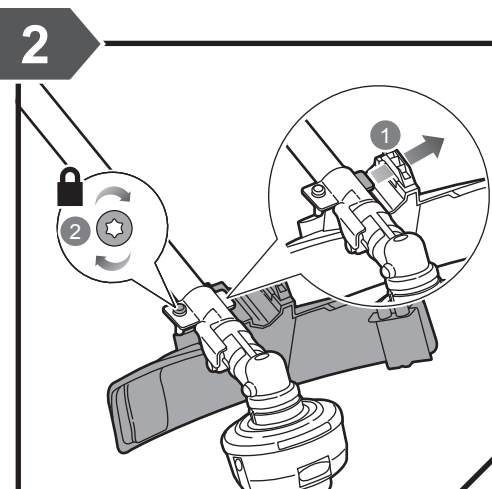

Attach the grass deflector.

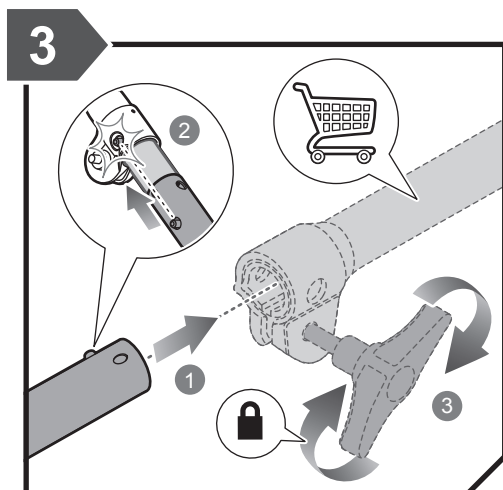

Attach the powerhead to the trimmer attachment.

OVERVIEW

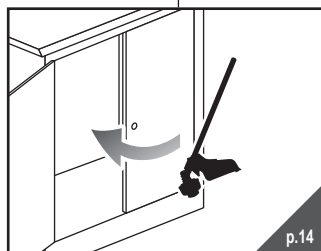
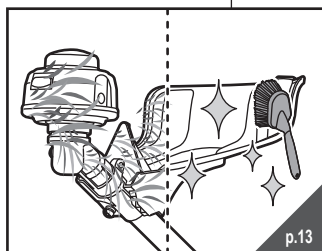
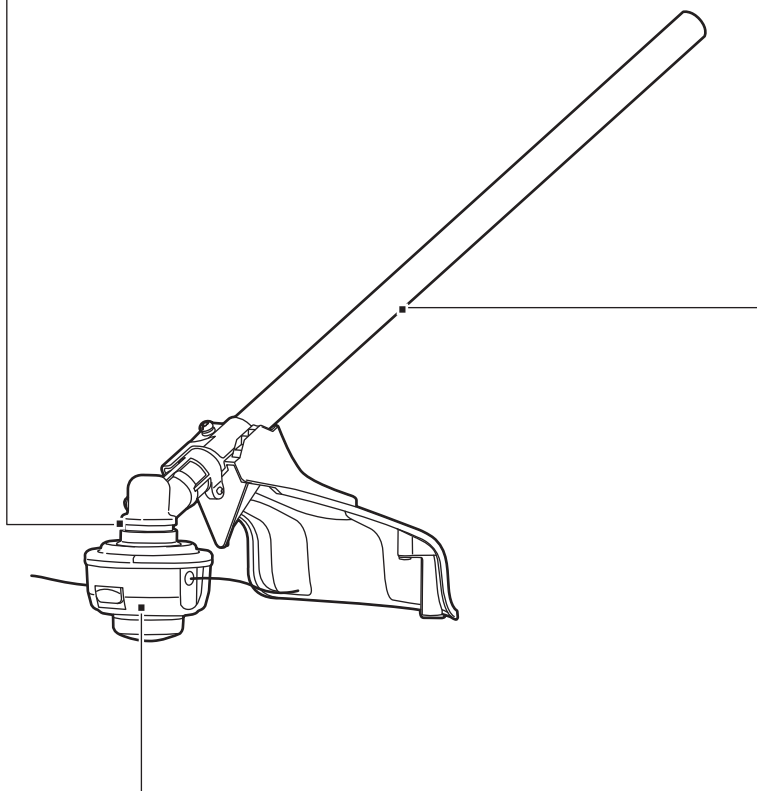
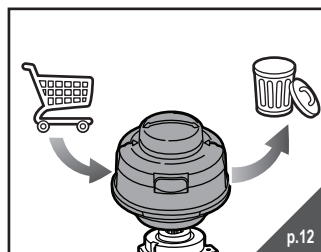
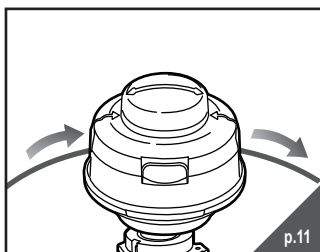
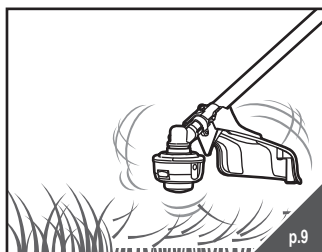

OPERATION



OPERATING THE TRIMMER

NOTE: Hold the product with the right hand on the rear handle and the left hand on the front handle.

WARNING: Do not cut in a dangerous cutting area. Avoid trees and shrubs. Tree bark, wood mouldings, cladding, and fence posts can easily be damaged by the line.

WARNING: Exercise extreme caution when using the product.

Tap the knob on the ground to advance the line. The line advances each time the head is tapped. Do not hold the knob on the ground.

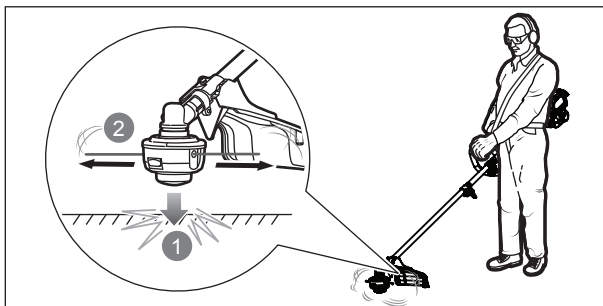
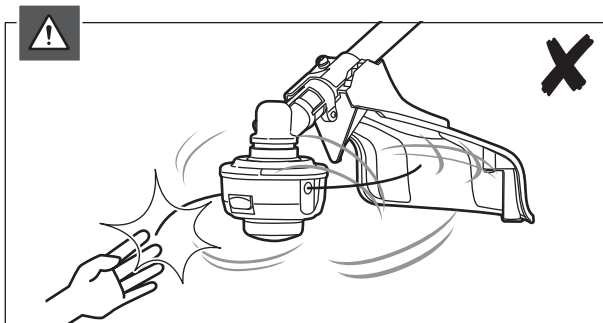
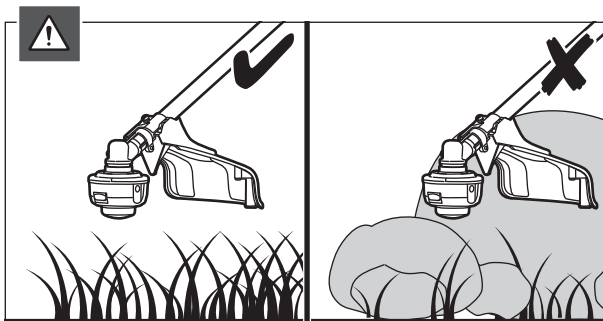
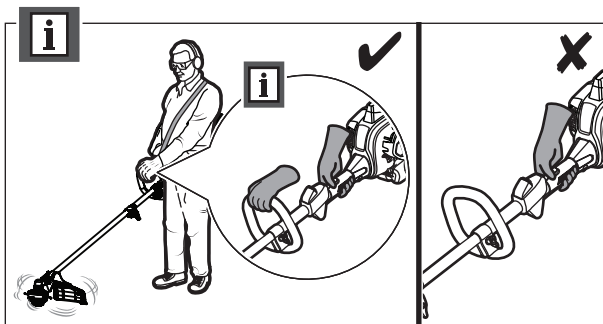

OPERATION

NOTE: The line trimming cut-off blade on the grass deflector will cut the line to the correct length.

NOTE: The small blade fitted to the cutting attachment guard is designed to trim the new extended line to the correct length for safe and optimum performance. It is very sharp; do not touch it, particularly when cleaning the product.

NOTE: Cut tall grass from the top down. This will prevent grass from wrapping around the shaft housing and bump head, which may cause damage from overheating.

NOTE: For cutting ease and safety, cut the grass from the right side to the left side.

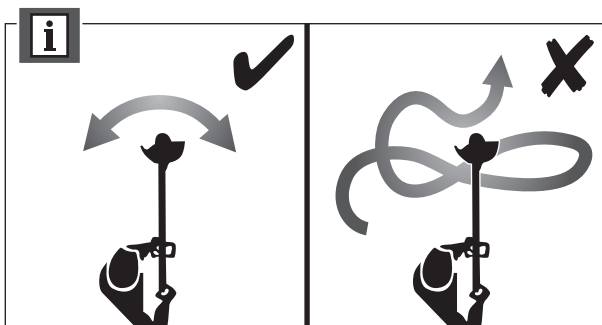
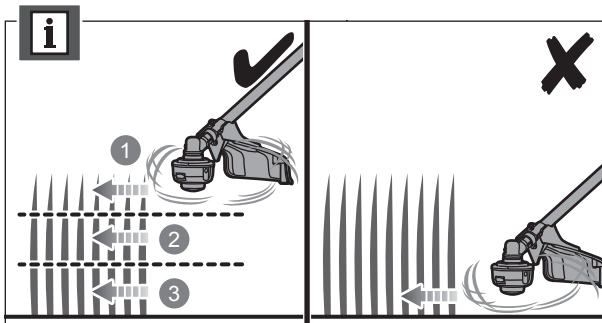
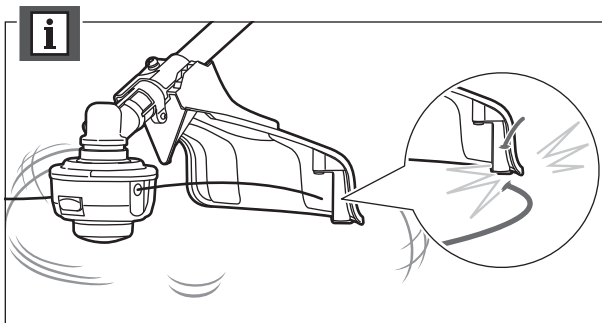

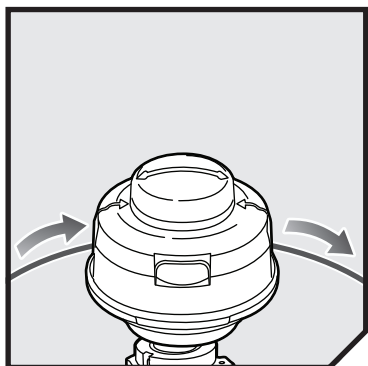

REPLACING THE LINE

1. Rotate the bump knob on the trimmer head until the line on the centre of the bump knob aligns with arrows on top of trimmer head.
2. Use a 2.4 mm diameter monofilament string. Cut one piece of string approximately 5.4 m in length. Insert one end of the line located on the side of the trimmer head and push until line comes out through the eyelet on the other side. Continue to push string through the string head until the middle section of the string is inside the string head.
3. Ensure there is equal lengths of line on either side of the trimmer head (max. 2.7 m per side). Rotate the bump knob on the trimmer head to wind the line.

NOTE: Wind the line until approximately 20 cm remains protruding from the trimmer head.

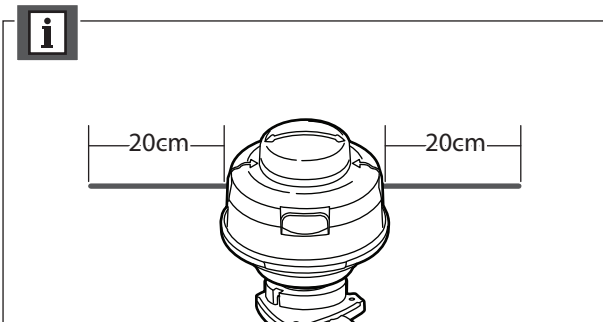
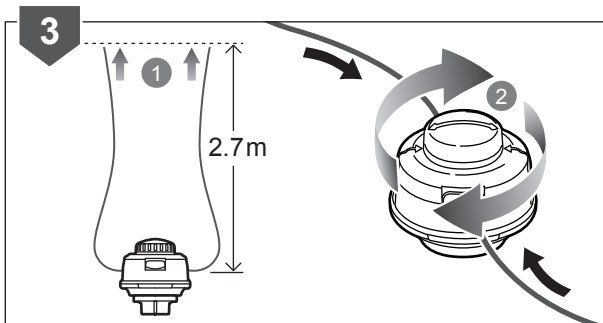
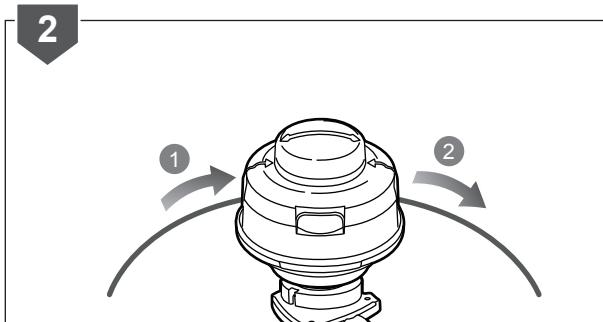
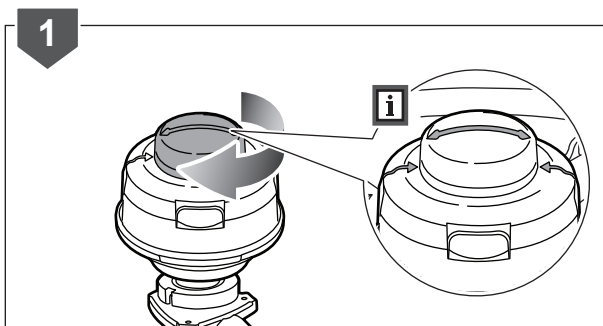

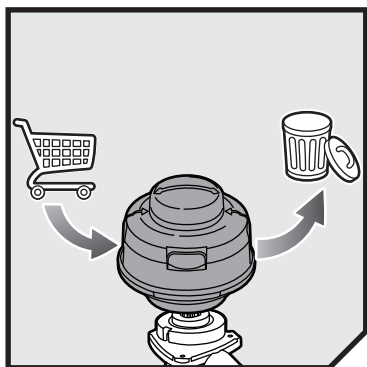

REPLACING THE STRING HEAD

1. Insert the wrench through the hole in the upper flange washer and the hole in the gear head, then turn clockwise to remove the old string head.
2. Install the new string head, align the nut in the string head to the connector shaft of the gear box and turn the string head counterclockwise by hand to tighten.

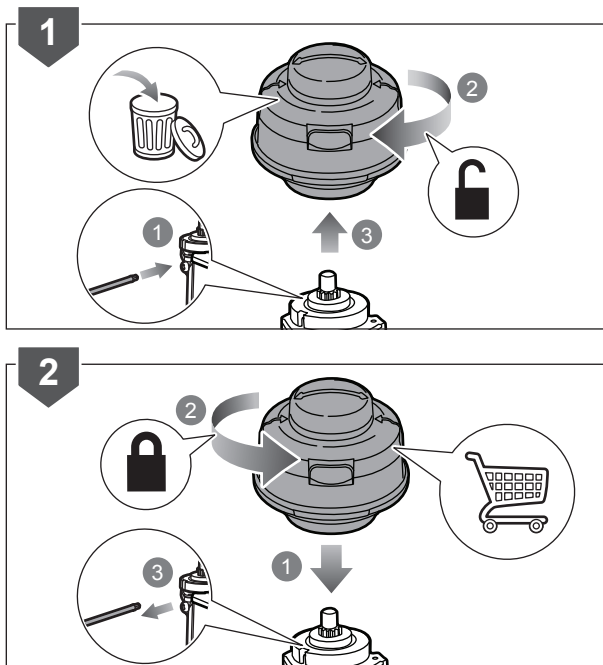

MAINTENANCE

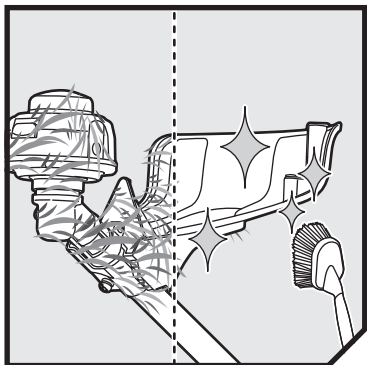

CLEANING THE PRODUCT

1. Clean all foreign material from the product.

WARNING: Keep away from corrosive agents such as garden chemicals and de-icing salts.

WARNING: The small blade fitted to the cutting attachment guard is designed to trim the new extended line to the correct length for safe and optimum performance. It is very sharp; do not touch it, particularly when cleaning the product.

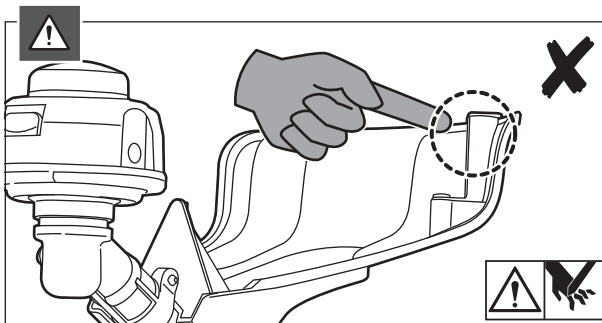
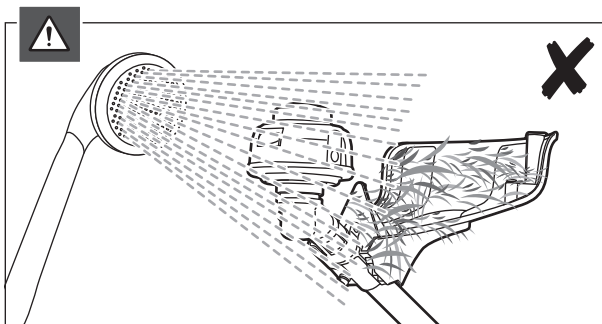
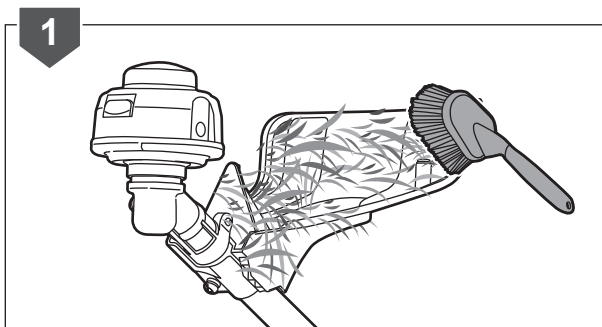

STORAGE

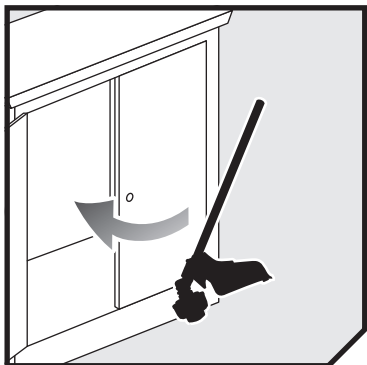

STORING THE PRODUCT

NOTE: Make sure to clean the product before storing.

1. Remove the attachment from the upper boom of the power head, and then attach the hanger cap.

NOTE: If a cutting blade is fitted, cover it with the blade protector.

2. Store the product.

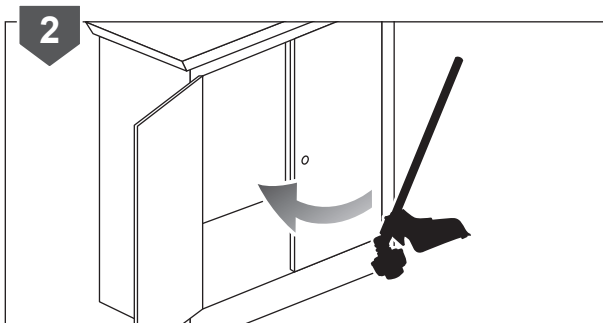
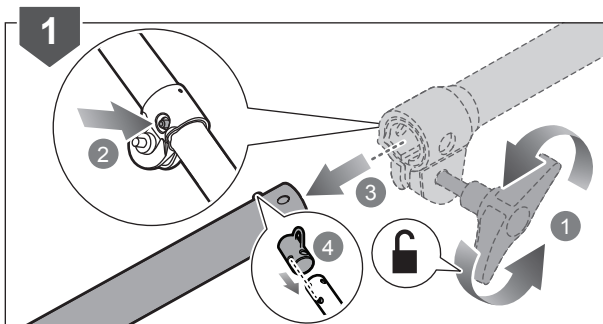
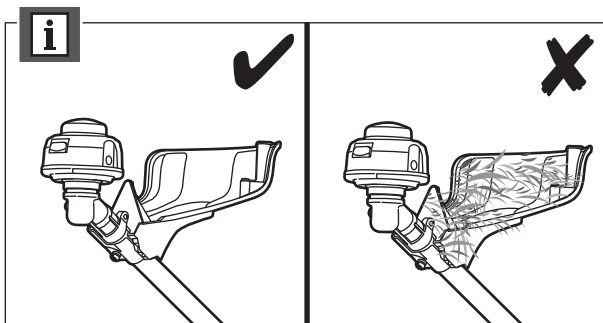

PRODUCT SPECIFICATIONS

Line trimmer attachment

Model	ALT05
Weight	1.45 kg
Cutting swath	457 mm
Cutting line diameter	2.4 mm

For assembling with petrol-driven power head (Below values measured on RLT254SDSO power head)

Weight (power head only)	4.25 kg
Fuel tank volume	580 cm ³
Engine displacement	25.4 cm ³ /cc
Maximum engine performance (in accordance with ISO 8893)	0.85 kW
Rated engine performance	0.8 kW

Maximum rotational frequency of the spindle	10,000 min ⁻¹
---	--------------------------

Engine speed (rotational frequency) at idle	2,600-3,400 min ⁻¹
---	-------------------------------

Fuel consumption (in accordance with ISO 8893) at max. engine performance	0.38 kg/h
---	-----------

Specific fuel consumption (in accordance with ISO 8893) at max. engine performance	0.45 kg/h
--	-----------

Vibration level (in accordance with ISO 22867)

Front handle	
- Idling	3.8 m/s ²
- Racing	13.8 m/s ²
- Equivalent	10.1 m/s ²

Rear handle	
- Idling	4.2 m/s ²
- Racing	7.1 m/s ²
- Equivalent	5.9 m/s ²

Uncertainty of vibration measurement	1.5 m/s ²
--------------------------------------	----------------------

Noise emission level (in accordance with ISO 22868)

A-weighted emission sound pressure level at the operator's position

- Idling	72.3 dB (A)
- Racing	98.4 dB(A)
- Equivalent A-weighted sound pressure level	95.4 dB (A)
Uncertainty	2.5 dB(A)
A-weighted sound power level	
- Idling	83.1 dB(A)
- Racing	111.8 dB(A)
- Equivalent A-weighted sound power level	111.8 dB(A)
Uncertainty	2.5 dB

REPLACEMENT PARTS

Parts	Accessory number	Part number
Speed winder bump feed head	RAC1214	000997065
Grass deflector	N/A	308743020
String line	N/A	528721000







*RYOBI is a trademark of Ryobi Limited, and
is used under license.*

Imported by:

Techtronic Industries (Australia) Pty. Ltd.
31 Gilby Road, Mount Waverley,
VIC, 3149, Australia

Techtronic Industries New Zealand Ltd.
Unit C, 70 Business Parade South,
Highbrook, Auckland 2013, New Zealand

961480051-01