

vision splashbacks

Distributed by: Stein International Limited

STEP BY STEP INSTALLATION GUIDE



- 1.** Place 10mm spacers on your stove surface to rest splashback whilst adhesive dries.

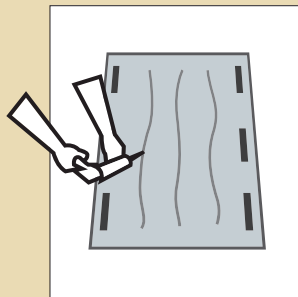

- 2.** Place recommended double sided mounting tape and recommended adhesive (see below) in long even strips to rear of splashback.



- 3.** Place splashback on spacers. Press splashback firmly onto wall and make final adjustment.



- 4.** Seal your splashback with silicon for an even finish.*

** Silicon can contain a chemical which can cause damage to the splashback paint. It is highly recommended that only a neutral cure silicon is used.*

SIZES AVAILABLE

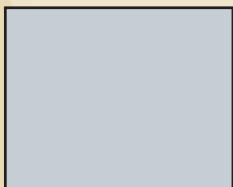

600 x 750mm

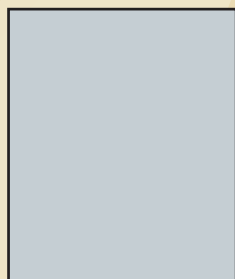

900 x 750mm

RECOMMENDED ADHESIVE

**Selleys Liquid Nails
Mirror - Metal - Glass**

RECOMMENDED TAPE

**3M Scotch
Indoor Mounting Tape**

Adhesive and Tape are Sold Separately.

Available at
BUNNINGS
warehouse

Stein Helpline: 0800 00 22 99

Disclaimer: Stein International is not liable for any Vision Mirrors that have not been installed correctly.