

BAILEY®

FALL PROTECTION

ROOF ANCHORS

Applications:

Bailey's range of temporary anchors offers a safe secure anchorage point to your fall protection system requirements.



TEMPORARY EDGE AND BAR TYPE ANCHORS:

Designed for use on a variety of metal roof applications. Invasive and Non-Invasive solutions for use with a Fall Arrest System.

HARDWARE - KARABINERS

Applications:

Karabiners are a metal looped shackle that have spring-loaded gate that is used to quickly and reversibly connect components and safety systems.



HARDWARE - KARABINER:

Two types are available - Steel Oval and Aluminium Bulb.

Being safe in your workzone...

Installation Instructions

THIS ANCHOR MUST BE INSTALLED BY A COMPETENT PERSON PRIOR TO THE OPERATOR ATTACHING TO IT.

Positioning of the anchor is crucial for safety. Height of the fall and rope stretch should be carefully considered. Users must be adequately trained and take care to adjust the safety line length to ensure that the user will not be able to fall off any edge of the roof. AS/NZS 1891.4 sets out the safe use of anchors, in particular, safe access and avoiding lateral swing. This anchor should never be installed on the ridge line or ridge capping of a roof.

Bar Type:

Follow all instructions carefully.

Fix the anchor plate to the centre line of the roof batten or purlin with a minimum of 3 screws, one of which must be directly inline with the anchor point (see position "2"), to achieve 15 kN.

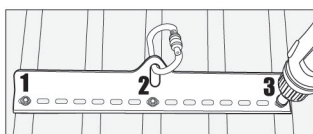

Edge Type:

Follow all instructions carefully.

1. Place anchor on top of sheet
2. Ensure bottom tab is under sheet
3. Ensure wing nut is tight
4. Ensure L-Bolt is tightened
5. Screw in Roof Screw through slotted section

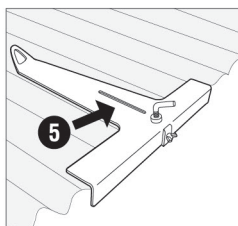

Correct Connections:

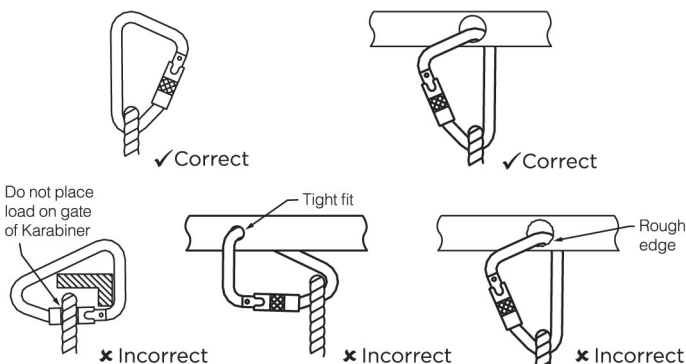

BAILEYFALLPROTECTION.COM



**SCAN
QR CODE
FOR MORE
INFORMATION**

