

RYOBI®

**RLT18X20M
OLT1825M**

ORIGINAL INSTRUCTIONS

Cordless Lawn Trimmer / Edge Trimmer



Important!

It is essential that you read the instructions in this manual before assembling, operating, and maintaining the product.

Subject to technical modifications.

Safety, performance, and dependability have been given top priority in the design of your cordless lawn trimmer or edge trimmer.

INTENDED USE

The cordless lawn trimmer or edge trimmer is intended to be used only by adults who have read and understood the instructions and warnings in this manual and can be considered responsible for their actions.

The product is intended only for outdoor use by a standing operator in a well-ventilated area. For safety reasons, the product must be adequately controlled by a two-handed operation.

When fitted with the lawn trimmer head (and appropriate guard), the product is intended for cutting long grass, pulpy weed, and similar vegetation at or about ground level.

The cutting plane should be approximately parallel to the ground surface when trimming and approximately vertical when edging.

The product should not be used to cut or trim hedges, bushes, or other vegetation where the cutting plane is not parallel to the ground surface.

Do not use the product for any other purpose.

GENERAL SAFETY WARNINGS

WARNING

Read all safety warnings and all instructions. Failure to follow the warnings and instructions may result in electric shock, fire, and/or serious injury.

WARNING

When using the product, the safety rules must be followed. For your own safety and that of bystanders, please read these instructions before operating the product. Please keep the instructions safe for later use.

WARNING

This product is not intended to be used by children or persons with reduced physical, mental, or sensory capabilities. Children should be adequately supervised to ensure that they do not play with the product.

WARNING

Some regions have regulations that restrict the use of the product. Check with your local authority for advice.

TRAINING

- Read the instructions carefully. Be familiar with all controls and the proper use of the product.
- Never allow children or people who are unfamiliar with these instructions to use the product. Local regulations may restrict the age of the operator.
- Keep bystanders, children, and pets 15 m away from the area of operation. Stop the product if anyone enters

the area.

- Never use the product while tired, ill, or under the influence of alcohol, drugs, or medication.
- Keep in mind that the operator or user is responsible for accidents or hazards occurring to other people or their property.

PREPARATION

- Wear full eye and hearing protection while operating the product. If working in an area where there is a risk of falling objects, head protection must be worn.
- Hearing protection may restrict the operator's ability to hear warning sounds. Pay particular attention to potential hazards around and inside the working area.
- Wear heavy, long trousers, boots, and gloves. Do not wear loose-fitting clothing, short trousers, or jewellery of any kind, and do not use the product with bare feet.
- Secure long hair so that it is above shoulder level to prevent entanglement in moving parts.
- Before use and after any impact, check that there are no damaged parts. A defective switch or any part that is damaged or worn should be properly repaired or replaced by an authorised service centre.
- Make sure that the cutting attachment is properly installed and securely fastened.
- Never operate the product unless all guards, deflectors, and handles are properly and securely attached.
- Consider the environment in which you are working. Keep the working area free from wires, sticks, stones, and debris, which if struck by the cutter can become thrown objects.

BATTERY TOOL USE AND CARE

- Recharge only with the charger specified by the manufacturer. A charger that is suitable for one type of battery pack may create a risk of fire when used with another battery pack.
- Use power tools only with specifically designated battery packs. The use of any other battery packs may create a risk of injury and fire.
- When battery pack is not in use, keep it away from other metal objects, like paper clips, coins, keys, nails, screws, or other small metal objects that can make a connection from one terminal to another. Shorting the battery terminals together may cause burns or a fire.
- Under abusive conditions, liquid may be ejected from the battery. Avoid contact. If contact accidentally occurs, flush with water. If liquid contacts eyes, additionally seek medical help. Liquid ejected from the battery may cause irritation or burns.

LAWN TRIMMER / EDGE TRIMMER SAFETY WARNINGS

- Never allow children, persons with reduced physical, sensory, or mental capabilities, or lack of experience and knowledge or people who are unfamiliar with these instructions to use the product.
- Use the product in daylight or with good artificial light.
- Avoid using the product on wet grass.

- Keep proper footing and balance at all times, and be sure of proper footing on slopes.
- Do not walk backwards when using the product. Walk, never run.
- Keep the head attachment below waist level.
- Never use the product with damaged guards or without guards in place.
- Never fit a metal replacement line.
- Keep hands and feet away from the cutting means at all times, especially when turning on the motor.
- Beware, the cutting means continue to rotate after the motor is turned off.
- Beware of objects thrown by the cutting means. Clear debris like small stones, gravel, and other foreign objects from the work area before starting operation. Wires or string may become entangled with the cutting means.
- To reduce the risk of injury associated with contacting moving parts, always turn off the product, remove the battery pack, and allow both to cool down. Make sure that all moving parts have come to a complete stop:
 - before servicing
 - before clearing a blockage
 - before checking, cleaning, and working on the product
 - before changing accessories
 - after striking a foreign object
 - whenever leaving the product unattended
 - whenever performing maintenance
 - whenever the product starts to vibrate abnormally
- Wear full eye and hearing protection while operating the product. If working in an area where there is a risk of falling objects, head protection must be worn.
- Hearing protection may restrict the operator's ability to hear warning sounds. Pay particular attention to potential hazards around and inside the working area.
- Wear heavy, long trousers, boots, and gloves. Do not wear loose-fitting clothing, short trousers, or jewellery of any kind, and do not use the product with bare feet.
- Secure long hair so that it is above shoulder level to prevent entanglement in moving parts.
- The small blade fitted to the lawn guard is designed to trim the new extended line to the correct length for safe and optimum performance. The blade is very sharp. Do not touch the blade, particularly when cleaning the product.
- Always ensure that ventilation openings are kept clear of debris.
- Before use and after any impact, check that there are no damaged parts on the product. A defective switch or any part that is damaged or worn should be properly repaired or replaced by an authorised service centre.
- Make sure that the cutting head attachment is properly installed and securely fastened.
- Make sure that all guards, deflectors, and handles are properly and securely attached.
- Do not modify the product in any way. This may increase the risk of injury to yourself or others.

- Use only the manufacturer's replacement cutting line. Do not use any other cutting attachment.
- Immediately turn off and remove the battery pack in the event of accident or breakdown. Do not operate the product again until it has been fully checked by an authorised service centre.

WARNING

Ensure that the line cut-off blade in the guard is properly positioned and secured before each use.

ADDITIONAL BATTERY SAFETY WARNINGS

WARNING

To reduce the risk of fire, personal injury, and product damage due to a short circuit, never immerse your tool, battery pack or charger in fluid or allow a fluid to flow inside them. Corrosive or conductive fluids, such as seawater, certain industrial chemicals, and bleach or bleach-containing products, etc., can cause a short circuit.

TRANSPORTATION AND STORAGE

- Turn off the product, remove the battery pack, and allow the product to cool down before storing or transporting.
- Clean all foreign material from the product.
- Do not store or transport the product with the battery pack fitted. Remove the battery pack and secure it separately. Store the product in a cool, dry, and well-ventilated place that is inaccessible to children. Keep the product away from corrosive agents, such as garden chemicals and de-icing salts. Do not store the product outdoors.
- For transportation in vehicles, secure the product against movement or falling to prevent injury to persons or damage to the product.

TRANSPORTING LITHIUM BATTERIES

Transport the battery pack in accordance with local and national provisions and regulations.

Follow all special requirements on packaging and labelling when transporting batteries by a third party. Ensure that no batteries can come in contact with other batteries or conductive materials while in transport by protecting exposed connectors with insulating, non-conductive caps or tape. Do not transport batteries that are cracked or leaking. Check with the forwarding company for further advice.

MAINTENANCE

WARNING

Use only original manufacturer's replacement parts, accessories, and attachments. Failure to do so can cause possible injury, can contribute to poor performance, and may void your warranty.

WARNING

Servicing requires extreme care and knowledge and should be performed only by a qualified service technician. Have the product serviced by an authorised service centre only. When servicing, use only original replacement parts.

- Turn off the product and remove the battery pack before conducting any maintenance or cleaning work.
- You may only make adjustments and repairs described in this manual. For other repairs, contact an authorised service centre.
- For the replacement line, use only a nylon filament line of the diameter described in the specifications table of this manual.
- After extending the new cutter line, always return the product to its normal operating position before starting.
- Clean all foreign material from the product with a soft, dry brush. Any part that is damaged should be properly repaired or replaced by an authorised service centre.
- Check all nuts, bolts, and screws before each use and at frequent intervals for proper tightness to ensure that the product is in safe working condition. Any part that is damaged should be properly repaired or replaced by an authorised service centre.
- Bring the product to an authorised service centre to replace damaged or unreadable labels.

RESIDUAL RISKS

Even when the product is used as prescribed, it is still impossible to completely eliminate certain residual risk factors. The following hazards may arise during use, and the operator should pay special attention to avoid the following:

- injury caused by vibration
 - Hold the product by the designated handles, and restrict working time and exposure.
- injury caused by exposure to noise
 - Wear hearing protection, and limit exposure.
- injury caused by flying debris
 - Wear eye protection at all times.

RISK REDUCTION

It has been reported that vibrations from handheld tools may contribute to a condition called Raynaud's Syndrome. Symptoms may include tingling, numbness, and blanching of the fingers, usually apparent upon exposure to cold. Hereditary factors, exposure to cold and dampness, diet, smoking, and work practices are all thought to contribute to the development of these symptoms. There are measures that can be taken by the operator to possibly reduce the effects of vibration:

- Keep your body warm in cold weather. When operating the product, wear gloves to keep the hands and wrists warm. It is reported that cold weather is a major factor contributing to Raynaud's Syndrome.

- After each period of operation, exercise to increase blood circulation.
- Take frequent work breaks. Limit the amount of exposure per day.

If you experience any of the symptoms of this condition, immediately discontinue use and see your physician.

WARNING

Injuries may be caused, or aggravated, by prolonged use of a tool. When using any tool for prolonged periods, ensure that you take regular breaks.

WHAT'S IN THE BOX

See page 5.

- Power head and upper boom assembly x 1
- Trimmer head assembly x 1
- Screw x 4
- Manual x 1

NOTE: The battery, charger, and phillips screwdriver are sold separately.

SYMBOLS ON THE PRODUCT



Read and understand all instructions before operating the product. Follow all warnings and safety instructions.



Beware of thrown or flying objects. Keep all bystanders, especially children and pets, at least 15 m away from the operating area.



Wear eye protection.



Wear ear protection.



Wear non-slip safety footwear when using the product.



Do not use metal blade(s) on the product.



Do not expose the product to rain or damp condition.



Keep hands away from blades.



Waste electrical products should not be disposed of with household waste. Please recycle where facilities exist. Check with your local authority or retailer for recycling advice.



Guaranteed sound power level



Regulatory Compliance Mark (RCM). Product meets applicable regulatory requirements.

The following signal words and meanings are intended to explain the levels of risk associated with this product:



DANGER

Indicates an imminently hazardous situation, which, if not avoided, will result in death or serious injury.



WARNING

Indicates a potentially hazardous situation, which, if not avoided, could result in death or serious injury.



CAUTION

Indicates a potentially hazardous situation, which, if not avoided, may result in minor or moderate injury.

CAUTION

(Without Safety Alert Symbol)
Indicates a situation that may result in property damage.

SYMBOLS IN THIS MANUAL



Parts or accessories sold separately



Note



Warning

WHAT'S IN THE BOX

OLT1825M

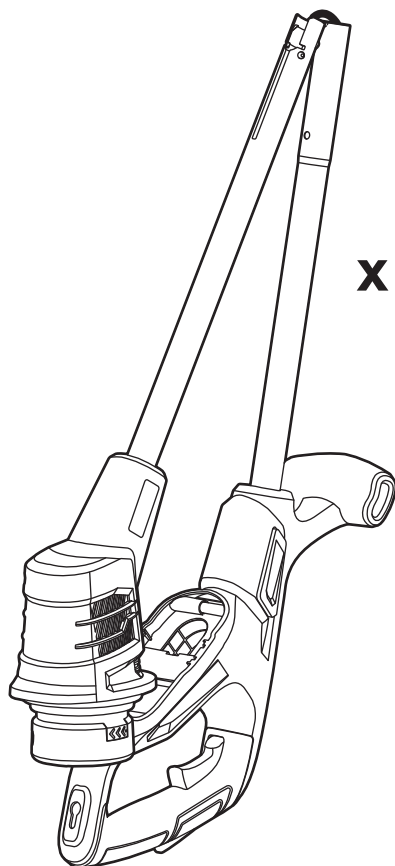

x 1



x 1

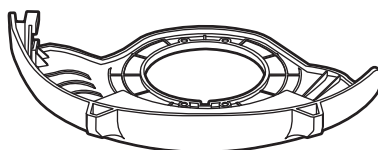

x 1



x 4

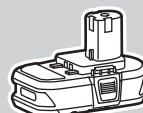
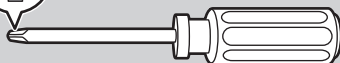

WHAT'S IN THE BOX

RLT18X20M

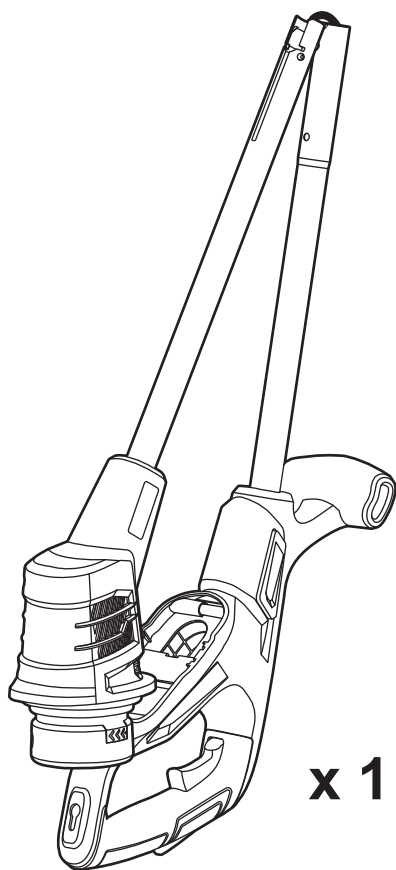

x 1



x 1



x 4

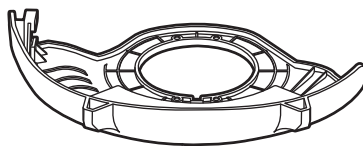

x 1

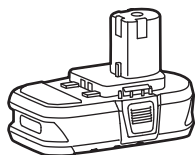

x 1



x 1

KNOW YOUR PRODUCT

1. Lock-out trigger
2. Rear handle
3. On/Off trigger
4. Edging button
5. Upper shaft
6. Spool cover
7. Spool

8. Eyelet
9. Slider
10. Safety guard
11. Cutting line
12. Cut-off blade
13. Lower shaft
14. Front handle

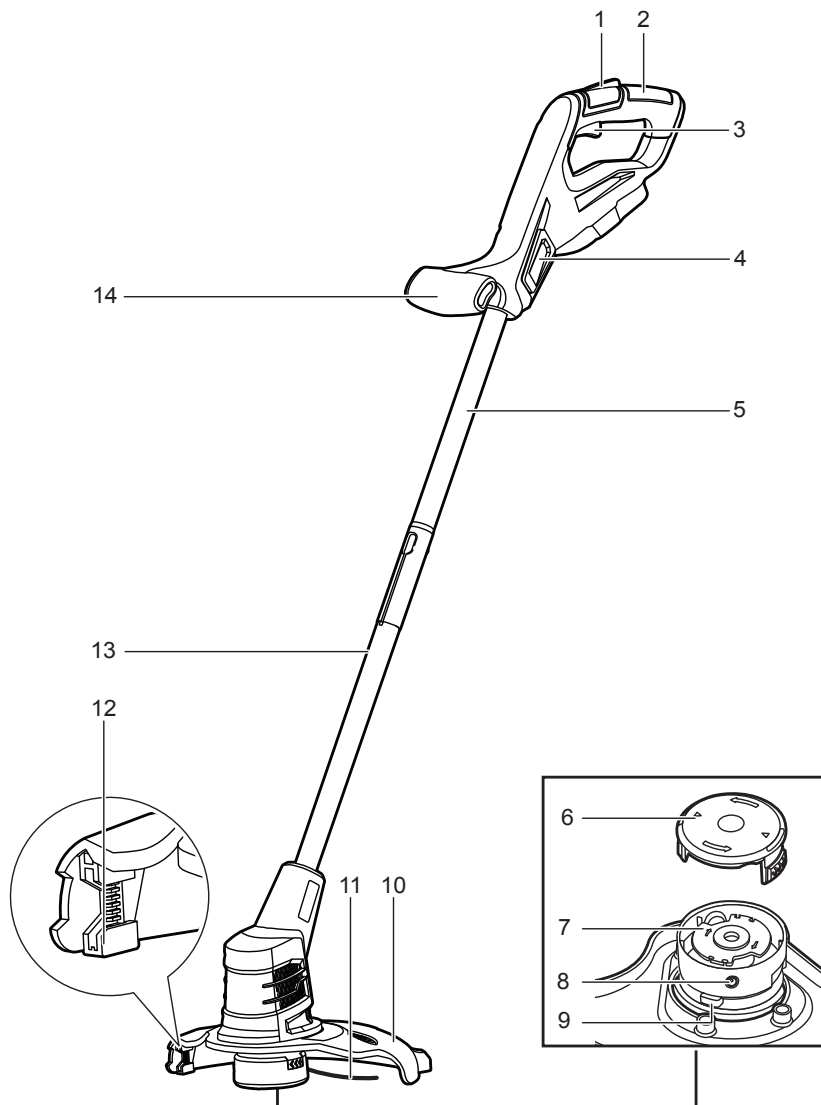

GETTING STARTED

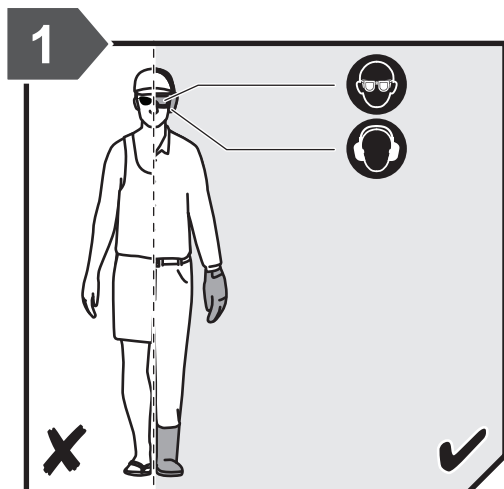

Always wear safety goggles or safety glasses with side shields when operating the product. Wear non-slip, heavy-duty protective gloves. Wear non-skid, protective footwear that will protect your feet and improve your footing on slippery surfaces.

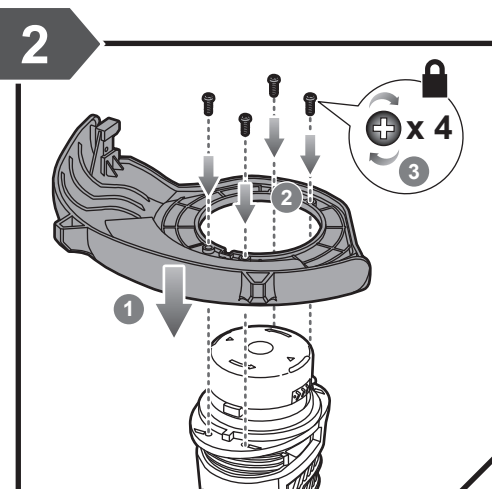

Install the safety guard to the trimmer head. Screw the safety guard into place with a phillips screwdriver.

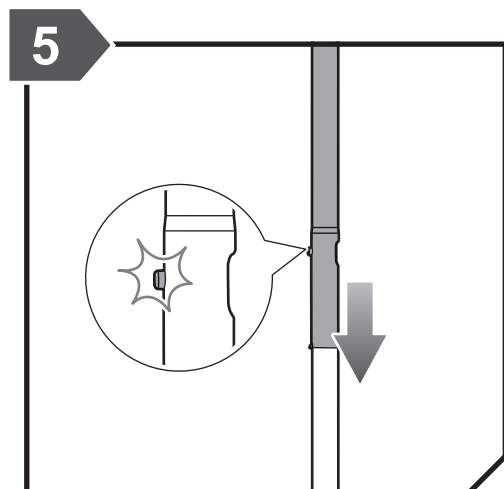

Push the upper shaft into the lower shaft until the lock button clicks into place.

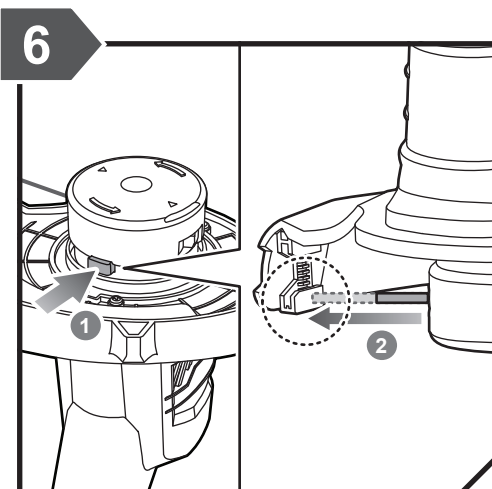

Push the slider. Pull the cutting line until it reaches the line cut-off blade.

GETTING STARTED

3

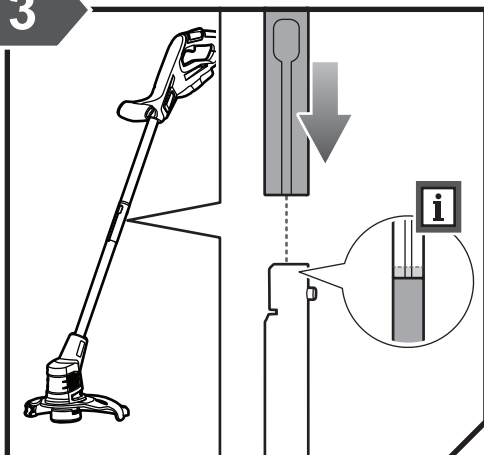

Attach the upper shaft to the lower shaft.

4

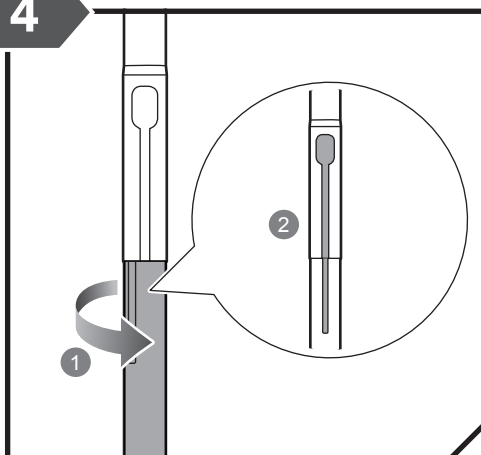

Rotate the lower shaft counterclockwise until the lines on both the lower shaft and upper shaft are aligned.

7

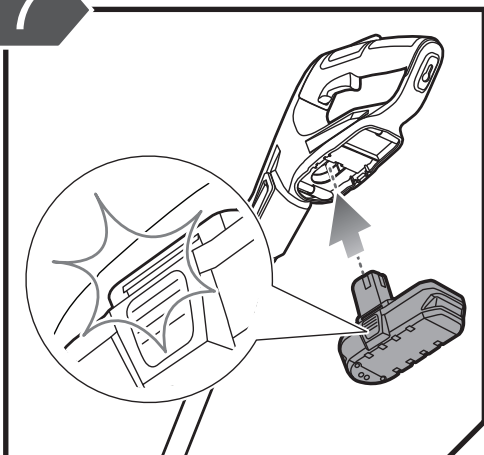

Insert the battery pack until the battery latch button clicks into place.

8

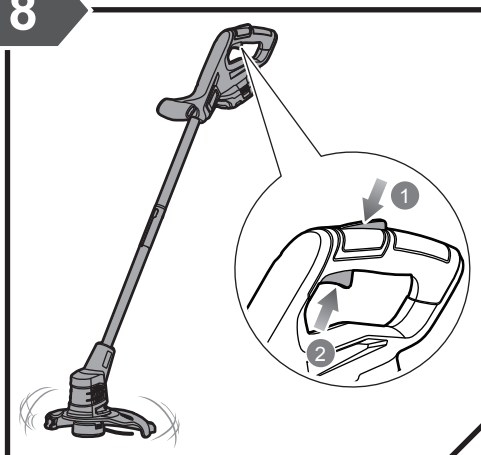

Hold the lock-out trigger, and squeeze the on/off trigger to operate the product.

OVERVIEW

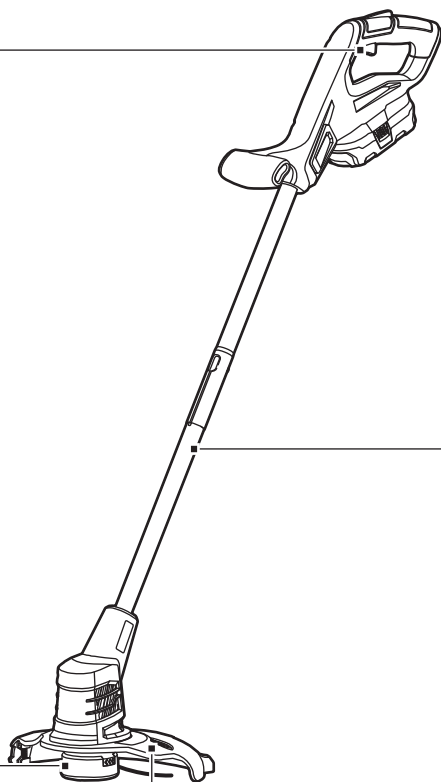
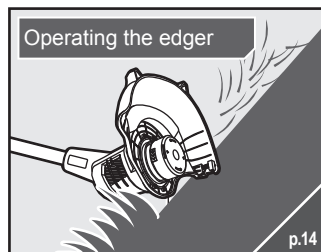
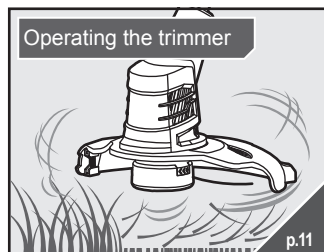

OPERATION

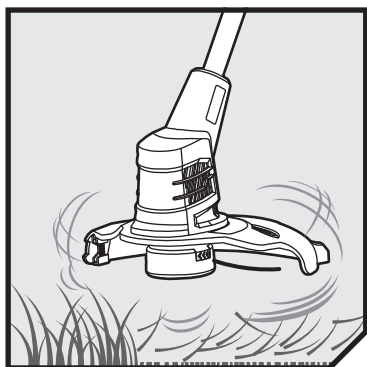

OPERATING THE TRIMMER

WARNING: Always use two hands to operate the product. Hold the product with the right hand on the rear handle and the left hand on the front handle.

WARNING: Beware of objects thrown by the cutting means. Clear debris like small stones, gravel, and other foreign objects from the work area before starting operation. Wires or string may become entangled with the cutting means.

WARNING: Exercise extreme caution when using the product. Keep hands and feet away from the cutting means.

1. Insert the battery pack until the battery latch button clicks into place.

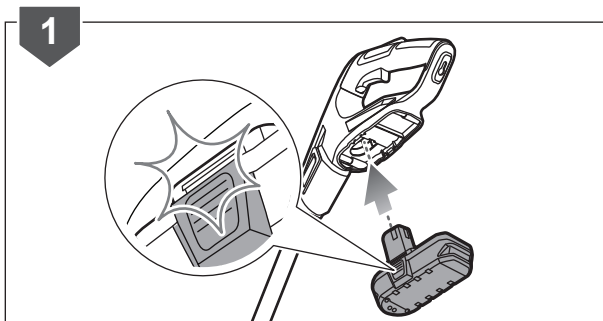
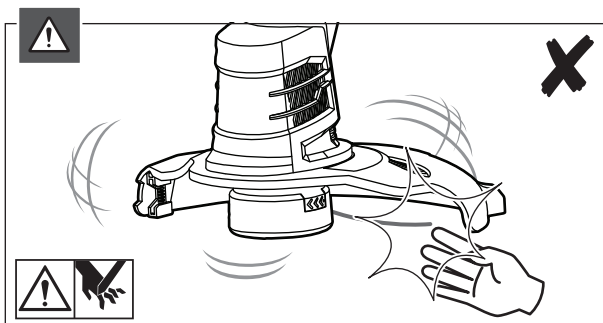
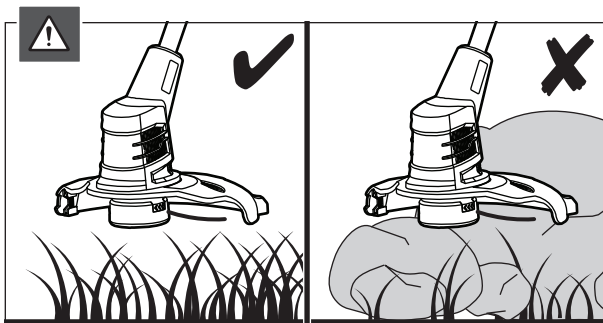
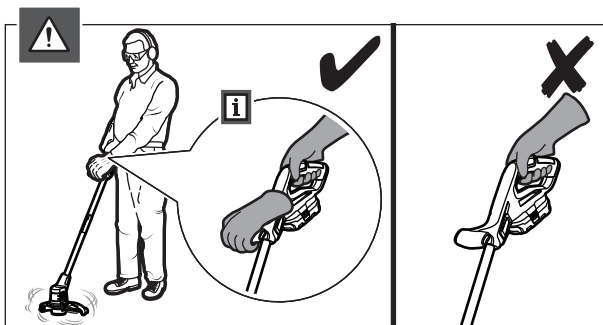

OPERATION

2. Hold the lock-out trigger, and squeeze the on/off trigger to operate the product.

NOTE: Holding and releasing both the lock-out trigger and the on/off trigger automatically releases a quarter inch of line.

WARNING: Do not bump the spool head on the ground when operating the product. Bumping the spool head causes damage to the product and may void your warranty.

NOTE: The line cut-off blade fitted to the cutting attachment guard is designed to trim the new extended line.

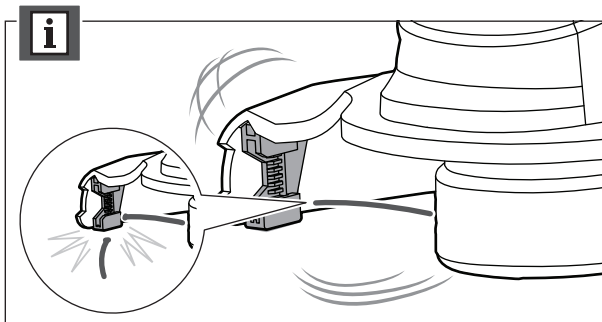
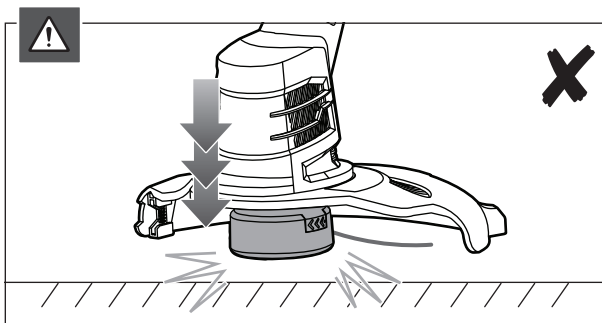
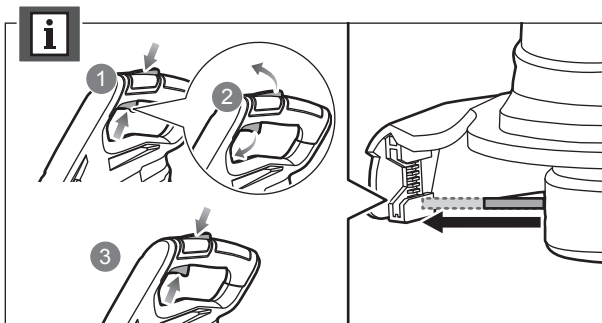
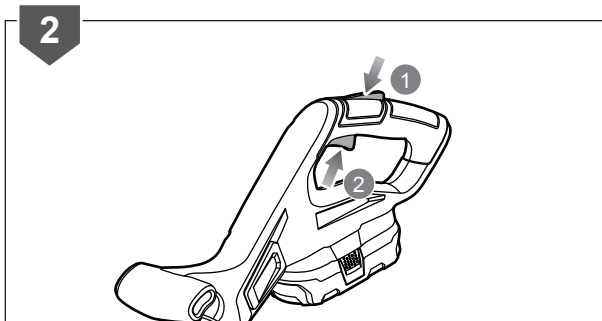

OPERATION

NOTE: The line cut-off blade on the grass deflector cuts the line to the correct length for safe and optimum performance.

NOTE: Cut tall grass from the top down. This prevents grass from wrapping around the shaft housing and bump head, which may cause damage from overheating.

NOTE: Cut grass from the right side to the left side for cutting ease and safety.

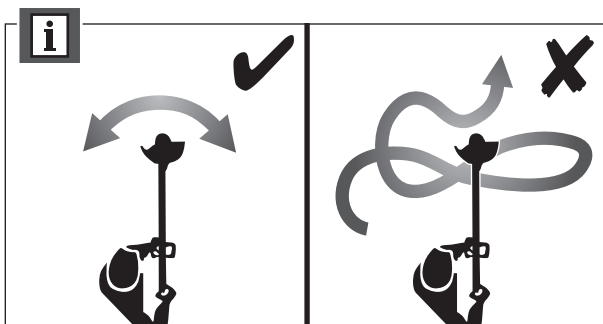
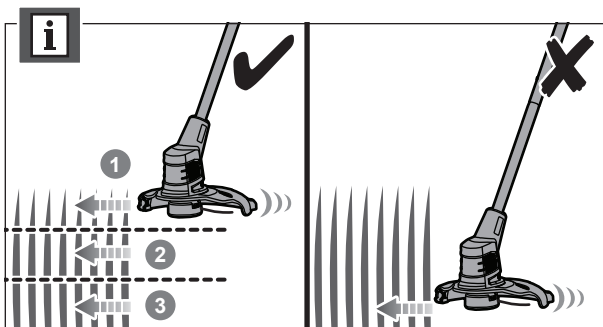
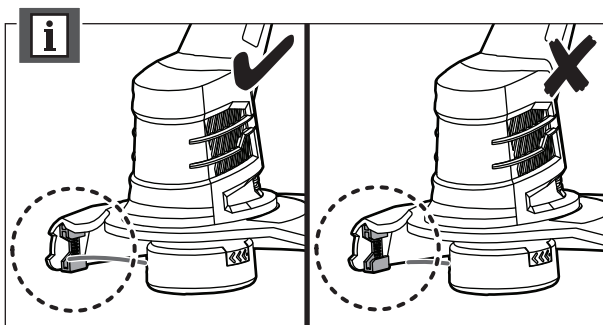

OPERATION

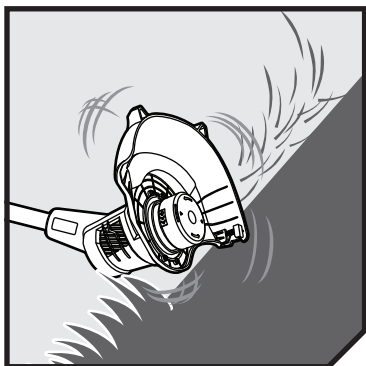

OPERATING THE EDGER

1. Remove the battery pack.
2. Push the edging button. Rotate the upper shaft counterclockwise to turn to the edger position.
3. Insert the battery pack until the battery latch button clicks into place. Hold the lock-out trigger, and squeeze the on/off trigger to operate the product.
4. Use the edger along sidewalks, driveways, flower beds, curbs, and similar areas.

NOTE: Cut at a steady pace. If the blade begins to bog down, you are edging too fast. Slow your pace. Do not force the blade into the ground.

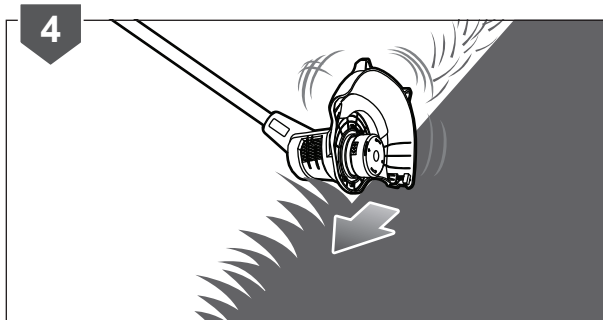
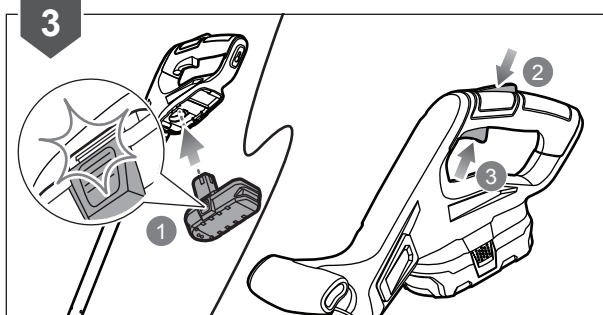
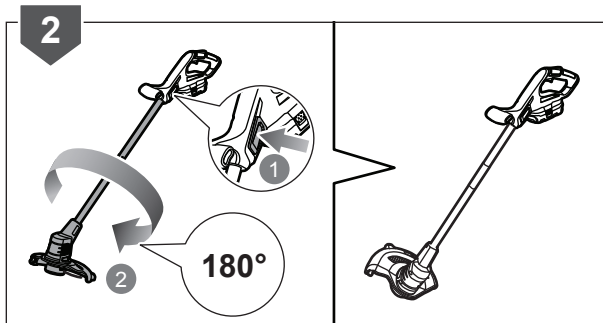
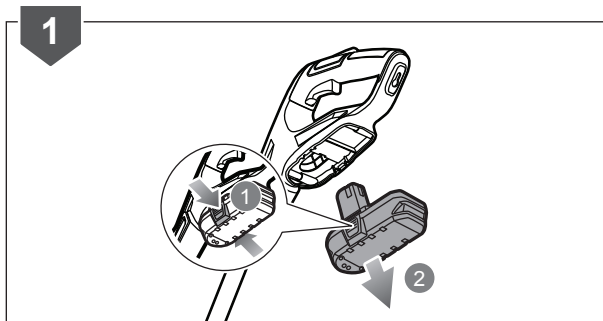

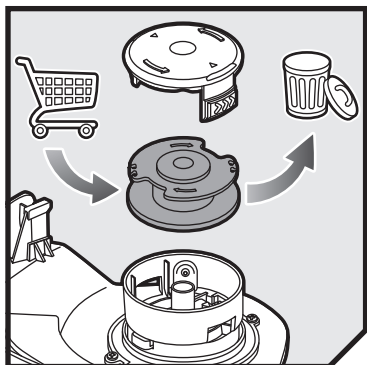

REPLACING THE SPOOL

1. Remove the battery pack. Push the slider on the side of the spool retainer, and remove the spool cover.
2. Remove the spool.
3. Thread the line of the new spool through the eyelet. Install the new spool with the line and slot aligned with the eyelet in the string head.
4. Install the spool cover until the spool cover latch clicks into place.

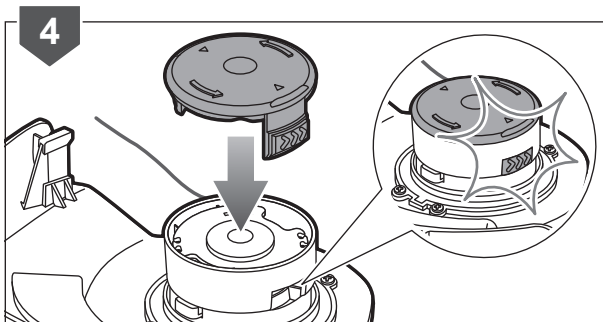
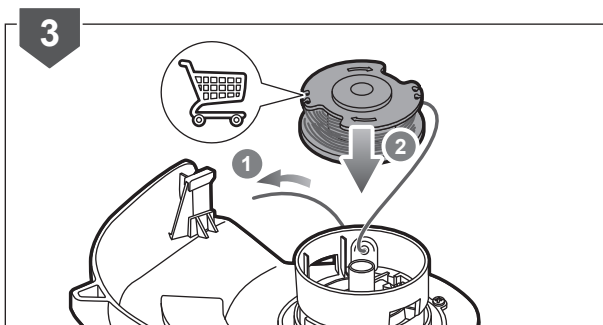
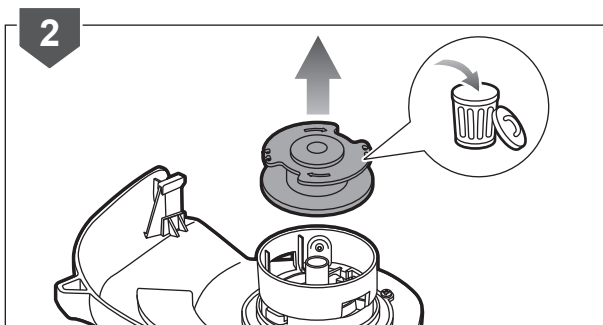
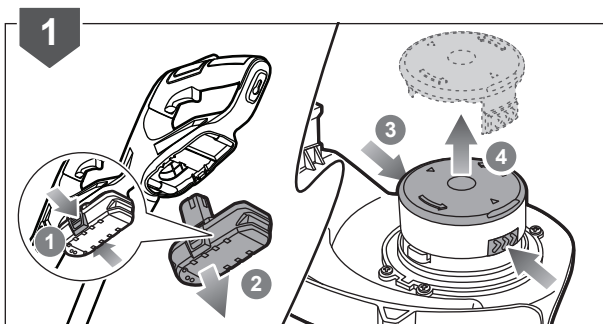

MAINTENANCE

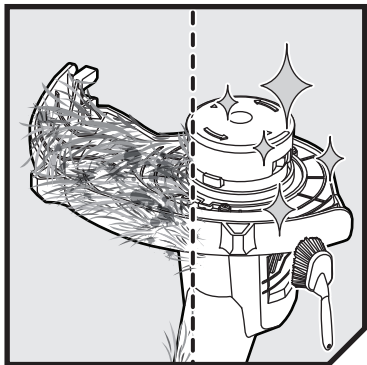

CLEANING THE PRODUCT

1. Remove the battery pack.
2. Clean all foreign material from the product with a soft, dry brush.

WARNING: Avoid using solvents when cleaning plastic parts. Most plastics are susceptible to damage from various types of commercial solvents and may be damaged by their use.

WARNING: The line cut-off blade that is fitted to the cutting attachment guard is very sharp. Keep hands away from the line cut-off blade at all times.

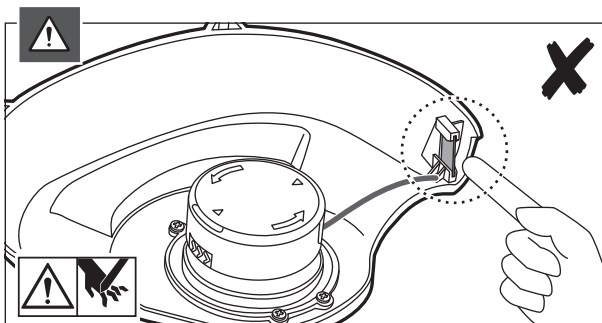
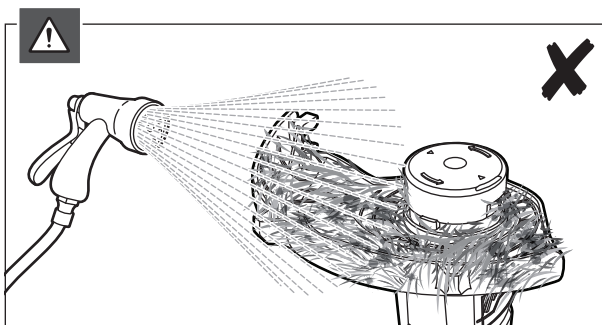
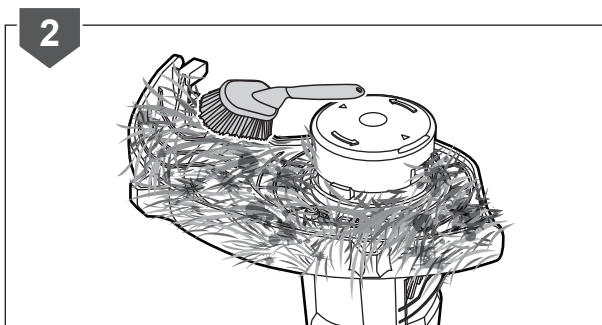
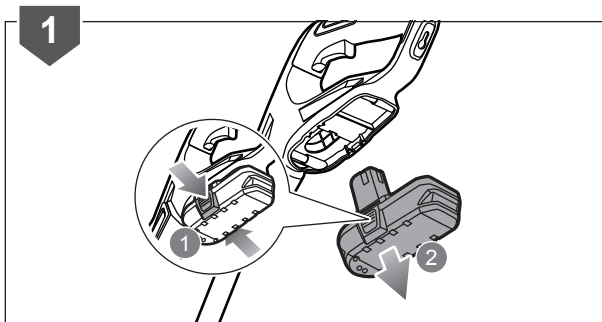

STORAGE

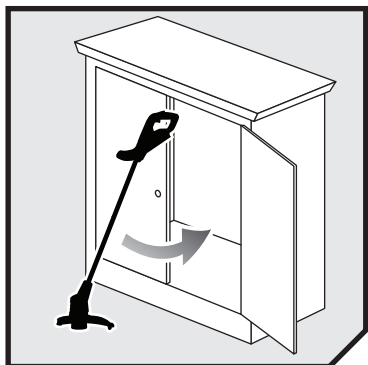

STORING THE PRODUCT

NOTE: Ensure that the product is clean before storing.

1. Remove the battery pack.
2. Store the product in a cool, dry, and well-ventilated place that is inaccessible to children and away from sources of ignition. Do not store the product outdoors.

NOTE: Store the product vertically.

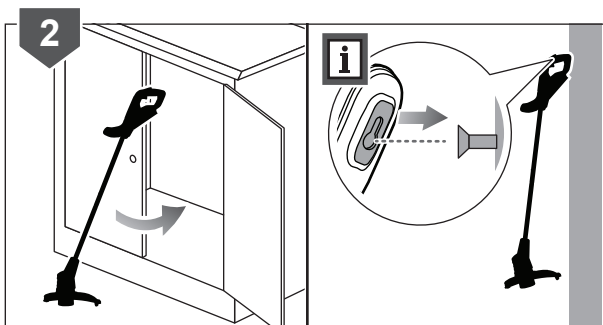
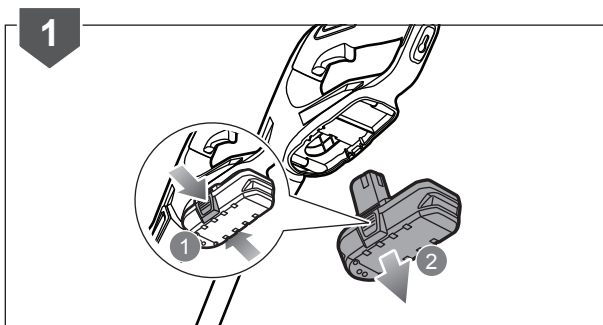
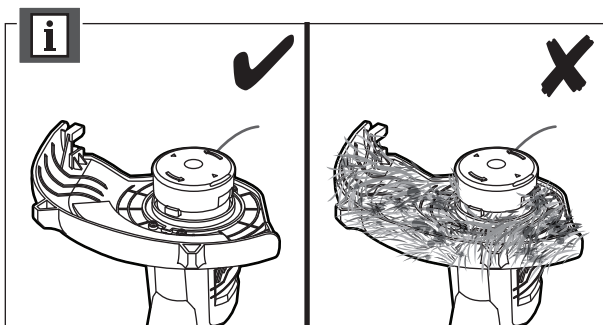

PRODUCT SPECIFICATIONS

Cordless Lawn Trimmer / Edge Trimmer

Model RLT18X20M / OLT1825M

Voltage 18 V

No-load speed 9,500 min⁻¹

Cutting line diameter 1.6 mm

Cutting capacity 25 cm

Vibration level (in accordance with EN 50636-2-91 Annex BB)

Rear handle 3.1 / 5.1 m/s²

Front handle 5.5 / 6.8 m/s²

Uncertainty of measurement 1.5 m/s²

Noise emission level (in accordance with EN 50636-2-91 Annex CC)

A-weighted sound pressure level at the operator's position 82.0 dB(A)

Uncertainty of measurement 3.0 dB

A-weighted sound power level 94.5 dB(A)

Uncertainty of measurement 1.1 dB

Weight without battery pack 1.3 kg

Maximum weight with heaviest pack and accessory 2.482 kg

BATTERY AND CHARGER

Model RLT18X20M OLT1825M

Battery pack RB18L20 -

Weight -

Charger RC18115 -

Compatible battery packs RB18L13, RB18L15, RB18L20, RB18L25, RB18L26, RB18L20A, RB18L40, RB18L40A, RB18L50, RB18L60A, RB18L90A, RB18L15A, RB18L15B, RB18L25A, RB18L50A, RB18L60, RB18L90

Compatible chargers BCL-1800, RC18120, RC18627U, BCL1418IV, RC18115, RC18150, BCL14181H, BCL14183H

REPLACEMENT PART

1.6 mm cutting line PWFTL1650T

Complete spool (3 pcs) RAC1211

Plastic flailing blade RAC1103

VIBRATION LEVEL

WARNING

The declared vibration value has been measured with a standard test method and may be used to compare one tool with another.

The declared vibration value may be used in a preliminary assessment of exposure.

The vibration emission during actual use of power tool can differ from the declared total value depending on the ways in which the tool is used.

Identify safety measures to protect yourself based on an estimation of exposure in the actual conditions of use, taking account of all parts of the operating cycle such as the times when the tool is switched off and when it is running idle in addition to the trigger time.







*RYOBI is a trademark of Ryobi Limited,
and is used under license.*
© 2019–20 Techtronic Cordless GP.

Imported by:

Techtronic Industries Australia Pty Ltd
31 Gilby Road, Mount Waverley, VIC 3149,
Melbourne, Australia

Techtronic Industries N.Z. Limited
Unit C, 70 Business Parade South,
Highbrook, Auckland 2013, New Zealand

961068226-01