

OPERATION MANUAL

CAUTION: TAKE SAFETY PRECAUTIONS WHEN USING YOUR TOOLBOX

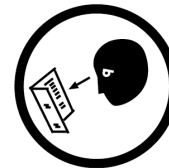
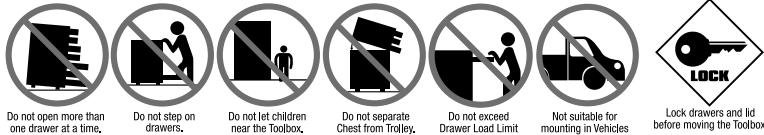

IMPORTANT:

THIS OPERATING MANUAL CONTAINS IMPORTANT SAFETY INFORMATION. READ CAREFULLY AND UNDERSTAND ALL INFORMATION BEFORE OPERATING TOOL CHEST. SAVE THIS MANUAL FOR FUTURE USE.

PARTS LIST



TOOL CHEST SPECIFICATIONS

	Width	Depth	Height
Overall	655mm	305mm	363mm
Top Tray	650mm	295mm	49mm
Small Drawers	565mm	268mm	40mm
Deep Drawers	565mm	268mm	52mm
Weight	17.3kg		



5 x EVA Liners



Keys x 2

MAINTENANCE

- Periodically tighten all hardware
- Lubricate the slides twice a year
- Lubricate the lock with graphite annually
- Use a damp Microfibre cloth to clean all surfaces

MAINTENANCE

1 Removing the Drawers

- Fully extend the empty drawer.
- Push up the right grey release lever while pushing down the left grey release lever.
- Pull the drawer outward until it is released from the drawer slide.

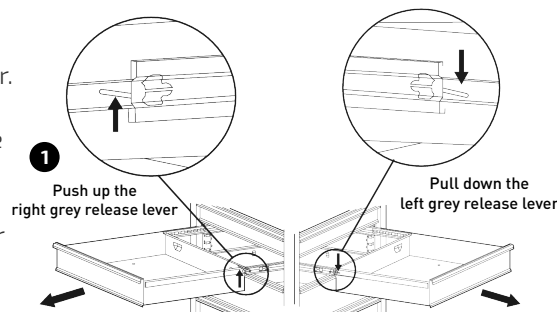

2 Re-Inserting The Drawers

- Extend the drawer slides.
- Insert the brackets on each side of the drawer into the slots on the slides, being careful that they are properly positioned.
- Once properly inserted, completely close the drawer to set the slides in their proper positions.

TOOLS & ASSISTANCE NEEDED



2 People Lift

REPLACEMENT PARTS



ITEM	PART NO.	DESCRIPTION	QUANTITY
1	STP7779	Key Only (Specify Key Number) X 1	1
2	STP7777	Lock & Key	1
3	STP7526-3	Gas Struts	2
4	STP7524-3	Ball Bearing Slide (Pair)	4
5	STP7536-8	Side Carry Handle	2
6	STP7524-4	EVA Mat Pack 5 Piece	1